



Bradman Way, Stevenage, SG1 5RE

Geoffrey Matthew Property Management are pleased to offer this well maintained Ground Floor Studio Apartment, situated within The Pin Green Area of Stevenage. The apartment benefits from close proximity to a wide range of local amenities, Bus routes to the Town Centre. Internally the property comprises of Open Plan lounge/Bedroom Area, fitted kitchen and bathroom.

The property has just undergone re-decoration and new carpeting.

Holding Deposit payable equivalent to one weeks rent.

£895 Per Calendar Month

Bradman Way, Stevenage, SG1 5RE

 1

 1

 null

 C

- Ground Floor Studio Apartment
 - Off street Parking
 - Close To Local Bus Routes
- Open Plan Lounge/Bedroom
 - Council Tax Band B
- Fitted Kitchen with Appliances
 - Available Now

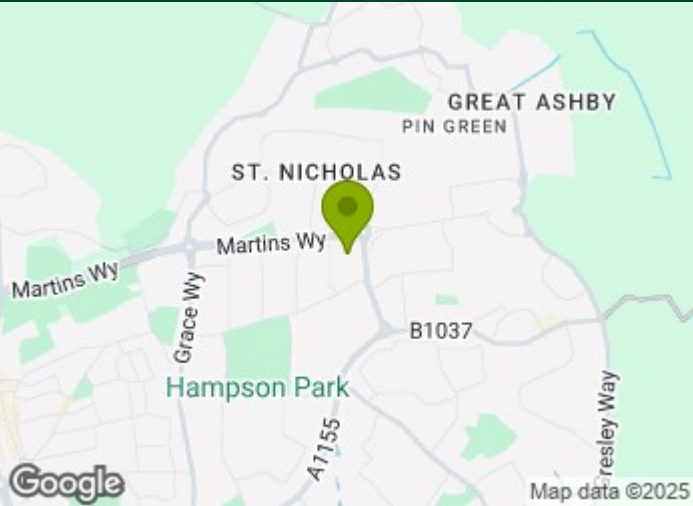

[Directions](#)



Floor Plan

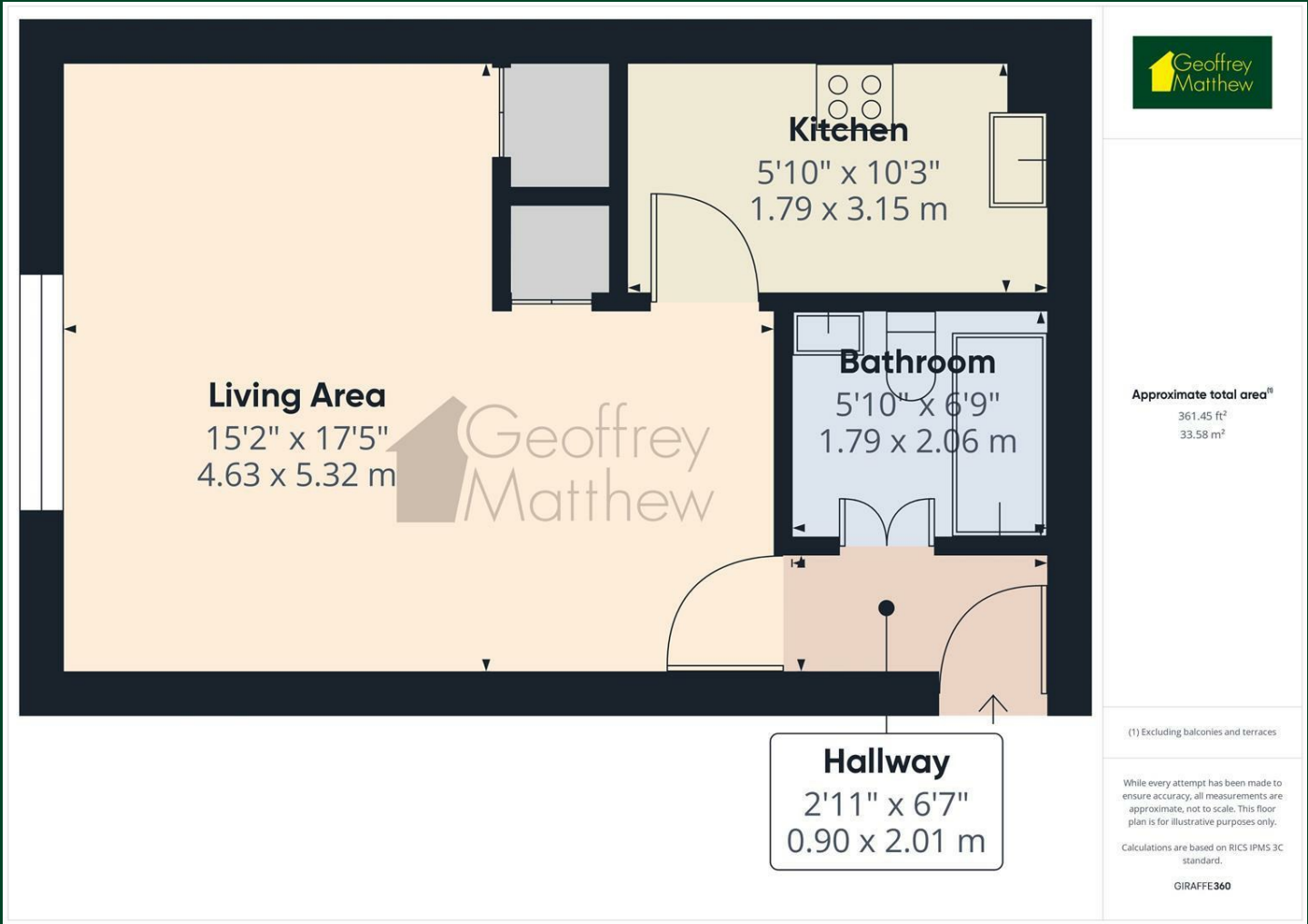

Council Tax Details

Stevenage Borough Council Band B

These particulars, whilst believed to be accurate are set out as a general outline only for guidance and do not constitute any part of an offer or contract. Intending purchasers should not rely on them as statements of representation of fact, but must satisfy themselves by inspection or otherwise as to their accuracy. No person in this firms employment has the authority to make or give any representation or warranty in respect of the property.

