

20 Uplands, Chells Manor, Stevenage, Herts, SG2 7DN

Geoffrey Matthew are delighted to offer for Let this spacious One Bedroom cluster home, set within a sought-after cul-de-sac location of Chells Manor. Internally the property offers an entrance hallway with AMPLE STORAGE space, modern downstairs bathroom & Double bedroom. Upstairs you will find an open plan lounge & kitchen area. Outside you have one Allocated Parking space with communal garden. AVAILABLE Mid September.

A holding deposit equivalent to one weeks rent is payable to apply for this property.

- One Bedroom Home
- New Refurbished & Fully Redecorated
- Available Mid September
- Chells Manor Location
- Downstairs Bathroom
- Double Bedroom
- Open Plan Lounge/Kitchen
- Allocated Parking Space
- Communal Garden

£1,200 Per Calendar Month

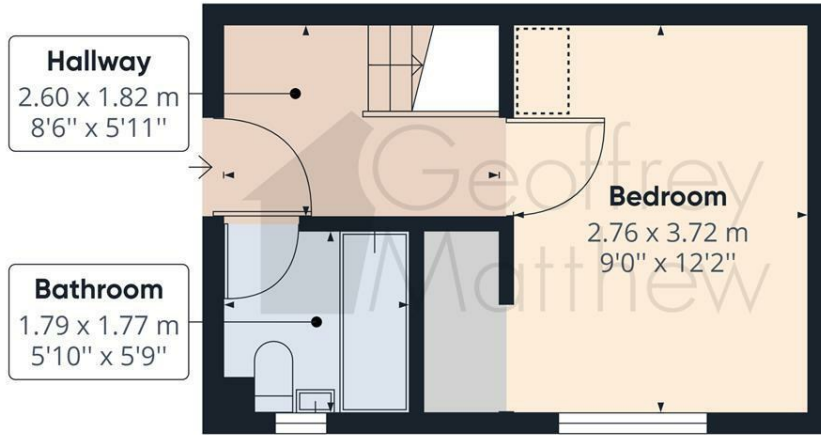

Floor 0 Building 1



Floor 1 Building 1

Approximate total area⁽¹⁾

410.93 ft²
38.18 m²

Reduced headroom

19.02 ft²
1.77 m²

(1) Excluding balconies and terraces

Reduced headroom
(below 1.5m/4.92ft)

While every attempt has been made to ensure accuracy, all measurements are approximate, not to scale. This floor plan is for illustrative purposes only.

GIRAFFE360

