



Flat 1909 Pan Peninsula Square

, London, E14 9HP

£365,000



1



1



1



B



City Realtor are proud to present this 19th floor luxury Studio in the heart of the financial district, Canary Wharf. This studio is situated in the Pan Peninsula development and has amenities that include a health club, restaurant, and a 24-hour concierge. The property consists of a wall mounted bed, modern shower room and a private balcony with scenic views of Canary Wharf.

This compact studio is ideal for professionals as it is well connected with many transportation links including access to the Elizabeth Line, Jubilee line and many DLR stations, all within walking distance. This allows for easy travel to the City as well as to airports such as City Airport and Heathrow Airport.

- Tenure - Leasehold
- Service Charge - £3500 per annum
- Ground Rent - £400 per annum
- Lease years remaining - 985 years
- Council Tax Band - E

Area Map



Floor Plans

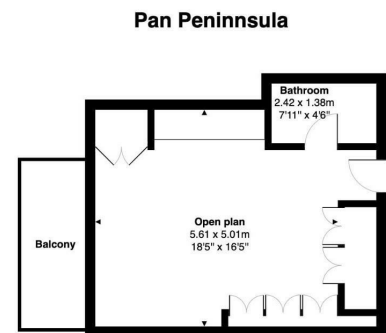

19th Floor

Total Area: 34.0 m² ... 366 ft² (excluding balcony)
 All measurements are approximate and for display purposes only

Energy Efficiency Graph

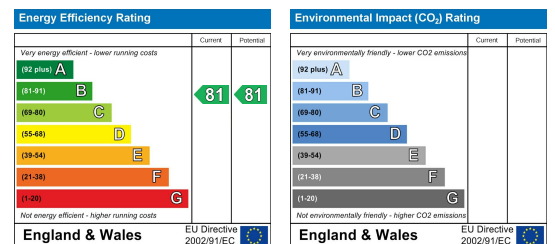

These particulars, whilst believed to be accurate are set out as a general outline only for guidance and do not constitute any part of an offer or contract. Intending purchasers should not rely on them as statements of representation of fact, but must satisfy themselves by inspection or otherwise as to their accuracy. No person in this firm's employment has the authority to make or give any representation or warranty in respect of the property.