



12 SMEATON ROAD LONDON, SW18 5JH

£528,500
SHARE OF FREEHOLD

Nestled on Smeaton Road in the vibrant area of Southfields, SW18, this superb two-bedroom ground floor flat offers a delightful blend of comfort and convenience. Spanning a well-designed layout, the property features a welcoming open plan kitchen dining room / reception room, complete with a charming breakfast bar, perfect for casual dining or entertaining guests.

The flat has two spacious bedrooms, providing ample room for relaxation and personal space. The well-appointed bathroom ensures that all your needs are met. One of the standout features of this property is the shared rear garden and further benefits from a private courtyard garden which includes a handy storage shed, ideal for those who enjoy outdoor activities or require additional storage.

For those who value accessibility, this flat is ideally situated just 0.4 miles from Southfields tube station, offering excellent travel links to central London. Additionally, the property boasts easy access



ELIZABETH WIGHTWICK
YOUR BESPOKE PROPERTY AGENT

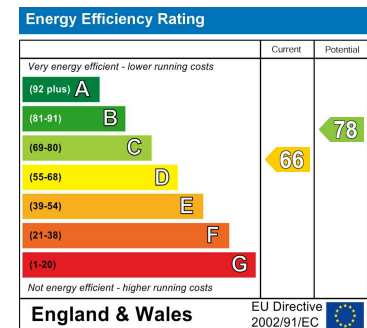
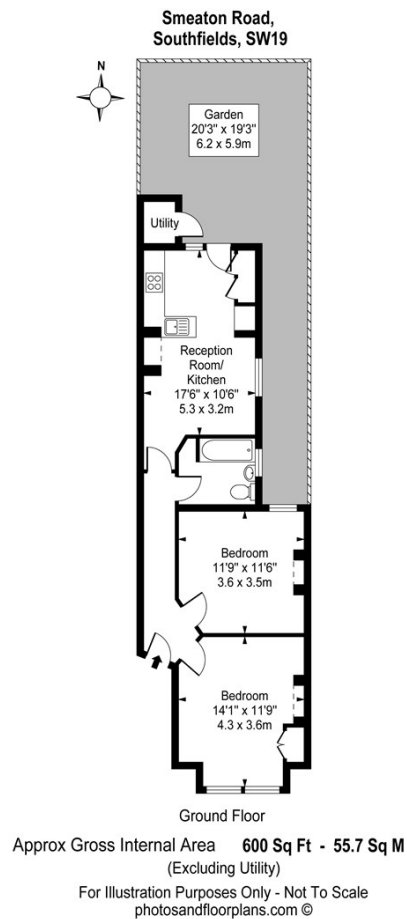

Agents Note: Whilst every care has been taken to prepare these particulars, they are for guidance purposes only. All measurements are approximate and are for general guidance purposes only and whilst every care has been taken to ensure their accuracy, they should not be relied upon and potential buyers/tenants are advised to recheck the measurements

Wimbledon Village
Unit 6 (2nd Floor)
2 Allington Close
Wimbledon Village
Wimbledon
London
KT3 3DN

020 3597 3484
info@elizabeth-wightwick.co.uk

