



2 DEVONSHIRE HOUSE POPLAR GROVE NEW MALDEN, KT3 3DB

£485,000
LEASEHOLD

Nestled in the desirable area of Poplar Grove, New Malden, this charming first-floor apartment offers a delightful living experience. Spanning an impressive 700 square feet, the property features two well-proportioned bedrooms, making it an ideal choice for couples, small families, or those seeking a comfortable space to call home.

The apartment boasts a contemporary kitchen and bathroom, designed with modern living in mind. The sleek finishes and thoughtful layout create an inviting atmosphere, perfect for both relaxation and entertaining. Natural light floods the living spaces, enhancing the overall appeal of this lovely home.

One of the standout features of this property is the garden, providing a serene outdoor space for residents to enjoy. Whether you wish to cultivate your green thumb or simply unwind in the fresh air, this garden is a wonderful addition to the apartment.



Devonshire House,
Poplar Grove,
New Malden Surrey, KT3

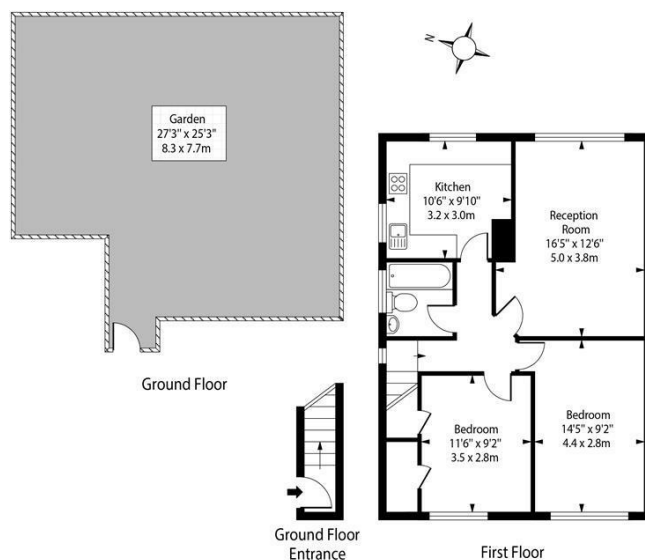

Approx Gross Internal Area 700 Sq Ft - 65.0 Sq M
For Illustration Purposes Only - Not To Scale
photosandfloorplans.com ©

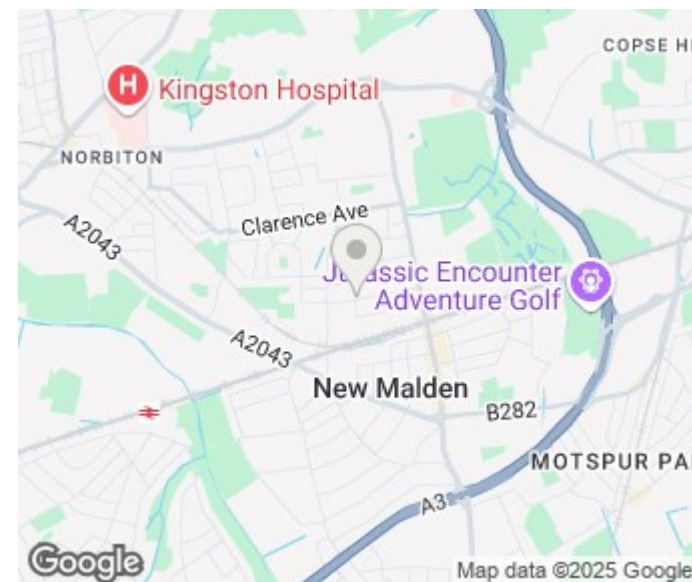

Energy Efficiency Rating		
	Current	Potential
Very energy efficient - lower running costs		
(92 plus) A		
(81-91) B		
(69-80) C	70	78
(55-68) D		
(39-54) E		
(21-38) F		
(1-20) G		
Not energy efficient - higher running costs		
England & Wales	EU Directive 2002/91/EC	

Agents Note: Whilst every care has been taken to prepare these particulars, they are for guidance purposes only. All measurements are approximate and are for general guidance purposes only and whilst every care has been taken to ensure their accuracy, they should not be relied upon and potential buyers/tenants are advised to recheck the measurements

Wimbledon Village
Unit 6 (2nd Floor)
2 Allington Close
Wimbledon Village
Wimbledon
London
KT3 3DN

020 3597 3484
info@elizabeth-wightwick.co.uk

