



FLAT 33, ANDERSON HOUSE FOUNTAIN ROAD LONDON, SW17 0HL

£2,500 PER MONTH

Welcome to Fountain Road, London - a prestigious location that could be the setting for your new home! This charming 3-bedroom apartment, situated on the first floor of a mansion block, offering a perfect blend of classic elegance and modern convenience.

As you step inside, you are greeted by a spacious reception room that is perfect for entertaining guests or simply relaxing after a long day. The contemporary kitchen is a chef's dream, offering ample space to whip up delicious meals for your loved ones.

With three bedrooms, there is plenty of space for a growing family or for those who enjoy having a home office or guest room. The property also features a well-maintained bathroom for your convenience, as well as a separate cloakroom.



Anderson House,
Fountain Road,
Tooting, SW17 0HL

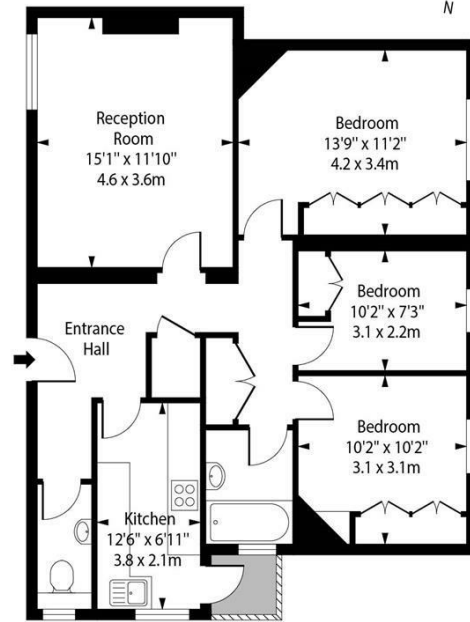

First Floor

Approx Gross Internal Area 835 Sq Ft - 77.6 Sq M

For Illustration Purposes Only - Not To Scale
photosandfloorplans.com ©



Energy Efficiency Rating		Current	Potential
Very energy efficient - lower running costs			
(92 plus) A			
(81-91) B			
(69-80) C		71	
(55-68) D			
(39-54) E			
(21-38) F			
(1-20) G			
Not energy efficient - higher running costs			
England & Wales		EU Directive 2002/91/EC	

Agents Note: Whilst every care has been taken to prepare these particulars, they are for guidance purposes only. All measurements are approximate and are for general guidance purposes only and whilst every care has been taken to ensure their accuracy, they should not be relied upon and potential buyers/tenants are advised to recheck the measurements

Wimbledon Village
Unit 6 (2nd Floor)
2 Allington Close
Wimbledon Village
Wimbledon
London
KT3 3DN

020 3597 3484
info@elizabeth-wightwick.co.uk

