



POPLAR GROVE

KT3 3DB

£1,875 PCM

Presenting this lovely, refurbished maisonette in the sought after 'Groves' area of New Malden. The property is situated on the first floor and comprises two double bedrooms, one bathroom, kitchen and living room as well as a private garden. The property is 0.5 miles (6 minute walk) to New Malden station (zone 4). Available 9th November 2024, Unfurnished.



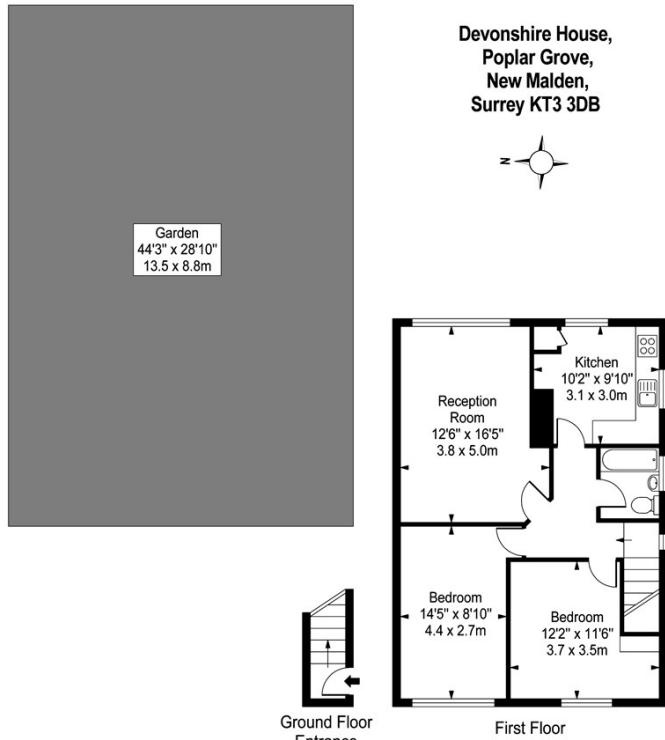

Approx Gross Internal Area **700 Sq Ft - 65.0 Sq M**

For Illustration Purposes Only - Not To Scale
photosandfloorplans.com ©



Energy Efficiency Rating		
	Current	Potential
Very energy efficient - lower running costs		
(92 plus) A		
(81-91) B		
(69-80) C		
(55-68) D		
(39-54) E		
(21-38) F		
(1-20) G		
Not energy efficient - higher running costs		
England & Wales	EU Directive 2002/91/EC	

Agents Note: Whilst every care has been taken to prepare these particulars, they are for guidance purposes only. All measurements are approximate and are for general guidance purposes only and whilst every care has been taken to ensure their accuracy, they should not be relied upon and potential buyers/tenants are advised to recheck the measurements

Wimbledon Village
Unit 6 (2nd Floor)
2 Allington Close
Wimbledon Village
Wimbledon
London
KT3 3DN

020 3597 3484
info@elizabeth-wightwick.co.uk

