



74 HIGH STREET WIMBLEDON LONDON, SW19 5EG

£2,500 PCM

Welcome to this exquisite property located on High Street in the charming Wimbledon Village, London. This stunning apartment boasts 2 bedrooms and 1 bathroom, making it the perfect cozy retreat for anyone looking to reside in this prime location.

Situated in a prime building with only three other apartments in the heart of Wimbledon Village, this property offers an exclusive and private living experience. The recent renovation adds a modern touch to the traditional charm of the building, providing a perfect blend of comfort and style.

One of the highlights of this property is the fantastic rooftop terrace, where you can enjoy breathtaking views of the surrounding area while sipping your morning coffee or hosting intimate gatherings with friends and family.



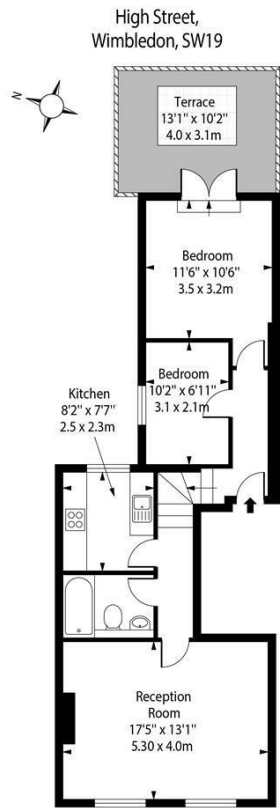

Second Floor

Approx Gross Internal Area 624 Sq Ft - 58.0 Sq M
For Illustration Purposes Only - Not To Scale
photosandfloorplans.com ©



Energy Efficiency Rating		
	Current	Potential
Very energy efficient - lower running costs		
(92 plus) A		
(81-91) B		
(69-80) C		
(55-68) D		
(39-54) E		
(21-38) F		
(1-20) G		
Not energy efficient - higher running costs		
England & Wales	EU Directive 2002/91/EC	

Agents Note: Whilst every care has been taken to prepare these particulars, they are for guidance purposes only. All measurements are approximate and are for general guidance purposes only and whilst every care has been taken to ensure their accuracy, they should not be relied upon and potential buyers/tenants are advised to recheck the measurements

Wimbledon Village
Unit 6 (2nd Floor)
2 Allington Close
Wimbledon Village
Wimbledon
London
KT3 3DN

020 3597 3484
info@elizabeth-wightwick.co.uk

