



10 Ivanhoe Close, Uxbridge, UB8

Offers Over £425,000

 2  2  1



TOWNHOUSE - TWO BEDROOM - TWO BEDROOM - OFF STREET PARKING - UTILITY ROOM - PRIVATE REAR GARDEN

Henry Wiltshire is pleased to present this well-maintained two-bedroom, two-bathroom townhouse situated across three floors. This property offers a utility room on the ground floor, a W/C and kitchen that opens to the private garden on the first floor, second floor with reception room, third floor a bedroom one with a bathroom, and fourth floor locates the second bedroom overlooking the front of the property.

- Town House
- Two Bathroom
- Off Street Parking
- Utilities
- 0.4 miles from Brunel University
- Two Bedroom
- W/C
- Private Garden
- 0.8 miles from Hillingdon Hospital
- Freehold

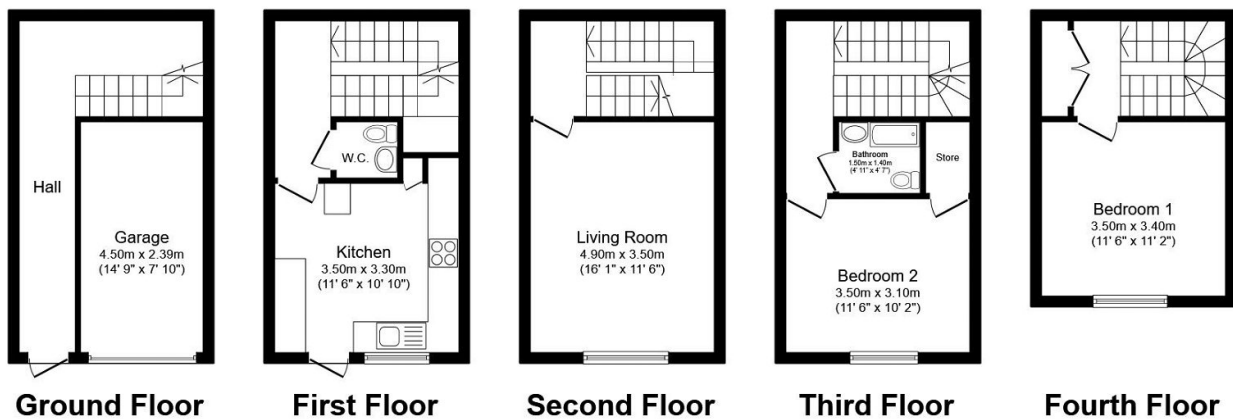

This floor plan is for illustrative purposes only. It is not drawn to scale. Any measurements, floor areas (including any total floor area), openings and orientation are approximate. No details are guaranteed, they cannot be relied upon for any purpose and they do not form part of any agreement. No liability is taken for any error, omission or misstatement. A party must rely upon its own inspection(s). Powered by www.focalagent.com