



## Clivesdale Drive, Hayes, UB3 3PX

Guide Price £325,000

 1  1  1



**MID TERRACE HOUSE - ONE BEDROOM - ONE BATHROOM - PRIVATE REAR GARDEN - PRIVATE FRONT GARDEN - OFF STREET ALLOCATED PARKING**

Henry Wiltshire are delighted to present this charming 1-bedroom mid terrace house, perfect for first-time buyers and investors alike.

Key Features includes a reception room which is both cozy and inviting space, perfect for relaxing and entertaining, well-equipped kitchen with modern appliances, leading out to a private rear garden which offers a serene outdoor space featuring a small pond, ideal for gardening or unwinding in the fresh air. Spacious and comfortable, offering ample storage options, and a well-appointed bathroom with contemporary fixtures. Good Size Hallway/Landing providing additional space and potential for various uses.

This lovely property combines comfort and convenience, offering a perfect blend of indoor and outdoor living. Don't miss the opportunity to make it your own!

- Mid Terrace House
- One Bathroom
- Private Rear Garden
- Freehold
- One Bedroom
- Allocated Off Street Parking
- Private Front Garden
- 
- 

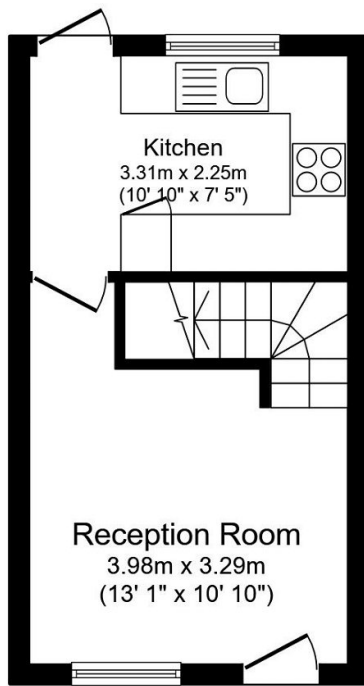

**Ground Floor**

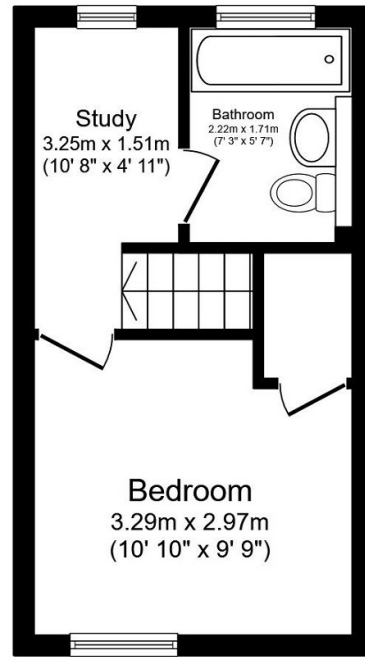

**First Floor**

This floor plan is for illustrative purposes only. It is not drawn to scale. Any measurements, floor areas (including any total floor area), openings and orientation are approximate. No details are guaranteed, they cannot be relied upon for any purpose and they do not form part of any agreement. No liability is taken for any error, omission or misstatement. A party must rely upon its own inspection(s). Powered by [www.focalagent.com](http://www.focalagent.com)