

Navigation Building, High Point Village, Hayes, UB3

Guide Price £475,000

3 2 1



THREE BEDROOM - TWO BATHROOM - CONCIERGE - GYM - SWIMMING POOL - ALLOCATED PARKING

Henry Wiltshire are pleased to present this Three bedroom, Two bathroom luxury apartment situated in the popular High Point Village development adjacent to Hayes and Harlington train station. Offering spectacular views over North West London. Gymnasium and swimming pool. A commuters paradise. Accommodation; Three bedrooms (with luxury en-suite bathroom), Further luxury bathroom, Fully fitted kitchen with appliances, Lounge with floor to ceiling windows offering spectacular views. Benefits; A Concierge, Gymnasium, Swimming pool, Double glazing, Gas central heating, Entry-phone system.

- Three Bedroom
- Two Bathroom
- Balcony
- Parking
- 24hr Concierge
- Gym
- Swimming Pool
- Communal Garden
- Chain Free
- Leasehold

Navigation Building

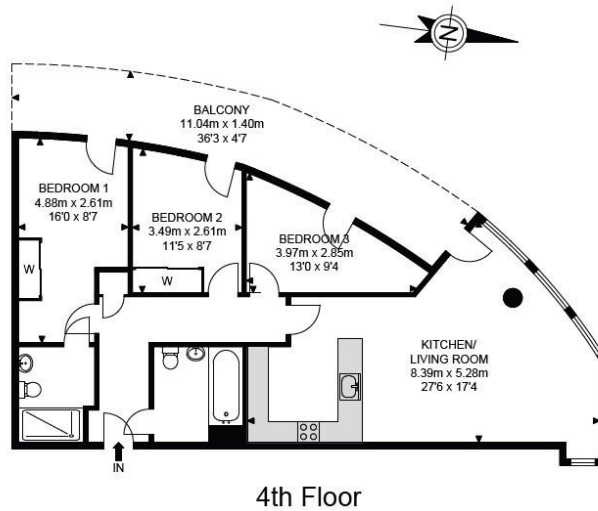

APPROX. GROSS INTERNAL FLOOR AREA 837.43 SQ FT / 77.80 SQM
APPROX. GROSS EXTERNAL FLOOR AREA 202.36 SQ FT / 18.80 SQM

Whilst every attempt has been made to ensure the accuracy of the floor plan contained here, measurements of doors, windows, rooms and any other items are approximated and no responsibility is taken for any error, omission or mis-statement. This plan is for illustrative purposes only and should be used as such by any prospective purchaser. The service, system and appliances shown have not been tested and no guarantee as to their operability or efficiency can be given.

© SpacePhoto

Photography and Floor Plan