



LEE CHADWICK

SOLICITORS LLP
& ESTATE AGENTS



Manor Road

Witney

Price £270,000

Telephone 01993 703272 Email kr@lee-chadwick.co.uk

www.lee-chadwick.co.uk

Local Authority: West Oxfordshire District Council

Council Tax Band: C for 2024/2025 - Tenure: Freehold

Situated on the popular development of Cottages this Two Bedroom House comes with Off-Street Parking, Sitting Room with access to private rear Garden, Separate Kitchen.

The property comprises:

- Entrance Hall
- Fitted Kitchen
- Sitting Room with Door to Garden
- Two Bedrooms
- Bathroom
- Private Rear Garden
- Allocated Parking Space
- **No Onward Chain**

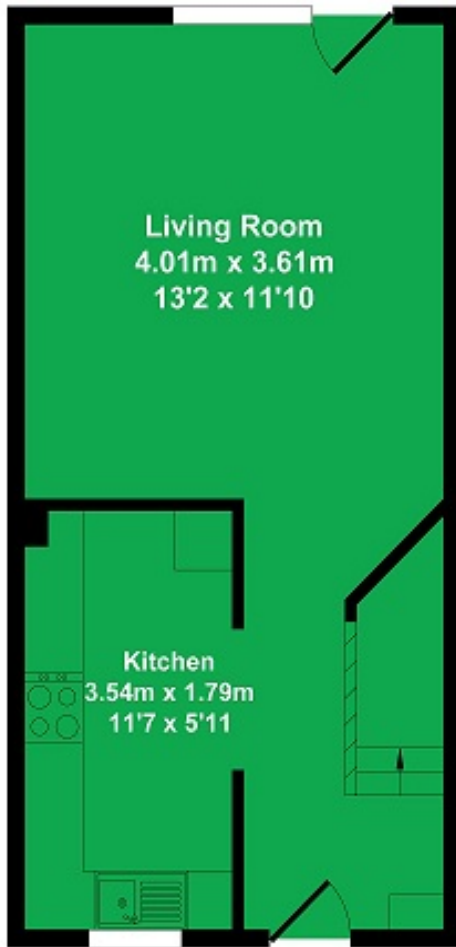

Ground Floor
 Approx. Floor
 Area 27.60 Sq.M.
 (297 Sq.Ft.)



First Floor
 Approx. Floor
 Area 27.60 Sq.M.
 (297 Sq.Ft.)

Total Approx. Floor Area 594 Sq.Ft. (55.20 Sq.M.)











Manor Road is a short distance from the town centre comprising local pubs, restaurants and coffee shops together with local secondary and primary schools and leisure centre. Easy access to local bus routes to Oxford and London. Coombe rail station is 5.6 miles away and Hanborough rail station is 6 miles.

Disclaimer: Lee Chadwick endeavours to ensure that the floorplans, measurements and descriptions are accurate but cannot accept any responsibility for any errors, misstatements or omissions. In any event all measurements are approximate and these particulars are intended for guidance purposes only. Wide angled lenses may have been used for the photography. Lee Chadwick has not tested any appliances and purchasers should not assume that any reference to them means that they are included in the sale. It should not be assumed that any necessary planning or building regulation or listed building consents have been obtained. Any warranty or representation in relation to the property may not be relied upon. These particulars may not be included or relied upon in any offer nor may they form part of any contract. Purchasers must rely on their own inspection, legal enquiry and survey in all respects

Our ref: KR