



LEECHADWICK
SOLICITORS LLP
& ESTATE AGENTS



Abbey Road

Witney

Price £310,000

Telephone 01993 703272 Email kr@lee-chadwick.co.uk

www.lee-chadwick.co.uk

Local Authority: West Oxfordshire District Council

Council Tax Band: C for 2023/2024 - Tenure: Freehold

A 2 Bedroom Semi-Detached Bungalow comprising Living Room, Kitchen and Garage in the Popular Market Town of Witney. No Onward Chain.

The property comprises:

- Central Entrance Hall
- Kitchen with access to rear garden
- Living room
- Two Bedrooms
- Family Bathroom
- Driveway and Garage with rear access
- Large Rear Garden

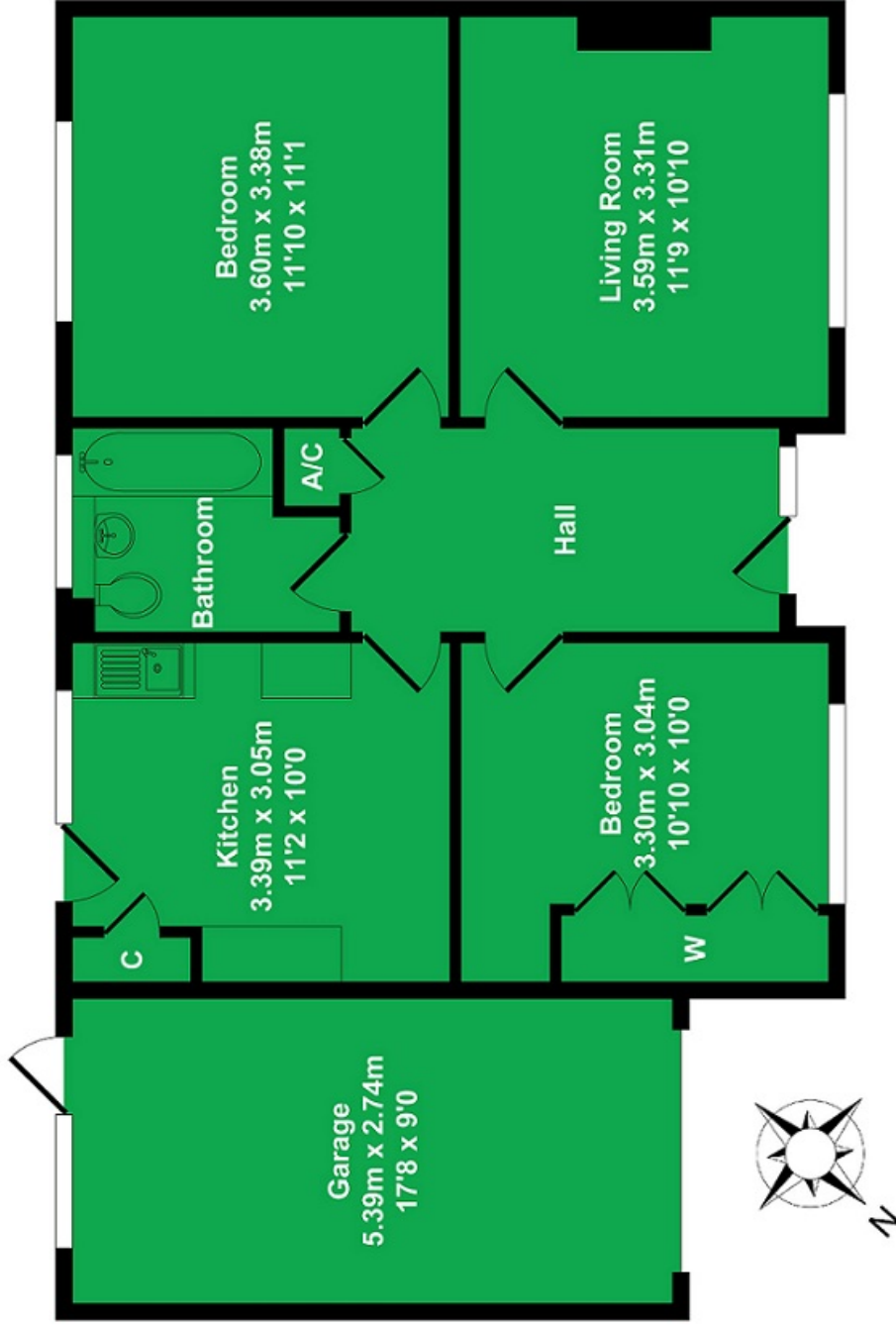

Total Approx. Floor Area 792 Sq.Ft. (73.60 Sq.M.)









Witney is a Popular Market Town in the Cotswolds the property is a short distance from the town centre with a variety of shops including coffee shops and restaurants and local cinema with easy connections to Oxford and London. Witney also benefits from primary and secondary schools and pre-school nurseries.

Disclaimer: Lee Chadwick endeavours to ensure that the floorplans, measurements and descriptions are accurate but cannot accept any responsibility for any errors, misstatements or omissions. In any event all measurements are approximate and these particulars are intended for guidance purposes only. Wide angled lenses may have been used for the photography. Lee Chadwick has not tested any appliances and purchasers should not assume that any reference to them means that they are included in the sale. It should not be assumed that any necessary planning or building regulation or listed building consents have been obtained. Any warranty or representation in relation to the property may not be relied upon. These particulars may not be included or relied upon in any offer nor may they form part of any contract. Purchasers must rely on their own inspection, legal enquiry and survey in all respects

Our ref: KR/WIC001.0004