

STOREYS

Flat 1 Willow Keepers Yard, The Roundway, London, N17 7AB
£2,500 Per month

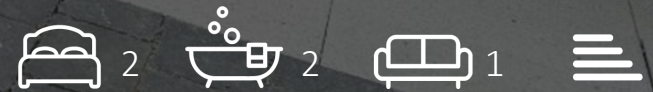

STOREYS

Floor Plan

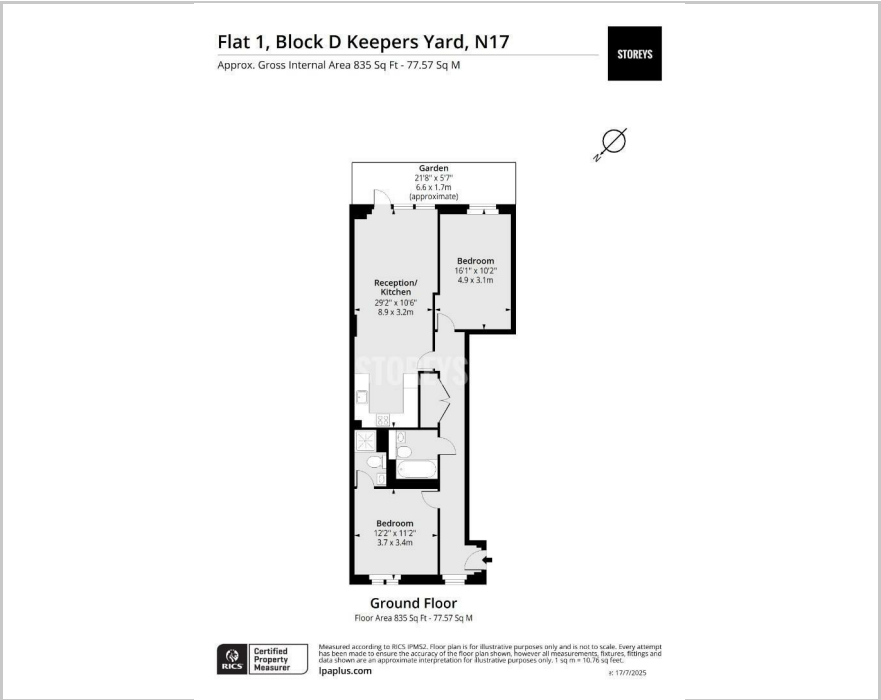

Area Map



These particulars, whilst believed to be accurate are set out as a general outline only for guidance and do not constitute any part of an offer or contract. Intending purchasers should not rely on them as statements of representation of fact, but must satisfy themselves by inspection or otherwise as to their accuracy. No person in this firms employment has the authority to make or give any representation or warranty in respect of the property.

77 Containerville 1 Emma Street, Bethnal Green, E2 9FP
Tel: 0207-096-0666 Email: lettings@storeys.co <https://www.storeys.co/>

Accommodation

- New-Build
- 10 Minutes to Bruce Grove Station
- Patio Courtyard
- Open Plan Living Space
- Bruce Castle Park
- Eateries & Coffee Shops
- 2 Bedrooms
- 835 Sq. ft
- Communal Roof Terrace
- Underfloor Heating

Viewing

Please contact our Storeys of London Office on 0207-096-0666 if you wish to arrange a viewing appointment for this property or require further information.

Energy Efficiency Graph

