

SALES & LETTINGS

STOBART
& HURRELL



STOBART
& HURRELL

WE BRING PEOPLE AND PROPERTY TOGETHER





STOBART
& HURRELL

Buxton Road, Spixworth, Norfolk, NR10 3PW

A detached bungalow, that presents as an ideal family home with the added benefit of a stunning indoor swimming pool with changing and toilet facilities. The property is located in the Broadland village of Spixworth, which sits just to the north of the county's historic city of Norwich. It is conveniently located with easy access to Norwich Airport as well as local amenities that include a medical practice, village hall, supermarket, convenience store, public house and social club and under a mile to both the Infant and Junior School.

Set back from the road, the bungalow is approached over a brick-weave driveway, providing ample off-road parking and access to a double garage and neatly maintained lawn gardens. To the rear, a raised terrace overlooks a south east facing lawn garden that is bordered by mature shrubs and leads to a sheltered canopy ideal for alfresco dining. Sliding doors, that open to the garden, provide access to the swimming pool and a dining area provides for a pool side snack.





**STOBART
& HURRELL**

- IDEAL FAMILY HOME
- DETACHED BUNGALOW
- INDOOR SWIMMING POOL

- CLOSE TO LOCAL AMENITIES
- WELL-PRESENTED THROUGHOUT
- SOUTH EAST FACING REAR GARDEN

- LESS THAN FIVE MILES INTO NORWICH
- OFF-ROAD PARKING & DOUBLE GARAGE
- THREE BEDROOMS, MASTER WITH EN-SUITE

Well-presented throughout, the main entrance to the property leads into a hallway where separate internal doors provide access to a family bathroom and three bedrooms, one with built in storage and the main with an en-suite shower room. Further doors lead into a separate utility, a kitchen and a generous lounge dining room with double doors that overlook and open out to the rear terrace.

Life at the property is further complimented in its proximity, of approximately five miles, to the Norfolk Broads, the historic city of Norwich with its numerous restaurants, night life, public houses and historical interest, or a thirty-minute car journey to the sandy beaches of the Norfolk coastline.





STOBART
& HURRELL

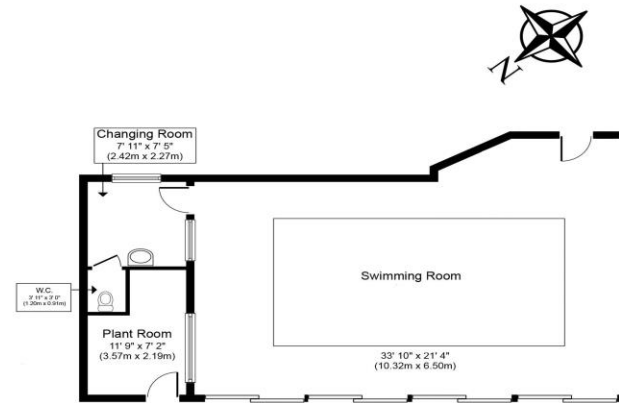
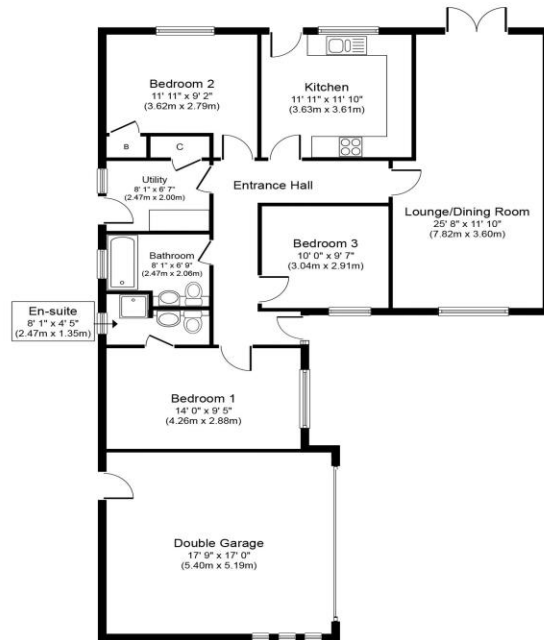

Approximate Floor Area
1,084 sq. ft.
(1007.7 sq. m.)

Whilst every attempt has been made to ensure the accuracy of the floor plan contained here, measurements of doors, windows, rooms and any other items are approximate and no responsibility is taken for any error, omission, or mis-statement. The measurements should not be relied upon for valuation, transaction and/or funding purposes. This plan is for illustrative purposes only and should be used as such by any prospective purchaser or tenant. The services, systems and appliances shown have not been tested and no guarantee as to their operability or efficiency can be given.

Score	Energy rating	Current	Potential
92+	A		
81-91	B		85 B
69-80	C		
55-68	D	67 D	
39-54	E		
21-38	F		
1-20	G		















STOBART
 HURRELL

STOBART
 HURRELL



Whether selling, buying or letting, there can be plenty to organise. Our range of services and our experience of the local market means we can help or recommend like-minded reputable firms to assist you with your move.

						
Sales	Property Auctions	Lettings	Property Management	Sale/ Rental Valuation	Estate Administration (Probate)	Land & New Homes
						
Second Home Service	Property Cleaning Service	Mortgages	Solicitors	Surveyors	Service Providers	



Come in and meet us, visit us on line or call and speak to one of the team to learn more.

Stobart & Hurrell
 Unit 3A, Station Business Park, Horning Road West, Hoveton, Norfolk NR12 8QJ

www.stobarthurrell.co.uk
enquiries@stobarthurrell.co.uk
 01603 782 782

