



26 Lees Buildings, Hipperholme, Halifax, HX3 8EW

£150,000

- Two Double Bedrooms.
- Hipperholme, HX3
- Private Parking For 2 Cars.

26 Lees Buildings, Halifax HX3 8EW

A delightful two-bedroom end-terrace home comprised over three floors, situated within walking distance to Hipperholme high st. The property benefits from deceptively large rooms and a recently fitted bathroom. This property would make an ideal first home or buy-to-let investment.



Location.

The property is situated within walking distance to Hipperholme High St and other well-renowned schools, shops and other amenities.

Entrance.

Leading to the kitchen and access to the lounge and basement.

Kitchen.

A galley-style kitchen, fitted with a selection of integral appliances and a comprehensive range of wall and base-level units that provide ample storage options with solid worktops.

Basement

A useful dry space that is currently housing the washing machine. It's great for storage and has full power and lighting.

Lounge.

This room can accommodate an array of lounge furniture and seating arrangements. Feature gas fire and mantle piece.

Dining Room.

A separate dining area that can accommodate a large dining table with a range of seating arrangements.

First Floor Landing.

First-floor landing leading to bedrooms one, two and bathroom.

Bedroom One.

A spacious carpeted double bedroom that can accommodate a large double bed, bedside tables and free-standing wardrobes.

Bedroom Two.

Access to the third floor, a spacious carpeted double bedroom that can accommodate a large double bed, bedside tables and free-standing wardrobes.

Bathroom.

A brand new bathroom with a large walk-in wet area and fitted bath, low-level flush W.C. and wash hand basin.

External.

Private parking leads to a rear patio seating area.

Agent Notes.

The information provided on this property does not constitute or form part of an offer or contract, nor maybe it be regarded as representation. All interested parties must verify accuracy and your solicitor must verify tenure/lease information, fixtures & fittings and, where the property has been extended/converted, planning/building regulation consents. All dimensions are approximate and quoted for guidance only as are floor plans which are not to scale, and their accuracy cannot be confirmed. Reference to appliances and/or services does not imply that they are necessarily in working order or fit for the purpose.



GROUND FLOOR
345 sq.ft. (31.9 sq.m.) approx.



1ST FLOOR
352 sq.ft. (32.7 sq.m.) approx.

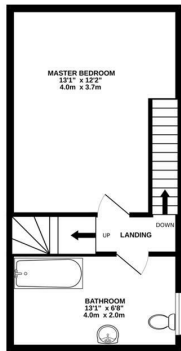

2ND FLOOR
259 sq.ft. (24.1 sq.m.) approx.

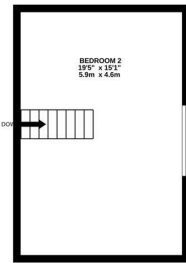

TOTAL FLOOR AREA: 956 sq. ft. (88.8 sq. m.) approx.
Whilst every attempt has been made to ensure the accuracy of the foregoing contained herein, measurements of doors, windows, rooms and any other items are approximate and no responsibility is taken for any error, omission or mis-statement. This plan is for illustrative purposes only and should be used as such by any prospective purchaser. The services, systems and appliances shown have not been tested and no guarantee as to their operability or efficiency can be given.
Made with MetreMax ©2023



Viewings

Viewings by arrangement only. Call 01422 756001 to make an appointment.