

urbansplash

Vanilla Factory Ropewalks Liverpool

PROUD TO BE
A BUSINESS
BASED IN
ROPEWALKS



**Office / retail / leisure
to let**
283 sq ft - 7,913 sq ft

Vanilla Factory is an eclectic mix of stunning Victorian design and 21st Century architecture. Set within the lively area of Ropewalks at

the heart of Liverpool city centre, Vanilla factory is home to an array of design led and creative businesses.

Hitchcock Wright
CHARTERED SURVEYORS & Partners
0151 227 3400
www.hitchcockwright.co.uk

CBRE
0151 224 7666
www.cbre.co.uk

0333 666 0000
commercial@urbansplash.co.uk
www.urbansplash.co.uk/vanilla-factory



Interior of Vanilla Factory

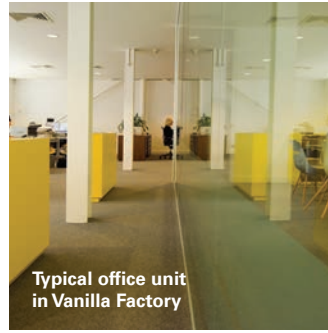

Typical office unit
in Vanilla Factory



Interior of Vanilla Factory



Ropewalks

Vanilla Factory

39 Fleet Street

Liverpool

L1 4AR

The birth of Vanilla Factory came from the amalgamation of three existing buildings and a new build section which is fronted by the striking new fully glazed façade. With a mix of office and ground floor retail and leisure space, and units varying from 283 sq ft and up to 7,913 sq ft, Vanilla Factory has something to offer every business.

Location

Vanilla Factory is another exciting addition to the growing creative and cultural quarter of Liverpool dominated by the Ropewalks regeneration area, which includes the flagship Urban Splash mixed use development, Tea Factory, the successful FACT centre and the nearby Concert Square.

» [Click here to see location map](#)



Typical office unit in Vanilla Factory



Typical retail/leisure unit in Vanilla Factory



Typical office unit in Vanilla Factory

Specification

Finishes, fixtures and fittings

- Modern double height reception area
- Open plan offices
- Feature electric external louvre system on new build façade
- Mechanical heating and ventilation to new build
- Storage heating to refurbished offices
- LG3 lighting

Services

- Secure door entry system
- On site Building Manager

Common areas

- Self-contained unit or shared kitchen and WCs

Floor areas

Unit number	Area (Sq ft)	Area (Sq m)
Ground floor		
G1	867	80
G2	959	89
G + basement bar	5,067	471
G + first floor bar	7,913	735
Ground floor bar	6,491	603

First floor		
100	2,519	234

Second floor		
200	2,637	245
201	1,255	117
202	1,507	140
203	1,345	125
204	1,414	131
205	805	74
206	385	38
207	484	45
208	1,289	120
209	880	82
210	283	26
211	377	35
212	301	28
213/214	461	43

Unit number	Area (Sq ft)	Area (Sq m)
Third floor		
300	2,637	245
301	1,130	105
302	1,507	140
303	1,346	125
304	1,421	132
305	1,464	136
306	841	78
307	474	44
308	377	35
309	289	27
310	355	33
311	204	19

Fourth floor		
400	1,163	108

Existing tenants include:

Baa Baa Ltd, Uniform Communications Ltd, Bolland & Lowe, Studio 3 Architects Ltd, Body Project Ltd, Medication Ltd, Design Liverpool Ltd, Andrew Collinge, Taylor Young, Hobs Reprographics, R & J Guinan, Michael Cunningham Architects Ltd, Crisis UK, Red Kitchen, Zoo Leisure Ltd, Error Creative Studios Ltd

Floor plans

Ground floor

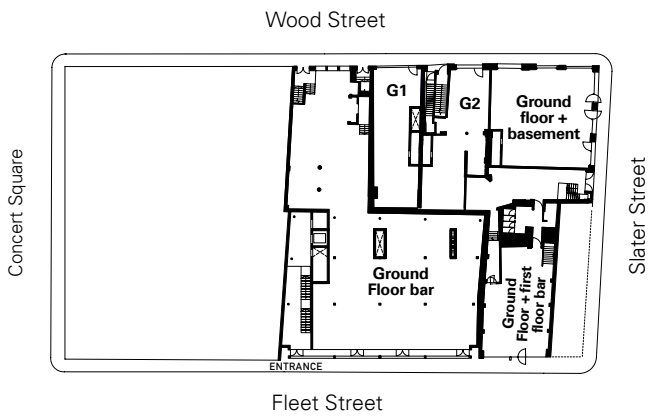

First floor



Second floor

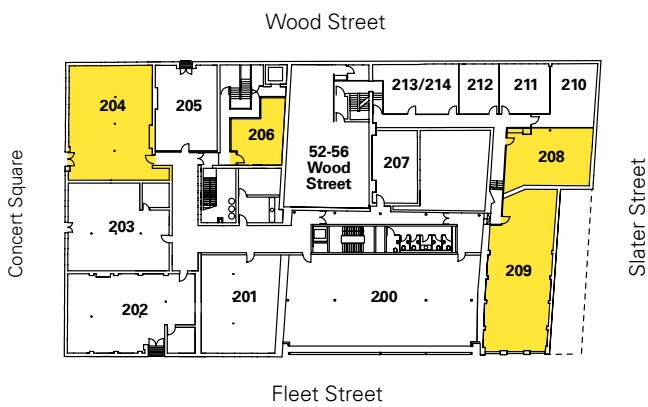

Third/fourth floor

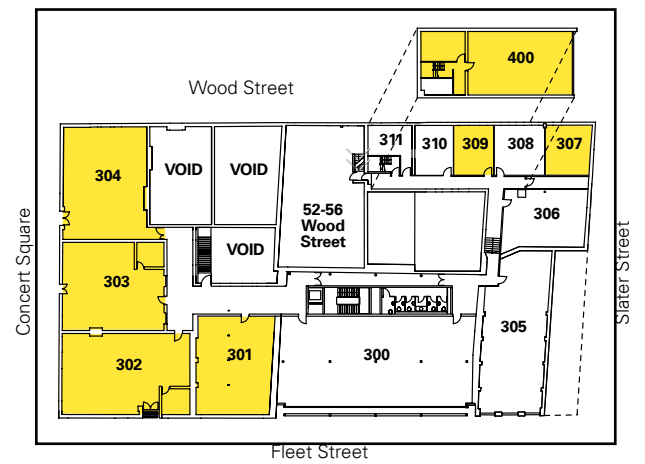

 available to let

DISCLAIMER: Urban Splash and Agents acting on their behalf give notice that:
 1. These particulars are produced in good faith, are set out as a general guide only and do not constitute part of a contract, 2. No person in the employment of Urban Splash or their Agents has any authority to make or give any representation or warranty in relation to this property, 3. Unless otherwise stated all prices and rents are quoted exclusive of VAT, 4. Date of publication May 2013