

Bromham Rd | Biddenham | MK40 4BS



Shared ownership at

St Andrews at Kings Field

A new way of living

Location, location, location...

The premium residential location of Biddenham is less than a mile from the varied amenities of Bedford town centre and provides easy access to major road and rail links.

The development itself lies on the former site of the Bedfordshire Golf Club and has been subject to very high levels of demand since the first plots were released for sale in 2016.

Our well-specified 2 & 3 bedroom homes offer a modern, sustainable living choice, with finishes carefully considered to provide a tasteful, neutral canvas...ready for you to add your own, unique signature.

Specification highlights

- Modern, neutral kitchen cabinets and worktops
- Built-in oven, hob & extractor
- Modern white sanitary ware with thermostatic showering and glass screen
- Wood-effect flooring to kitchens & bathrooms
- Carpeting to all other rooms, available as an early-purchase incentive
- Allocated parking
- Fully enclosed, turfed rear gardens



The Pine - Plots 184 & 185

Development plan

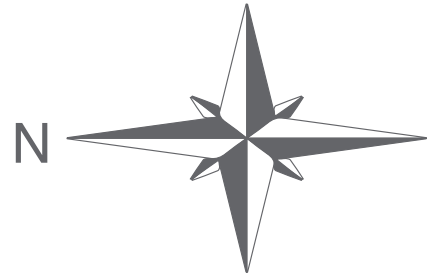

-  The Pine - 2 bedroom home
-  The Alder - 2 bedroom home
-  The Chestnut - 3 bedroom home
-  The Maple - 3 bedroom home
-  Plot parking



This plan been prepared and is intended as a convenient guide only and does not form any part of an offer or contract. Accordingly, there shall be no liability as a result of any error or omission as published.

Own it

Having a stake in your home is a great feeling and shared ownership makes this a realistic option; one which tens of thousands of people across the country have already taken up.

Key features:

- You buy and own a significant stake in your home, rather than just renting with no return.
- Your combined monthly mortgage and 'rent' - the fee we charge on the bit you haven't bought - are considerably less than buying outright and often around the same as renting an equivalent home.
- You don't need a really big deposit, as it's based on the share you're buying, rather than the whole property value.
- You can buy more shares at any time...until it's all yours. (We call this 'Staircasing up').
- Or, if you want to move on, you simply sell your share for its market value at the time.

The numbers

As a headline example:

Full property value - £255,000

40% share - £102,000

5% deposit - £5,100

Monthly mortgage - £490

Monthly fee - £351

Total monthly mortgage & fee - £841



The small print

* The example above is based on a mortgage rate of 4.49% and a term of 30 years. Please note that rates/terms vary and that eligibility/affordability criteria apply. Shares range from 25-75%, subject to availability. A management/service charge will be payable on this development.

Disclaimer

IMPORTANT NOTICE These brief particulars have been prepared and are intended as a convenient guide to supplement an inspection or survey and do not form any part of an offer or contract. Their accuracy is not guaranteed. They contain statements of opinion and in some instances we have relied on information supplied by others. Design elements and specification details may change without notice. You should verify the particulars on your visit to the property and the particulars do not replace the need for a survey and appropriate enquiries. Accordingly, there shall be no liability as a result of any error or omission in the particulars or any information given. Date of publication: May 2017

Development location



Contact the sales team for more information on:

 01733 396406

 www.crosskeyshomes.co.uk/sharedownership

 sales@crosskeyshomes.co.uk

 CrossKeysHomesPeterborough

 @CrossKeysHomes

The Pine

2 bedroom homes

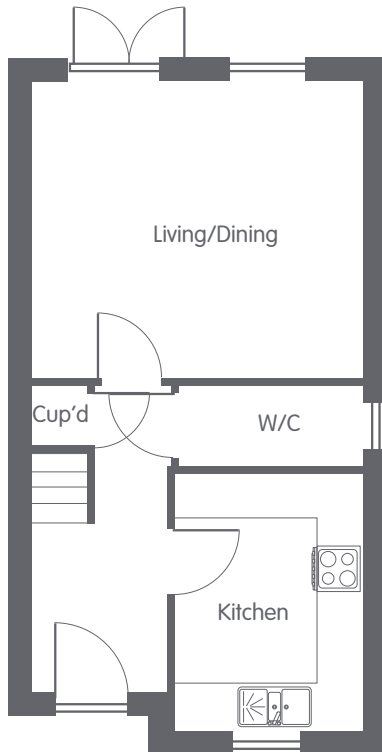

Ground floor

Lounge/Dining
4.51m x 4.52m

Kitchen
3.62m x 2.52m

First floor

Bedroom 1
4.45m x 3.15m

Bedroom 2
4.45m x 2.84m

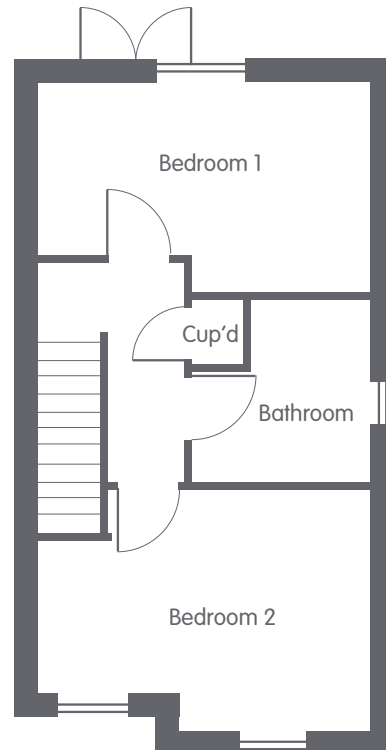

The Alder

2 bedroom homes

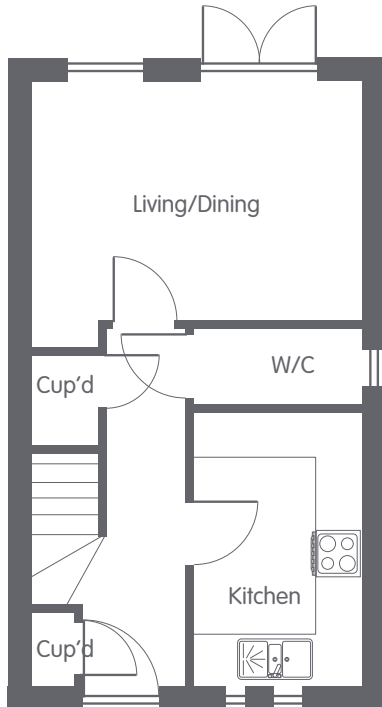

Ground floor

Lounge/dining
4.42m x 3.22m

Kitchen
3.67m x 2.29m

First floor

Bedroom 1
4.42m x 3.57m

Bedroom 2
3.29m x 2.45m

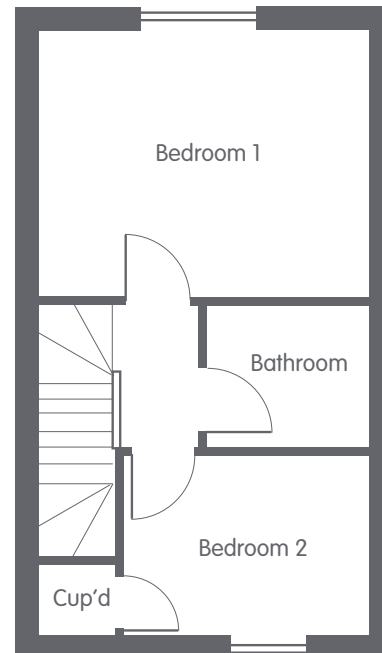

The Chestnut

3 bedroom homes

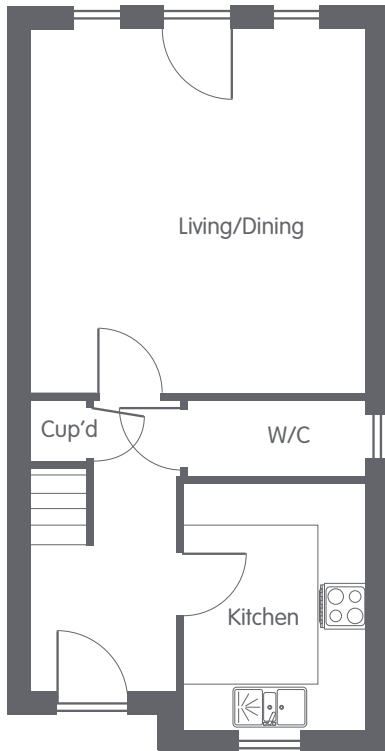

Ground floor

Lounge/Dining
5.02m x 4.57m

Kitchen
3.37m x 2.52m

First floor

Bedroom 1
4.57m x 2.99m(max)

Bedroom 2
4.34m x 2.25m

Bedroom 3
3.28m x 2.27m

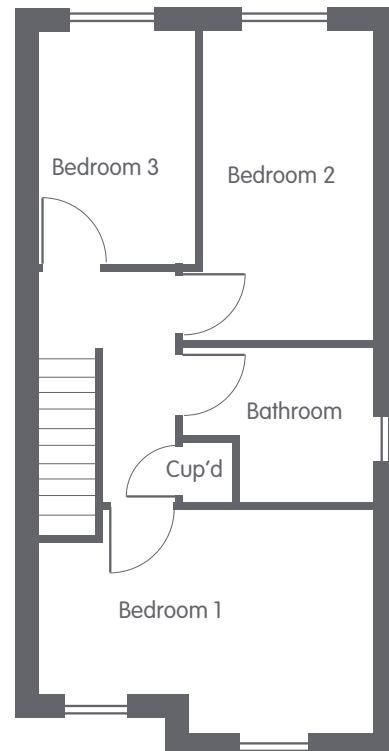

The Maple

3 bedroom homes

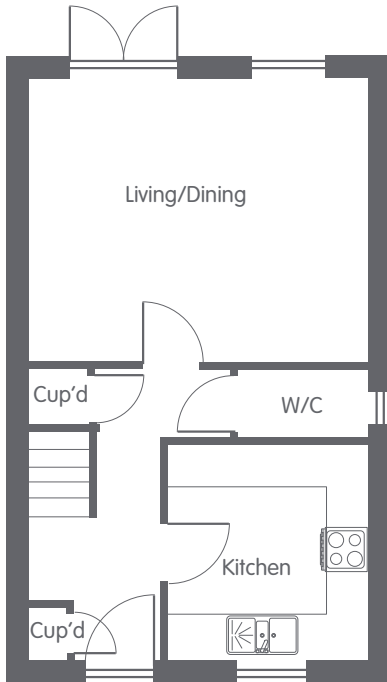

Ground floor

Lounge/Dining
4.98m x 4.17m

Kitchen
3.17m x 3.17m

First floor

Bedroom 1
4.15m x 2.71m

Bedroom 2
4.34m x 2.71m

Bedroom 3
2.93m x 2.18m

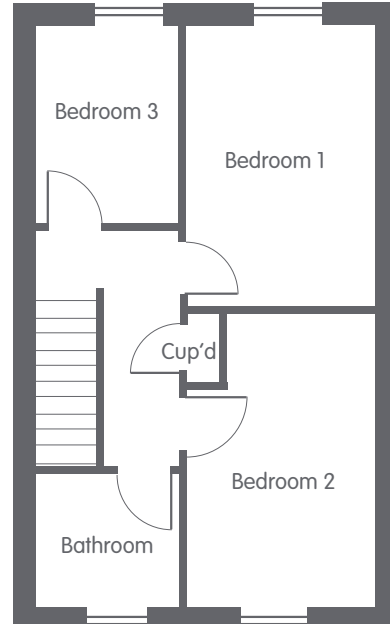

Availability



The Pine – 2 bedroom semi-detached home - Plots 184 & 185

Full market value - £255,000; 40% share - £102,000

The Chestnut – 3 bedroom mid-terrace home – Plot 177

Full market value – £280,000; 40% share - £112,000

The Chestnut – 3 bedroom end-terrace home – Plot 176

Full market value - £285,000; 40% share - £114,000

The Alder – 2 bedroom semi-detached home – Plots 148 & 149

To be released for sale Summer 2017

The Chestnut – 3 bedroom semi-detached home – Plot 168

To be released for sale Autumn 2017

The Maple – 3 bedroom mid-terrace home - Plot 157

To be released for sale Summer 2017

The Maple – 3 bedroom end-terrace home – Plots 156 & 158

To be released for sale Summer 2017

The Maple – 3 bedroom semi-detached home – Plots 154 & 155

To be released for sale Summer 2017

Shares available to purchase between 25% – 75% of the full market value (subject to availability).

An estate management charge will be payable.

Details correct as at 18/5/17