



Royal Crescent Court, The Crescent, Filey, YO14 9JH

Sea Views | Sought After Location | One Bedroom | Ideal Second Home

EPC Rating: TBC

Offers Over: £89,995

HUNTERS®
HERE TO GET *you* THERE

Royal Crescent Court, The Crescent, Filey, YO14 9JH

This second floor studio flat is located within the popular coastal town of Filey and is only a short distance away from the stunning beach as well as the town centre offering an array of amenities. Located on the ever popular The Crescent, this property would make a great coastal retreat for many years to come. Briefly comprising entrance hall with storage, lounge with side sea views, kitchen/diner, single bedroom and bathroom. Viewing is a must to appreciate all this fantastic studio flat has to offer.

ENTRANCE HALL



HALLWAY

1.45m (4' 9") x 5.36m (17' 7")

Coving, storage cupboard and telephone point.

LOUNGE

4.16m (13' 8") x 4.29m (14' 1")

Sash window to the side aspect, coving, feature fireplace with electric fire, TV point and power points.



KITCHEN/DINER

4.21m (13' 10") x 2.16m (7' 1")

Sash window to the side aspect, coving, range of wall and base units with roll top work surfaces, sink and drainer unit, space for fridge/freezer, electric oven, electric hob, extractor fan and power points.



BEDROOM

2.86m (9' 5") x 1.81m (5' 11")

Two opaque windows to the side aspect, coving, storage cupboard and power points.



BATHROOM

1.29m (4' 3") x 1.93m (6' 4")

Opaque window to the side aspect, coving, three piece bathroom suite comprising; panel enclosed bath with mixer taps and shower attachment, low flush WC and wash hand basin with pedestal.

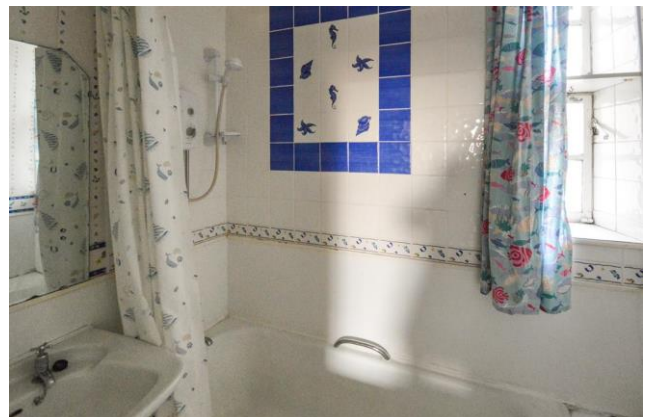

VIEW FROM LOUNGE



OPENING HOURS

Monday: 9am - 5:30pm
Tuesday: 9am - 5:30pm
Wednesday: 9am - 5:30pm
Thursday: 9am - 5:30pm
Friday: 9am - 5:30pm
Saturday: 9am - 4pm
Sunday: Closed

THINKING OF SELLING?

If you are thinking of selling your home or just curious to discover the value of your property, Hunters would be pleased to provide free, no obligation sales and marketing advice. Even if your home is outside the area covered by our local offices we can arrange a Market Appraisal through our national network of Hunters estate agents.

GROUND FLOOR

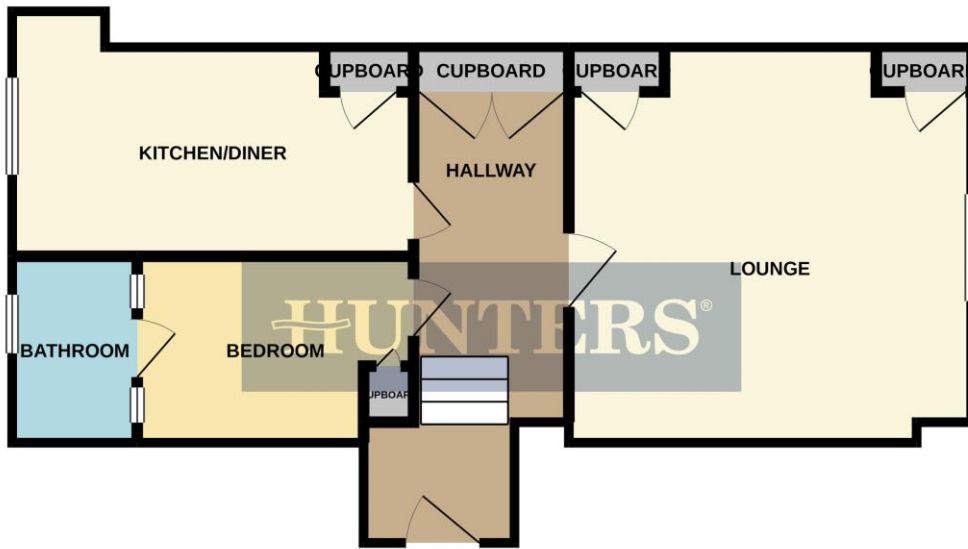

Whilst every attempt has been made to ensure the accuracy of the floorplan contained here, measurements of doors, windows, rooms and any other items are approximate and no responsibility is taken for any error, omission or mis-statement. This plan is for illustrative purposes only and should be used as such by any prospective purchaser. The services, systems and appliances shown have not been tested and no guarantee as to their operability or efficiency can be given.
Made with Metropix ©2021

«EpcGraph»

Energy Performance Certificate

The energy efficiency rating is a measure of the overall efficiency of a home. The higher the rating the more energy efficient the home is and the lower the fuel bills will be.

Hunters 7A Murray Street, Filey, North Yorkshire, YO14 9DA | 01723 338958
filey@hunters.com | www.hunters.com

VAT Reg. No 266 535 874 | Registered No: 10667052 England & Wales | Registered Office: Medina House, 2 Station Avenue, Bridlington, YO16 4LZ
A Hunters franchise owned and operated under license by Coast & Country Filey Limited

DISCLAIMER

These particulars are intended to give a fair and reliable description of the property but no responsibility for any inaccuracy or error can be accepted and do not constitute an offer or contract. We have not tested any services or appliances (including central heating if fitted) referred to in these particulars and the purchasers are advised to satisfy themselves as to the working order and condition. If a property is unoccupied at any time there may be reconnection charges for any switched off/disconnected or drained services or appliances - All measurements are approximate.

