

St Albans Office
10 High Street, St Albans
Herts AL3 4EL
01727 228428
stalbans@cassidyandtate.co.uk

Marshalswick Office
59 The Quadrant, St Albans,
Herts AL4 9RD
01727 832383
marshalswick@cassidyandtate.co.uk

Wheathampstead Office
39 High Street, Wheathampstead,
Herts AL4 8BB
01582 831200
wheathampstead@cassidyandtate.co.uk

Cassidy
& Tate
Your Local Experts



Award Winning Agency



www.cassidyandtate.co.uk

RICHMOND WALK
ST. ALBANS
AL4 9BA

£1,250 Per Month

EPC Rating: E Council Tax Band: C

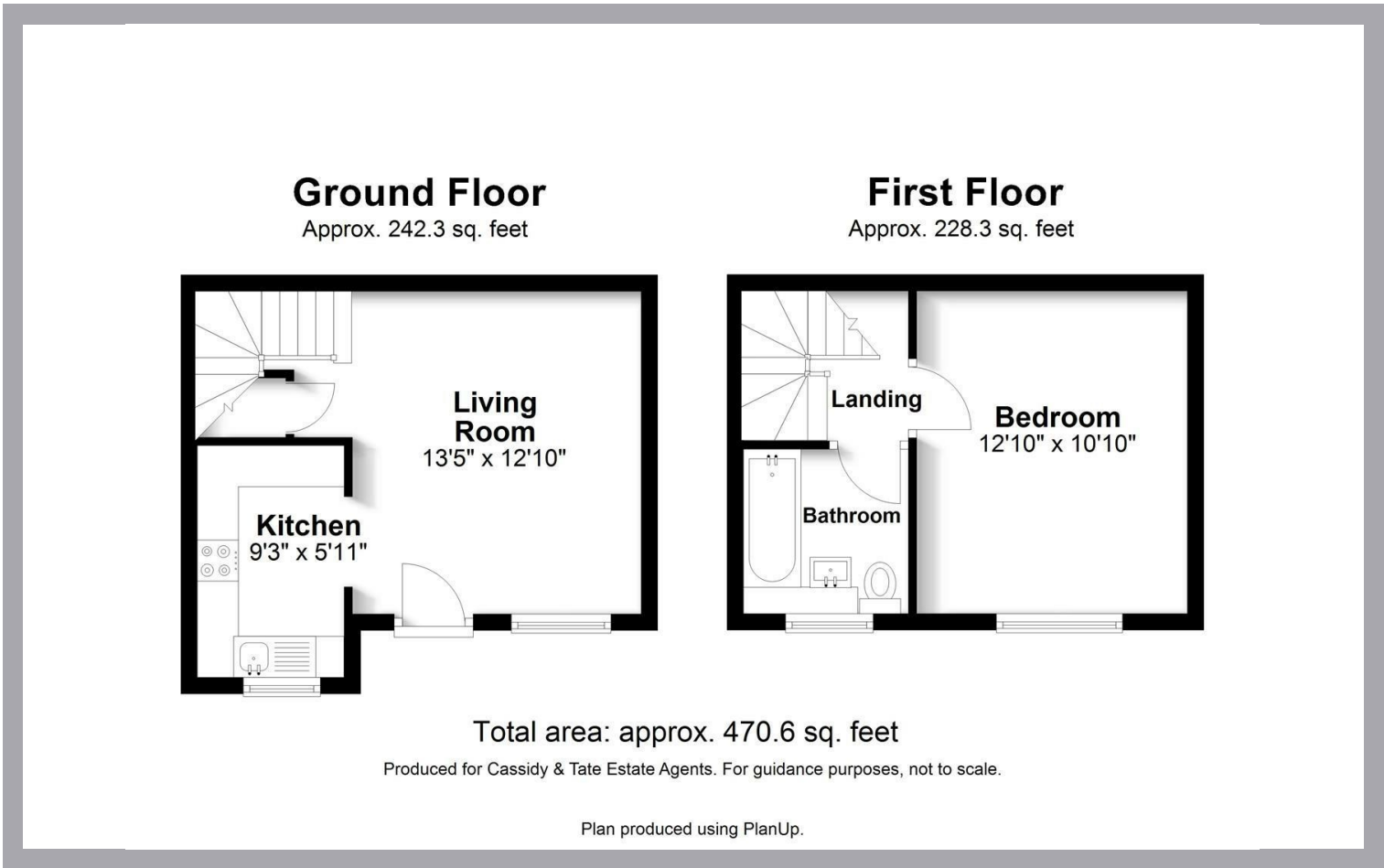

Cassidy & Tate have taken all reasonable steps to ensure the accuracy of the details supplied in our marketing material however, details are provided as a guide only and we advise prospective purchasers to confirm details upon inspection of the property. Cassidy & Tate will not be held liable for any costs which are incurred as a result of discrepancies.

All The Ingredients Needed For A Fabulous Lifestyle

Tucked away in a peaceful cul de sac in the ever popular Jersey Farm development, is this modern one bedroom cluster house with stunning views across to open countryside. The property enjoys bright and flexible living accommodation to include a well proportioned lounge, a fitted kitchen, one double bedroom, a modern bathroom suite, and access to a front garden. Richmond Walk is only a short walk away from the local shopping parade in the centre of Jersey Farm, and next to beautiful open fields. St Albans with its varied shopping and leisure facilities and the mainline railway station remains a short car or bus ride away.



Specialists in Bespoke Properties

- Cluster house
- Kitchen
- Double bedroom
- Views to open fields
- Living room
- Bathroom suite
- Front Garden
- One weeks holding fee based on the asking price £288.46
- Five weeks deposit based on the asking price £1442.30



Energy Efficiency Rating		
	Current	Potential
Very energy efficient - lower running costs		
(92 plus) A		94
(81-91) B		
(69-80) C		
(55-68) D		
(39-54) E	51	
(21-38) F		
(1-20) G		
Not energy efficient - higher running costs		
England & Wales	EU Directive 2002/91/EC	

