

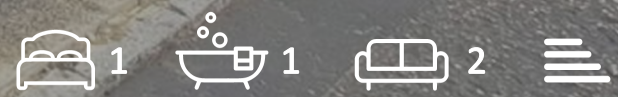

2 Elstone

Orton Waterville PE2 5JY

Offers in the region of £165,000



2 Elstone

Orton Waterville PE2 5JY

Very well presented extended end terrace house in Elstone, a very popular part of Orton Waterville.

This property comprises of;

Ground Floor- entrance hall, kitchen with understairs storage, dining room with door to the garden and patio doors to the lounge, lounge which is an extension has patio doors to the garden.

First Floor- landing with airing cupboard, bedroom one and a bathroom.

Outside- low maintenance frontage with two parking spaces. To the rear, a low maintenance walled garden.

This property is within walking distance to the local amenities, very close to Ferry Meadows Country Park and major transport links. This property has to be viewed to be appreciated.

Tenure: Freehold
Council Tax Band: A



Ground Floor

Entrance Hall

Dining Room

11'10" max x 9'11" max (3.62m max x 3.03m max)

Lounge

9'7" x 8'5" (2.94m x 2.58m)

Kitchen

11'10" x 4'11" (3.63m x 1.50m)

First Floor

Landing

Bedroom

15'2" max x 9'4" max (4.63m max x 2.86m max)

Bathroom



Floor Plan

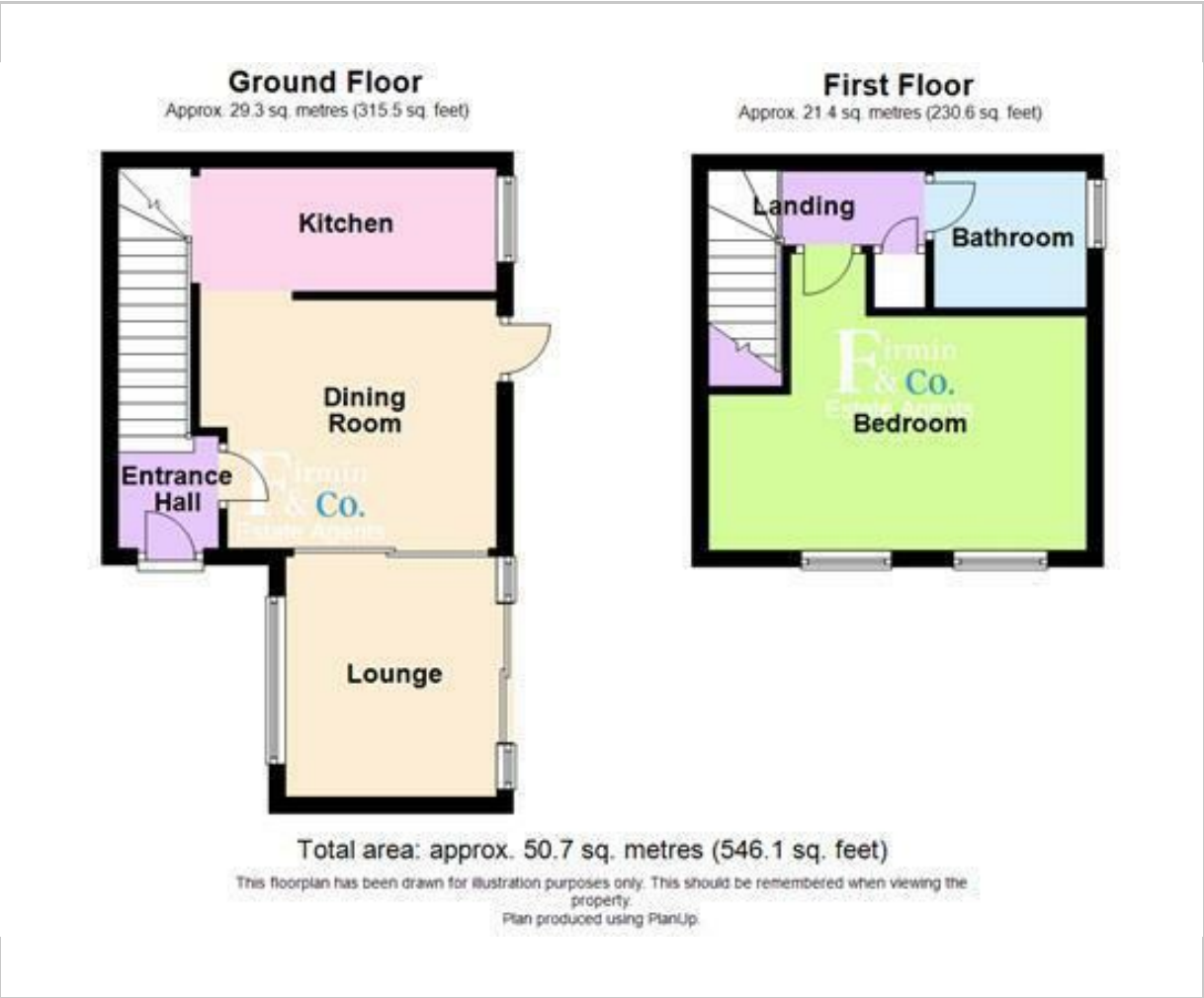

Area Map

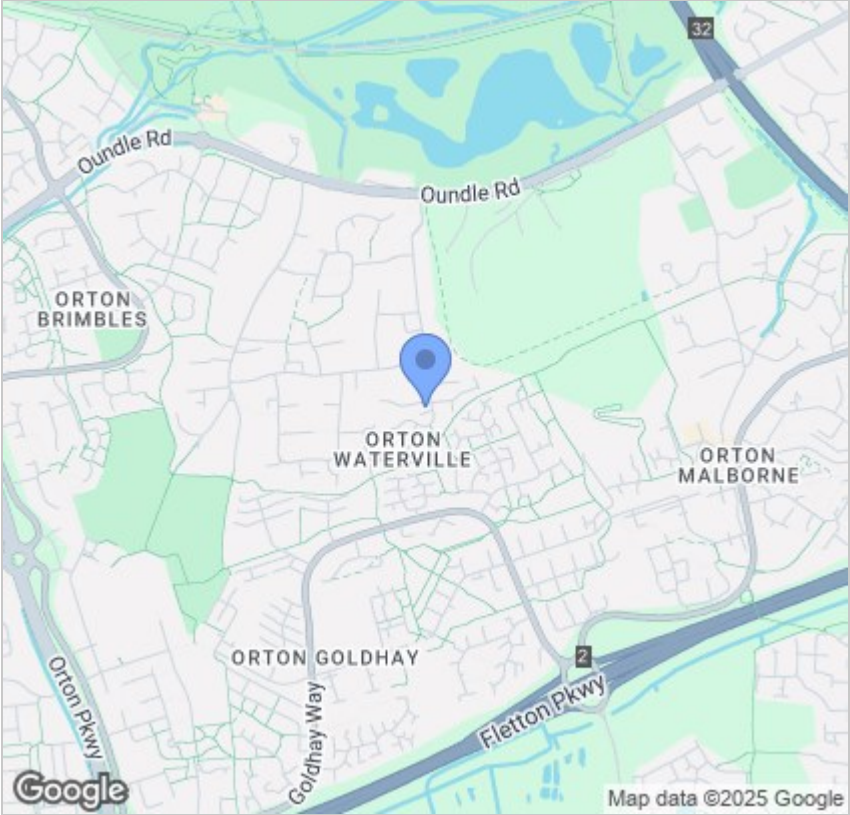

Energy Efficiency Graph

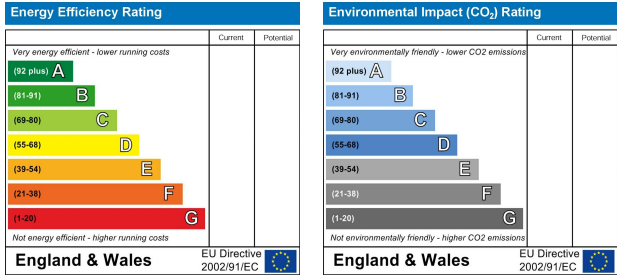

Viewing

Please contact our Orton Office on 01733 852257 if you wish to arrange a viewing appointment for this property or require further information.

These particulars, whilst believed to be accurate are set out as a general outline only for guidance and do not constitute any part of an offer or contract. Intending purchasers should not rely on them as statements of representation of fact, but must satisfy themselves by inspection or otherwise as to their accuracy. No person in this firms employment has the authority to make or give any representation or warranty in respect of the property.



48b Church Drive, Orton Waterville
Peterborough, PE2 5HE
T: 01733 852257
E: orton@firminandco.co.uk