

269 Four Chimneys Crescent

Hampton PE7 8SQ

Offers in the region of £245,000



## 269 Four Chimneys Crescent Hampton PE7 8SQ

Brilliantly presented mid terrace house on Four Chimneys Crescent, Hampton.

This property comprises of;

Ground Floor- entrance hall, w/c, kitchen/diner, lounge with double doors to the garden.

First Floor- landing with airing cupboard, three bedrooms, en suite and two storage cupboards to bedroom one, family bathroom.

Outside- lawned and shrub frontage with parking, rear access, enclosed rear garden mainly laid to lawn and patio.

This property is within easy reach of all Hampton has to offer and major transport links.

Tenure: Freehold  
Council Tax Band: C







Ground Floor

Entrance Hall

W/C

Kitchen/Diner

16'4" max x 7'9" max (4.99m max x 2.38m max)

Lounge

15'0" x 11'0" (4.59m x 3.37m)



First Floor

Landing

Bedroom One

11'1" max x 9'11" max (3.38m max x 3.04m max)

En Suite

Bedroom Two

10'5" x 7'9" (3.20m x 2.38m)



Bedroom Three

7'1" x 7'0" (2.16m x 2.14m)

Family Bathroom





Floor Plan

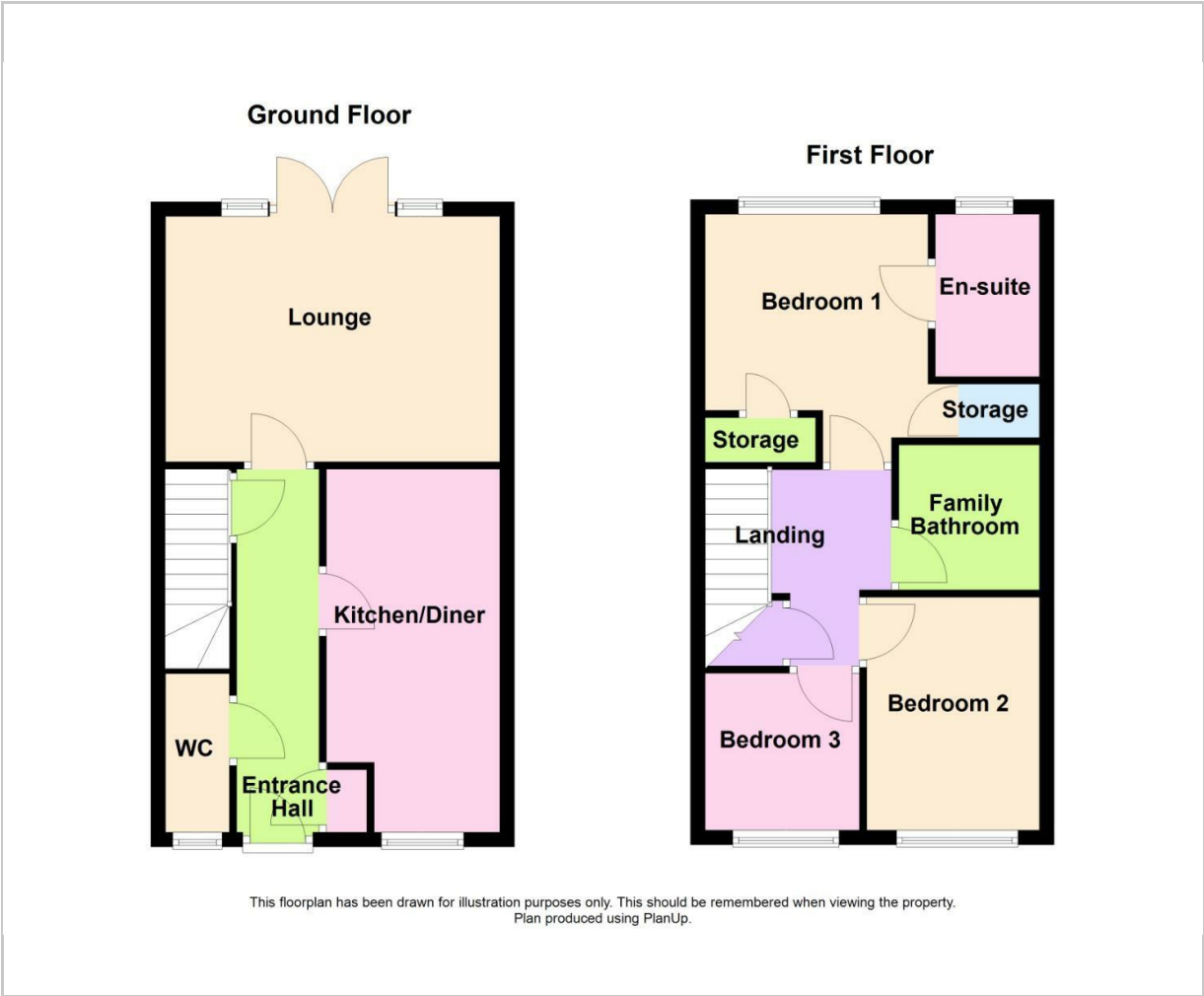

Area Map

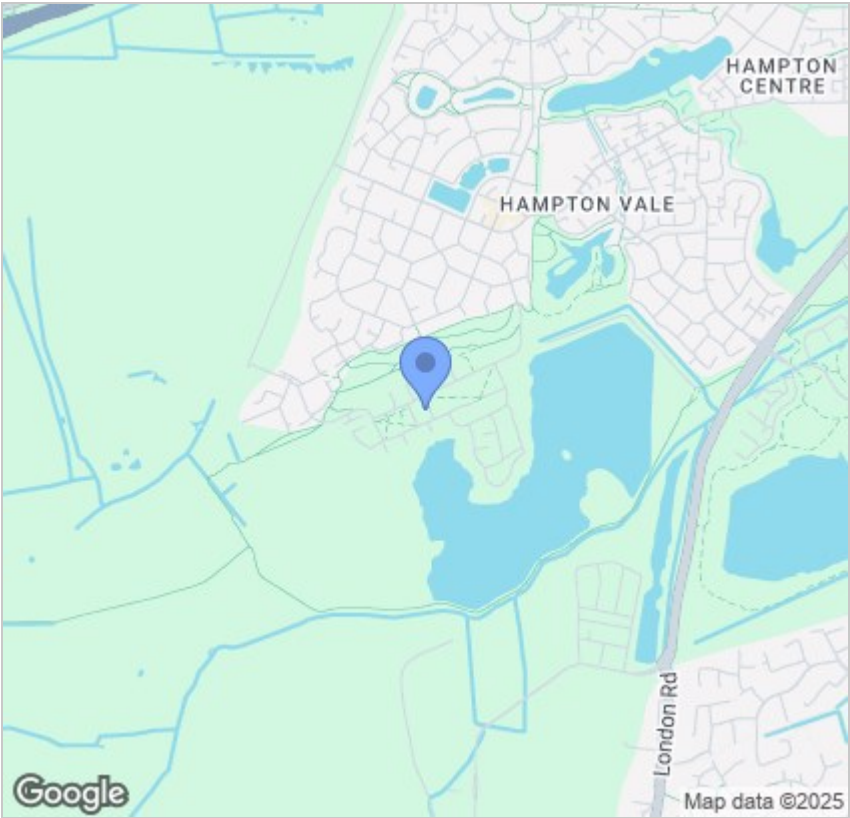

Energy Efficiency Graph

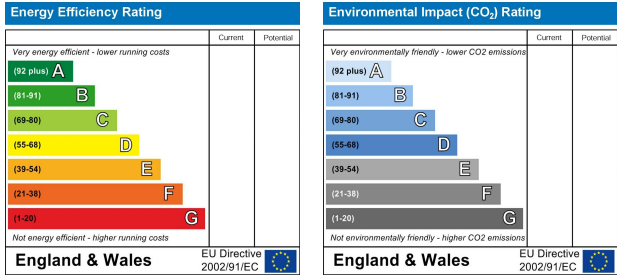

Viewing

Please contact our Orton Office on 01733 852257 if you wish to arrange a viewing appointment for this property or require further information.

These particulars, whilst believed to be accurate are set out as a general outline only for guidance and do not constitute any part of an offer or contract. Intending purchasers should not rely on them as statements of representation of fact, but must satisfy themselves by inspection or otherwise as to their accuracy. No person in this firms employment has the authority to make or give any representation or warranty in respect of the property.



48b Church Drive, Orton Waterville  
Peterborough, PE2 5HE  
T: 01733 852257  
E: orton@firminandco.co.uk