



42 North Green  
PE7 2BQ  
£260,000

## 42 North Green

PE7 2BQ

Being sold with NO ONWARD CHAIN, this detached Bungalow requires some updating and enjoys a quiet location close to the Village Green. With easy access to Whittlesey with its many amenities local facilities are only a short walk away.

The accommodation comprises; Entrance Hall, Good size Lounge, spacious Kitchen Diner, three Bedrooms, Shower Room and separate W.C.

Outside are gardens front and rear, a driveway and single Garage with an electric roller door.

The property has gas radiator heating and PVCu double glazing and viewing is recommended.

Council Tax C  
Tenure Freehold.





Entrance Hall

Lounge  
14'11" x 12'5" (4.56m x 3.79m)

Kitchen Diner  
14'11" x 10'10" (4.57m x 3.31m)

Bedroom 1  
10'11" x 10'4" min (3.35m x 3.16m min)  
Fitted mirror wardrobes

Bedroom 2  
13'5" x 10'3" (4.11m x 3.14m )

Bedroom 3 2.87m x 2.61m

Shower Room

Separate W.C.

Outside  
To the front of the property is a gravelled strip separate to the main front garden which is also laid to gravel. To the side of the property is a driveway leading to a single Garage with an electric roller door. The enclosed rear Garden is laid to lawn.



## Floor Plan

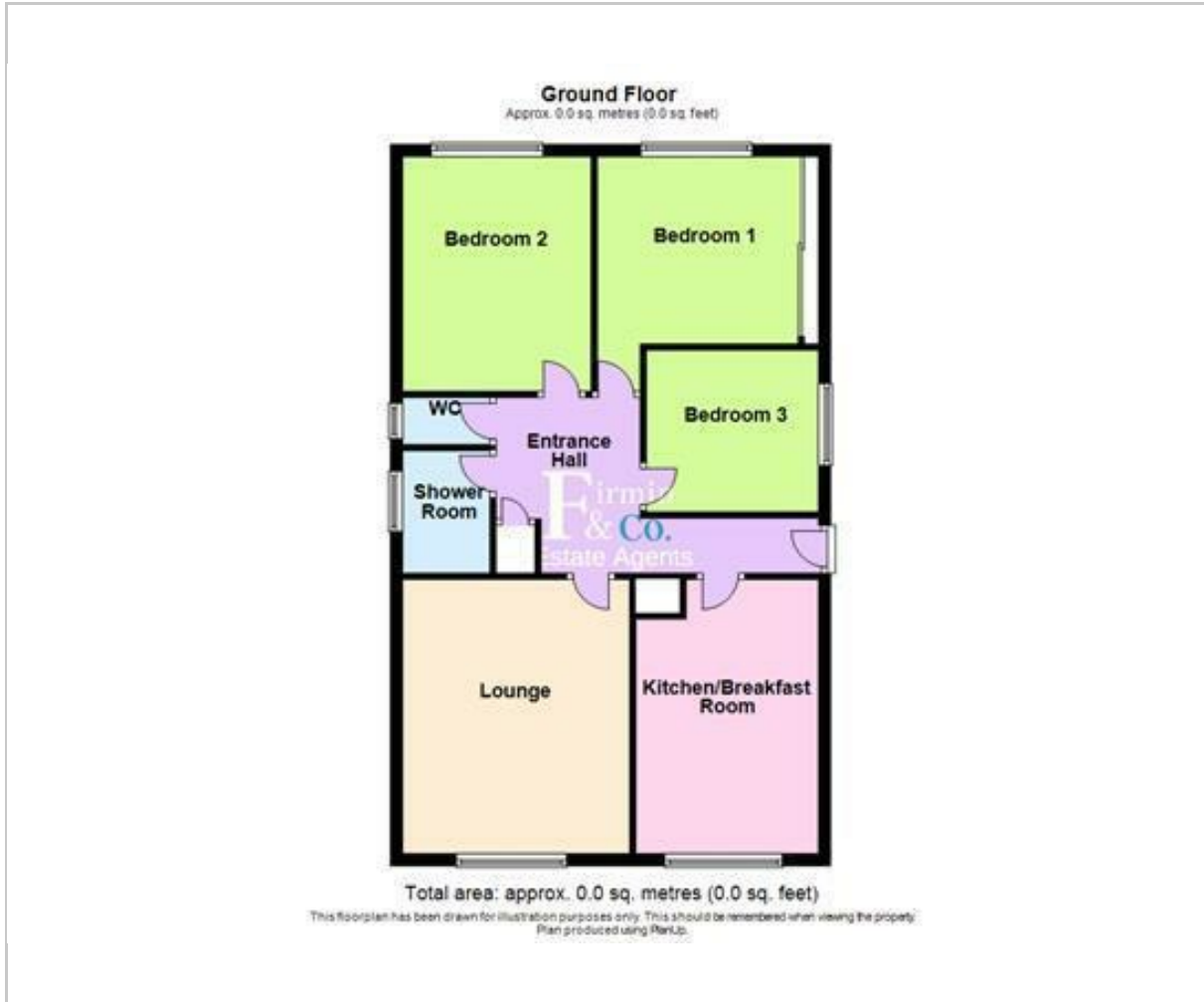

## Area Map



## Energy Efficiency Graph

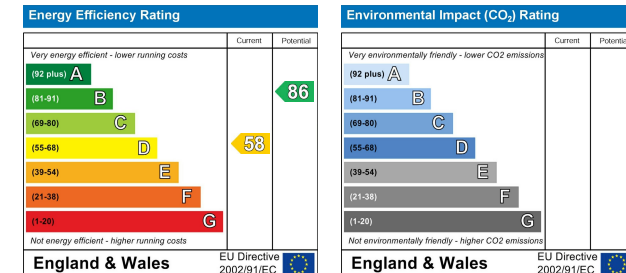

## Viewing

Please contact our Orton Office on 01733 852257 if you wish to arrange a viewing appointment for this property or require further information.

These particulars, whilst believed to be accurate are set out as a general outline only for guidance and do not constitute any part of an offer or contract. Intending purchasers should not rely on them as statements of representation of fact, but must satisfy themselves by inspection or otherwise as to their accuracy. No person in this firm's employment has the authority to make or give any representation or warranty in respect of the property.



48b Church Drive, Orton Waterville  
Peterborough, PE2 5HE  
T: 01733 852257  
E: orton@firminandco.co.uk