



Ludham Close, Ilford, IG6

BUTLER & STAG



**Guide Price £650,000 -
£675,000**

Nestled in the highly desirable Oakwood Gate development, this extended three double bedroom semi-detached house is a true gem.



Freehold

- Link Semi Detached Family Home
- Three Bedrooms/Two Bathrooms
- Stunning Throughout
- Modern Kitchen
- Master With En-Suite
- Off Street Parking

Situated in a peaceful cul-de-sac, the property offers a unique blend of spaciousness and contemporary living. Immaculately presented throughout, the home boasts a modern kitchen with a dining area that overlooks a low-maintenance rear garden.

Upstairs, you will find three generously sized double bedrooms, with the master bedroom benefiting from an en-suite bathroom.

This home is perfectly positioned for access to the beautiful green fields and walking tracks of Claybury Park, making it ideal for outdoor enthusiasts. Families will appreciate the proximity to sought-after schools, while commuters will benefit from the easy access to transport links, with Fairlop Underground Station within walking distance.

Properties in Oakwood Gate are highly sought after due to their modern design and well-maintained surroundings. This home is a perfect blend of comfort and convenience, making it a place anyone would be proud to call their own.





Ludham Close

Approx. Gross Internal Area 109.3 sq. metres (1177.0 sq. feet)

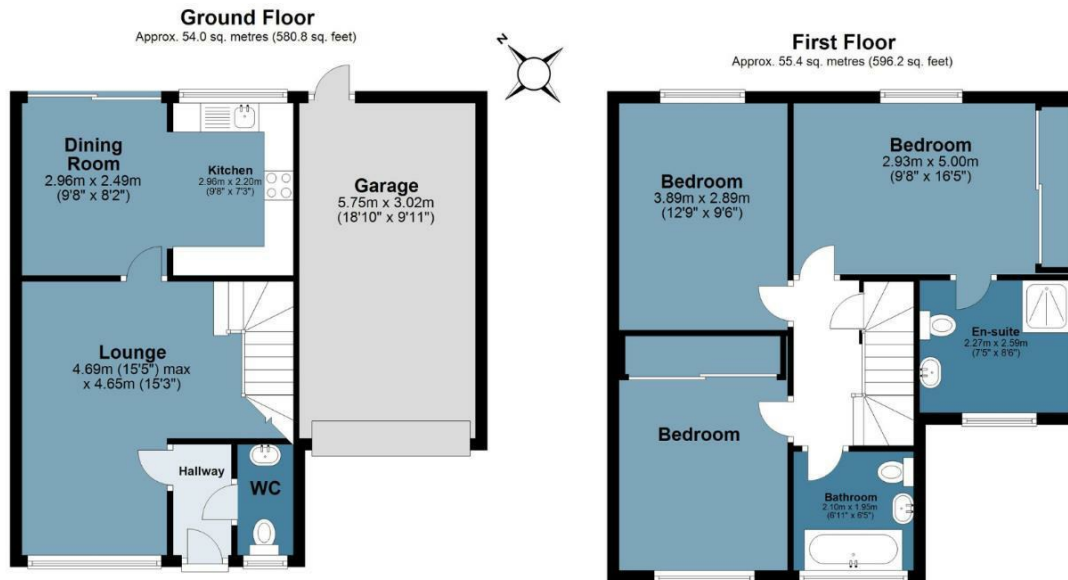

Measurements are approximate and for illustration purposes only. While we do not doubt the accuracy and completeness, we advise you conduct a careful independent assessment of the property to determine monetary value
© @modephoto.uk www.modephoto.co.uk



☎ 01992 667666

🏠 4 Forest Drive, Theydon Bois, Essex, CM16 7EY

✉ theydon@butlerandstag.com

www.butlerandstag.uk

IMPORTANT NOTICE - These particulars have been prepared in good faith and they are not intended to constitute part of an offer or contract. We have not performed a structural survey on this property and the services, appliances and specific fittings have not been tested. All photographs, measurements, floor plans and distances referred to are given as a guide and should not be relied upon.