

Storage: Colchester

Monthly £2,085

RAYLEIGH OFFICE

For further information or to arrange to view this property please call

01268 904389

To let we have a storage / warehouse unit in Great Tey, with great access to the A12 and A120.

DETAILS

DESCRIPTION

To let we have a storage / warehouse unit in Great Tey, with great access to the A12 and A120.

The unit has a concrete floor and a loading bay measuring 1,000 square feet. The site is secure with gated and CCTV.

The unit has high eave heights (8.89m) , which makes the unit ideal for racking etc. The unit also has a roller shutter door and a pedestrian door.

LOCATION

The storage unit is situated approximately 4.3 miles from Earls Colne, 2.6 miles from Marks Tey (A12 junction) and 4.5 miles away from Coggeshall within a secure business centre.

SIZE

The unit measures a total of 6,500 square feet which is divided between the main unit (5,500 sq ft) and the loading bay (1,000 sq ft).

6,500 square feet | **Â£2,085 per month**

SECURITY

The site has CCTV and electric security gates.

NON-DOMESTIC RATES

The tenant will be responsible for paying any business rates.

LEGAL

NOTICE

Whirledge & Nott does not have any authority to give representations or warranties in relation to the property. These particulars do not form part of any offer or contract. All descriptions, photographs and plans are for guidance only and should not be relied upon as statements or representations of fact. All measurements are approximate. No assumption should be made that the property has the necessary planning, building regulations or other consents. Whirledge & Nott has not carried out a survey nor tested any appliances, services or facilities. Purchasers must satisfy themselves by inspection or otherwise.

VIEWING

Strictly by appointment Viewing of the property is entirely at the risk of the enquirer. Neither Whirledge & Nott nor the vendor accept any responsibility for any damage, injury or accident during viewing.

**Whirledge
&Nott**

Land • Property • Development

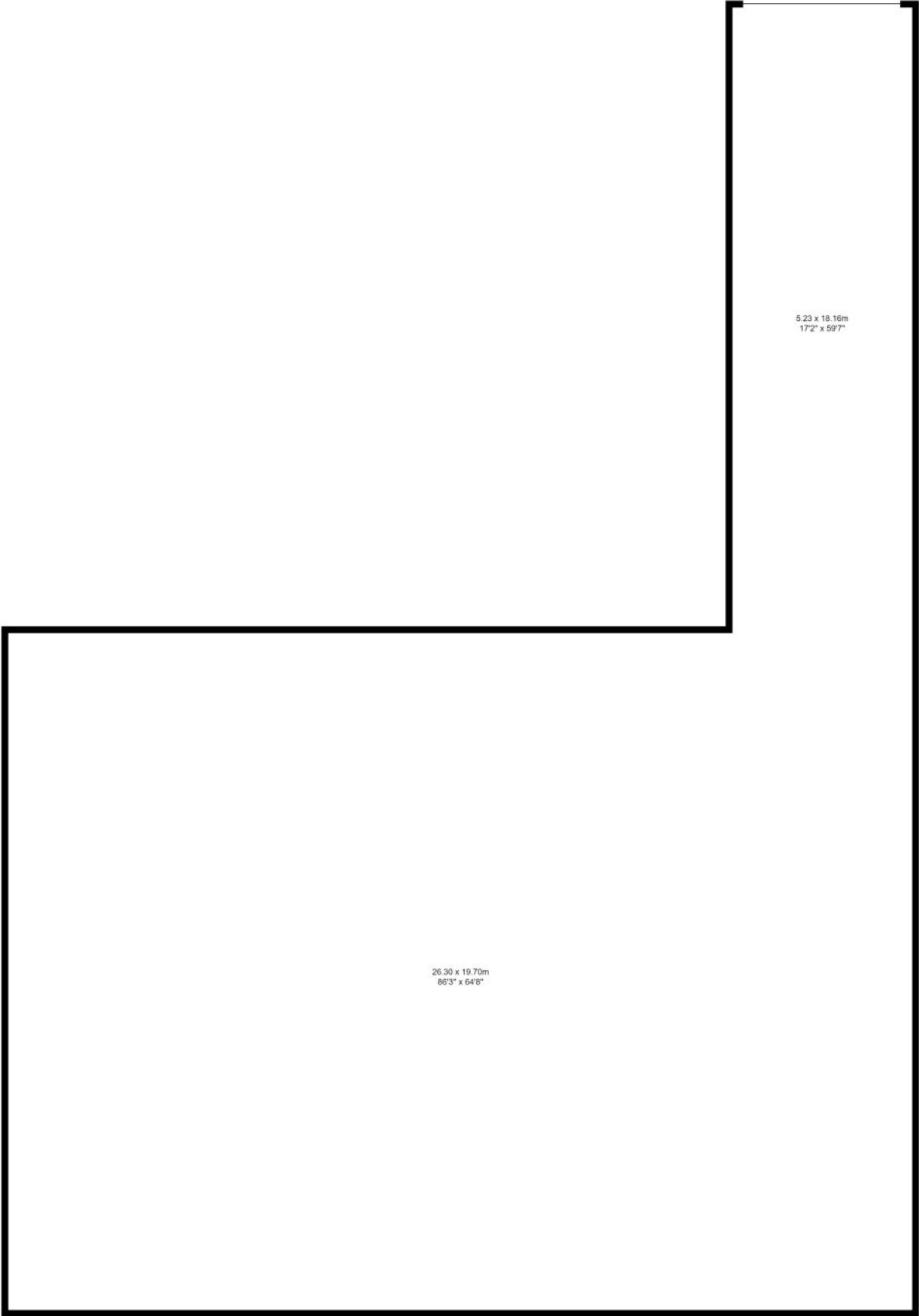

26.30 x 19.70m

86'3" x 64'8"

5.23 x 18.16m

17'2" x 59'7"

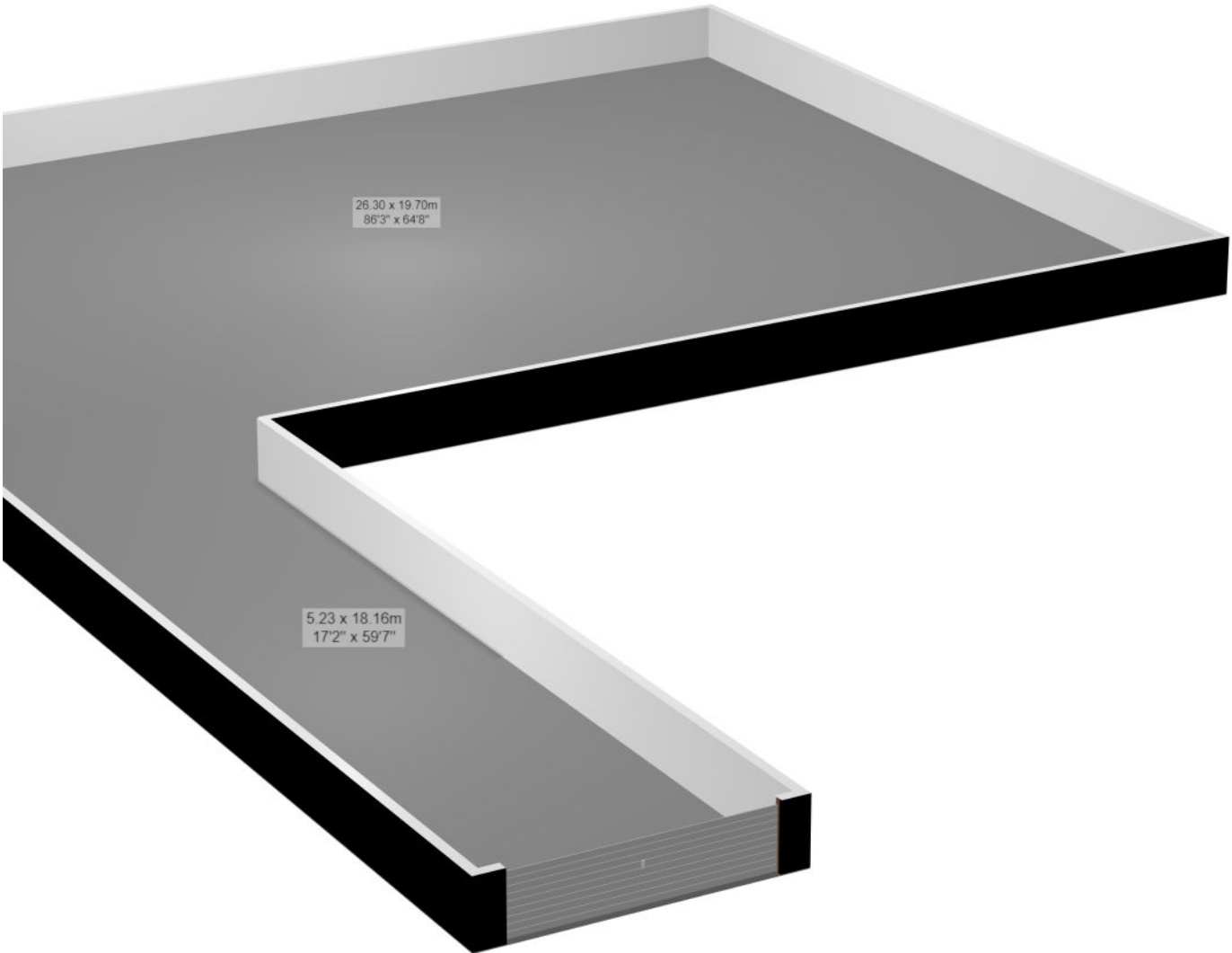

26.30 x 19.70m
86'3" x 64'8"

5.23 x 18.16m
17'2" x 59'7"