



FOSTER
CO.

Lansdowne Place

Hove, BN3 1FG

£1,200 Per month

Located on the sought after Lansdowne Place, just off of Western Road with it local shops and amenities, is this superb one bedroom ground floor flat which has been updated throughout.

The property has a large bedroom to the rear, bathroom off of the hallway and kitchen/ dining/ living room to the front with beautiful arched windows looking out. The flat has been recently updated and has a new kitchen with integrated appliances, newly fitted bathroom and redecoration throughout including new carpets.



- One Bedroom Flat
- Refurbished Bathroom
- New Kitchen with Integrated Appliances
- Unfurnished
- Refurbished
- Available now
- Long term

Energy Efficiency Rating	Current	Potential
Very energy efficient - lower running costs		
(92 plus) A		
(81-91) B		
(69-80) C		
(55-68) D		
(39-54) E		
(21-38) F		
(1-20) G		
Not energy efficient - higher running costs		
England & Wales	EU Directive 2002/91/EC	

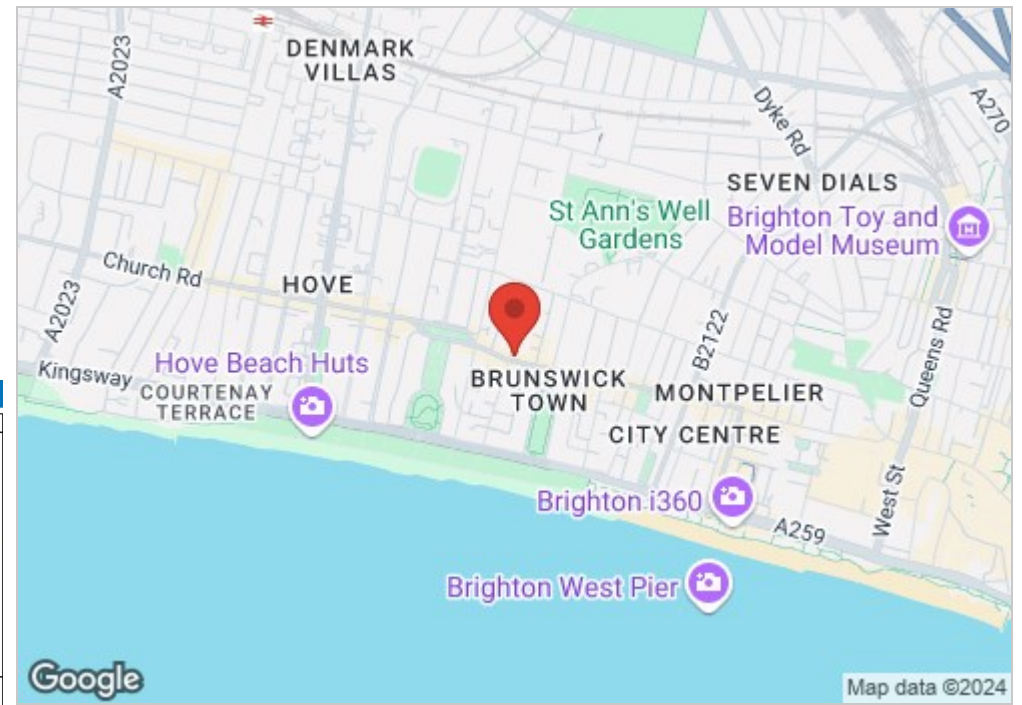

LANSDOWNE PLACE

Approximate Gross Internal Area = 44.61 sq m / 480.17 sq ft
Illustration for identification purposes only, measurements are approximate, not to scale.

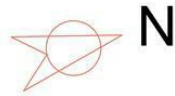
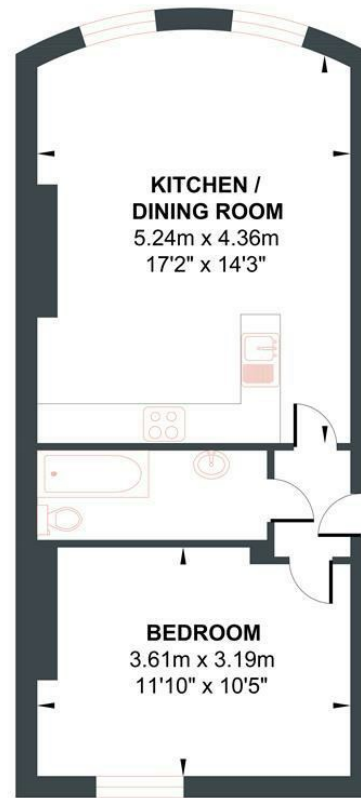

GROUND FLOOR

Approximate Floor Area
480.17 sq ft
(44.61 sq m)

Foster & Co and their clients give notice that:

These sales particulars do not constitute any part of an offer of contract and are for guidance for prospective purchases only and should be not relied upon as a statement of fact.

We are not to be held responsible for material information that has not been given to us by our client at the time of marketing.

All measurements are approximate



