



# Uckfield Road

Lewes, BN8 5RX

**£2,350 Per month**

This newly built three-bedroom semi-detached house, occupying an enviable location in a modern cul de sac. 3 good size bedrooms, dual aspect lounge dining room, modern fitted kitchen with integrated appliances, ground floor cloakroom and a particularly spacious family bathroom. This property has a larger than average plot with a good size garden. Two allocated parking spaces. Countryside views can be enjoyed from the property.

The Orchards is conveniently located around 2 miles North of Lewes just outside Ringmer.



- Available now
- Council tax band tbc
- Unfurnished
- Long term
- All electric heating
- Countryside Views
- Engineered Oak Flooring

Energy Efficiency Rating		Current	Potential
Very energy efficient - lower running costs			
(92 plus) A			
(81-91) B			
(69-80) C			
(55-68) D			
(39-54) E			
(21-38) F			
(1-20) G			
Not energy efficient - higher running costs			
England & Wales		EU Directive 2002/91/EC	

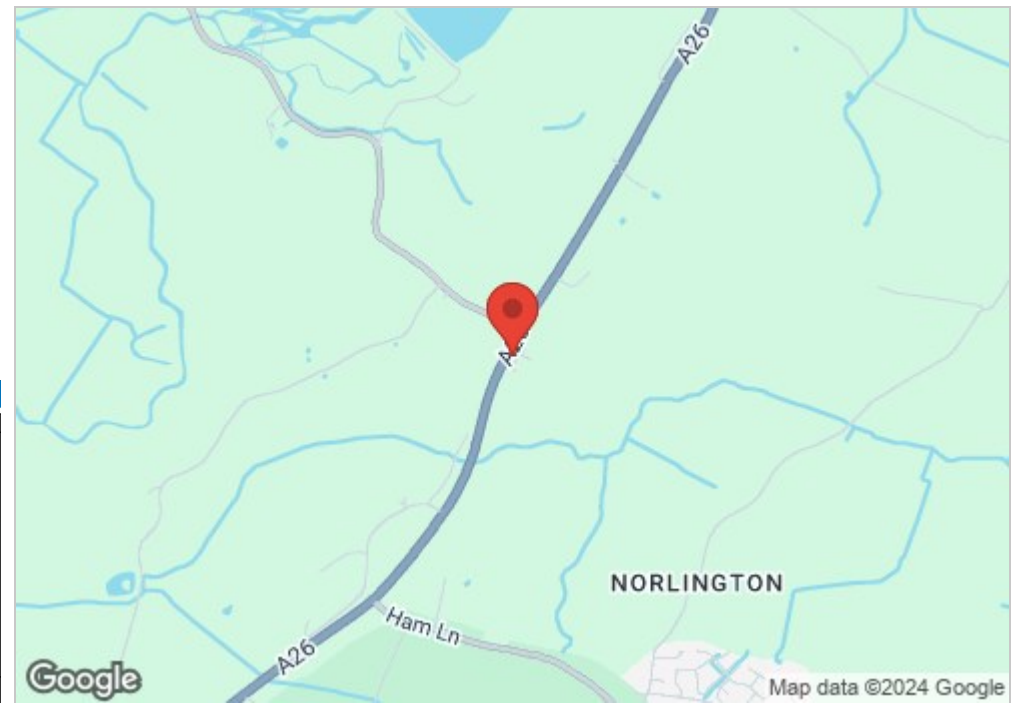

## THE ORCHARDS

Approximate Gross Internal Area = 80.96 sq m / 871.44 sq ft  
Illustration for identification purposes only, measurements are approximate, not to scale.

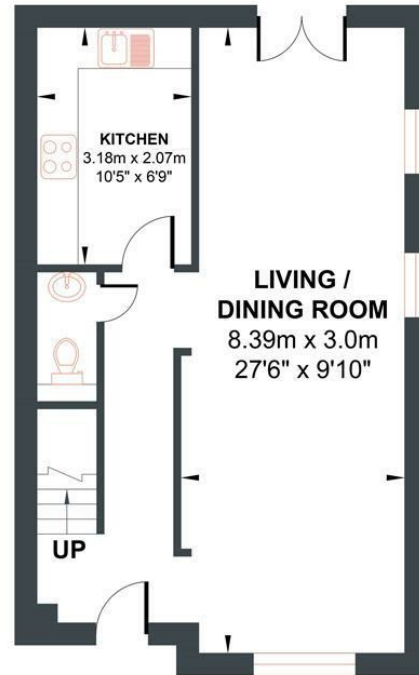

GROUND FLOOR

**Approximate Floor Area**  
435.72 sq ft  
(40.48 sq m)

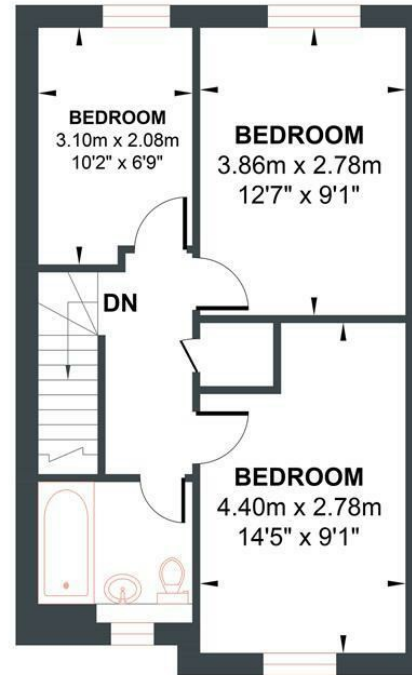

FIRST FLOOR

**Approximate Floor Area**  
435.72 sq ft  
(40.48 sq m)



