



54 Colbourne Road

Hove, BN3 1TB

Offers in excess of £800,000



- End Of Terrace
- Study
- Open Plan Kitchen
- Flat Rear Garden
- Close to Seven Dials
- 4 Bedrooms
- 3 Bathrooms
- Living Room
- Fantastic Location
- Recently Refurbished

Energy Efficiency Rating		
	Current	Potential
Very energy efficient - lower running costs		
(92 plus) A		82
(81-91) B		
(69-80) C		
(55-68) D		
(39-54) E	65	
(21-38) F		
(1-20) G		
Not energy efficient - higher running costs		
England & Wales	EU Directive 2002/91/EC	

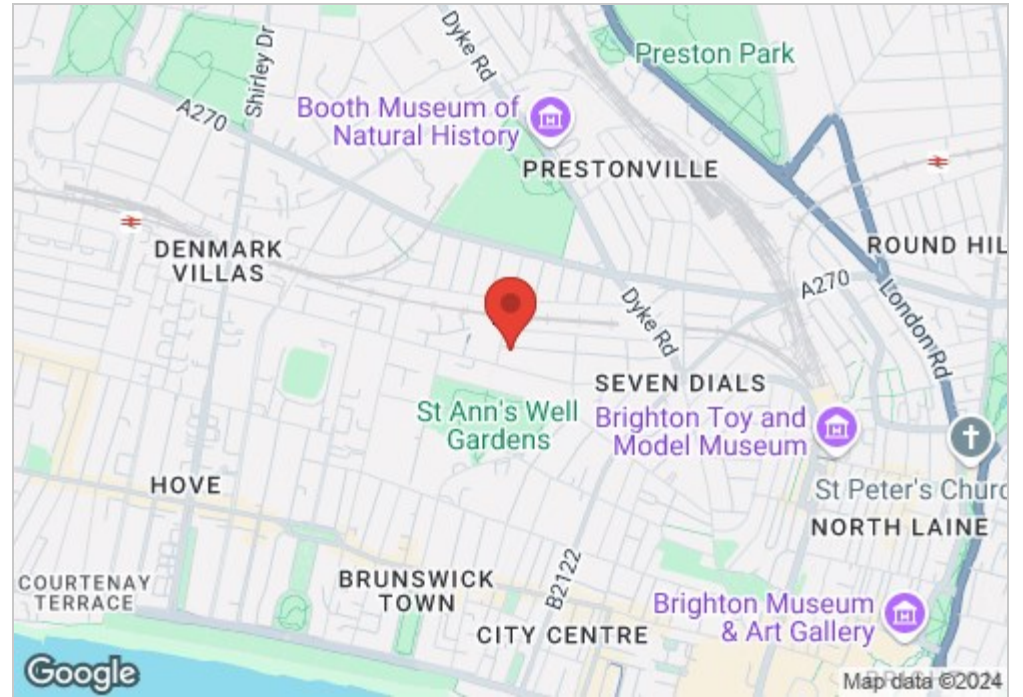

COLBOURNE ROAD

Approximate Gross Internal Area = 143.20 sq m / 1541.39 sq ft

Illustration for identification purposes only, measurements are approximate, not to scale.



LOWER GROUND FLOOR

Approximate Floor Area
391.80 sq ft
(36.40 sq m)

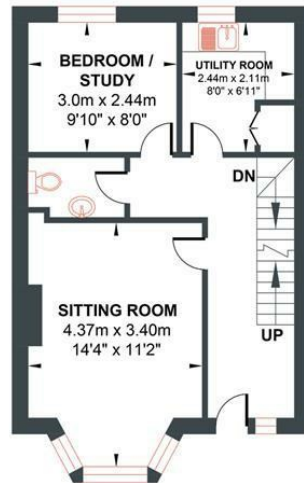

GROUND FLOOR

Approximate Floor Area
433.78 sq ft
(40.30 sq m)

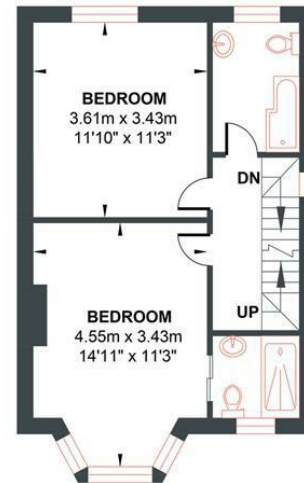

FIRST FLOOR

Approximate Floor Area
429.48 sq ft
(39.90 sq m)

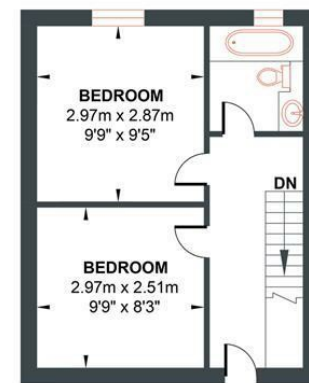

EAVES

SECOND FLOOR

Approximate Floor Area
286.32 sq ft
(26.60 sq m)

