



FOSTER
& CO.
R
CO.

Uckfield Road

Lewes, BN8 5RX

Guide price £475,000

This newly built three-bedroom semi-detached house, occupying an enviable location in a modern cul de sac. Number 1A has 3 good size bedrooms, dual aspect lounge dining room, modern fitted kitchen with integrated appliances, ground floor cloakroom and a particularly spacious family bathroom. This property has a larger than average plot with a good size garden. Two allocated parking spaces. Countryside views can be enjoyed from the property. The Orchards is conveniently located around 2 miles North of Lewes just outside Ringmer.



- Semi-Detached House
- 27ft Lounge/Dining Room
- Cul de sac
- Samsung Appliances
- Solar Panels
- 3 Bedrooms
- Modern Fitted Kitchen
- Countryside Views
- Engineered Oak Flooring
- All Electric Heating

Energy Efficiency Rating		Current	Potential
Very energy efficient - lower running costs			
(92 plus)	A		
(81-91)	B		
(69-80)	C		
(55-68)	D		
(39-54)	E		
(21-38)	F		
(1-20)	G		
Not energy efficient - higher running costs			
England & Wales		EU Directive 2002/91/EC	

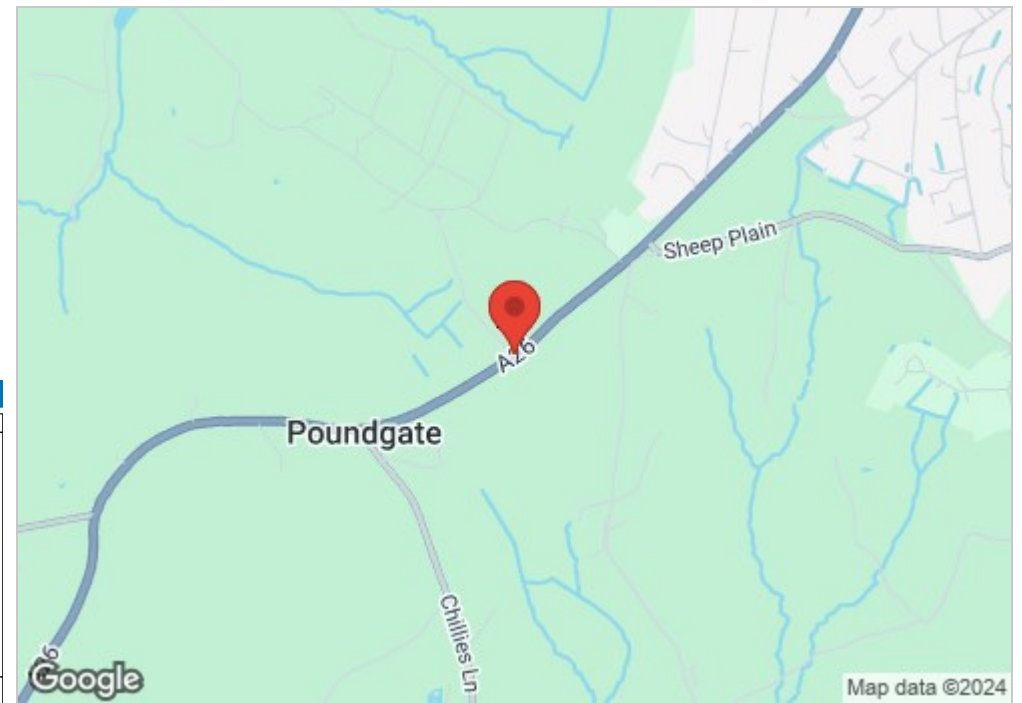

THE ORCHARDS

Approximate Gross Internal Area = 80.96 sq m / 871.44 sq ft
Illustration for identification purposes only, measurements are approximate, not to scale.

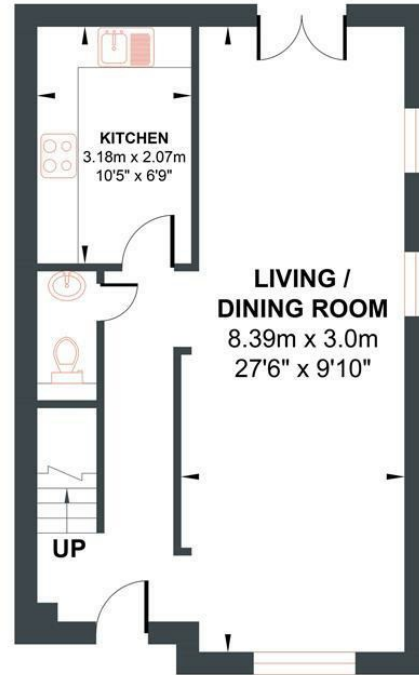

GROUND FLOOR

Approximate Floor Area
435.72 sq ft
(40.48 sq m)

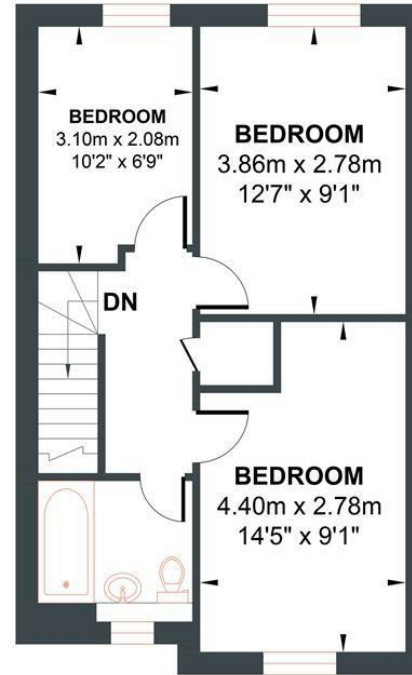

FIRST FLOOR

Approximate Floor Area
435.72 sq ft
(40.48 sq m)



