



168 Whitefield Terrace

Heaton



SANDERSON
YOUNG



168 Whitefield Terrace Heaton

Stylish Lower 'Tyneside' Apartment with Generous Principal Bedroom, Private Rear Courtyard, Detached Garage & Offered to the Market with No Onward Chain!

This larger style ground floor 'Tyneside' flat is ideally located on Whitefield Terrace, Heaton.

Situated on the corner of Whitefield Terrace and Sackville Road, with spacious internal accommodation, the apartment is well placed to provide easy access to Chillingham Rad with its shops, cafes and restaurants. The apartment is also located close to Chillingham Road metro station offering excellent transport links throughout the region.

Price Guide:

Offers Over £160,000





The internal accommodation comprises: Entrance hallway with downstairs store cupboard | Lounge/diner | Kitchen with tiled flooring and access to the rear courtyard | Bathroom with three piece suite | Large principal bedroom with walk in bay window | Bedroom two is a further double with window overlooking the rear courtyard. Externally, the property benefits from an extra wide private rear courtyard with a store and detached single garage.



Harriet Scott
0191 213 0033
harriet.scott@sandersonyoung.co.uk



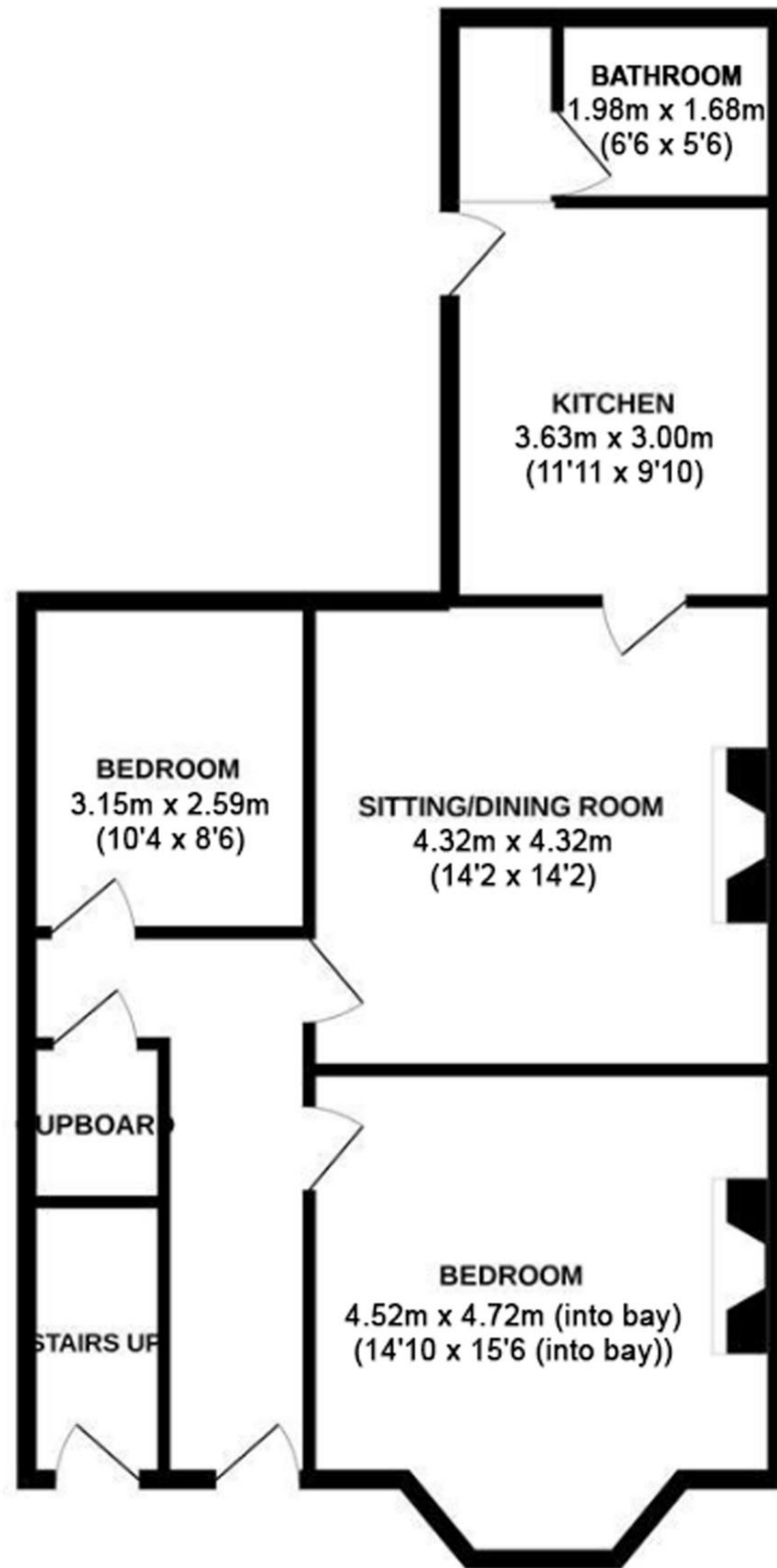

Well presented throughout, with gas 'Combi' central heating and double-glazed windows, this great apartment is ideal for young professionals, first time buyers or investors.

The property is currently being rented out at £1000 pcm with the current tenancy ending 30th June 2024.

Services: Mains gas, electric, water and drainage |
Tenure: Leasehold | Council Tax: Band A | Energy
Performance Certificate: Rating C