



16 Hemingway Court

Thornhill Road, Ponteland



SANDERSON
YOUNG





16 Hemingway Court Thornhill Road, Ponteland

A stylish 'Lewis' style, two bedroom apartment with fantastic private balcony overlooking 'The Blackbird' towards the Church and village - located on the first floor of Hemingway Court, a modern development in the centre of Ponteland village, with attractive communal gardens and allocated parking .

The impressive apartment, built by Ascent Homes in 2019, is one of only three of this style in the development with a large private balcony area/outside space and is ideal for a number of buyers including young professionals, downsizers/retired and investors seeking a property for rental.

Hemingway Court is ideally placed in the centre of Ponteland village, only minutes walk from the local shops/supermarkets, cafes, and pubs/restaurants, as well as excellent public transport links to Newcastle city centre and Newcastle International Airport.

Price Guide:

Guide Price £285,000

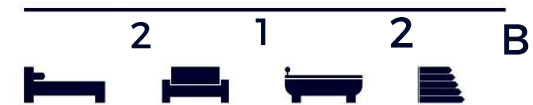

Secure communal entrance | Lift and stair access | Hallway with large storage cupboard | Fabulous open plan kitchen/living room with double doors opening to the private balcony | Contemporary fitted kitchen with integrated appliances; oven, induction hob and hood, fridge/freezer, and washer/dryer.

Master bedroom with double doors opening to the balcony | Well appointed ensuite shower room/wc | Double Bedroom two, currently used as a home office | Bathroom/wc with bath with shower over | Well maintained communal grounds | Allocated parking space & Visitor parking | Approx. 75 sq/m - 805 sq/ft

Services: Mains electric, gas, water and drainage | Tenure: Leasehold | Council Tax: Band D | Energy Performance Certificate: Rating B



Julie Douglas
0191 213 0033
julie.douglas@sandersonyoung.co.uk



CHAPTER TWO - APARTMENTS

THE LEWIS

2 BEDROOMS | APARTMENTS 6, 16 & 24 | 76.0 M² | 818 FT²

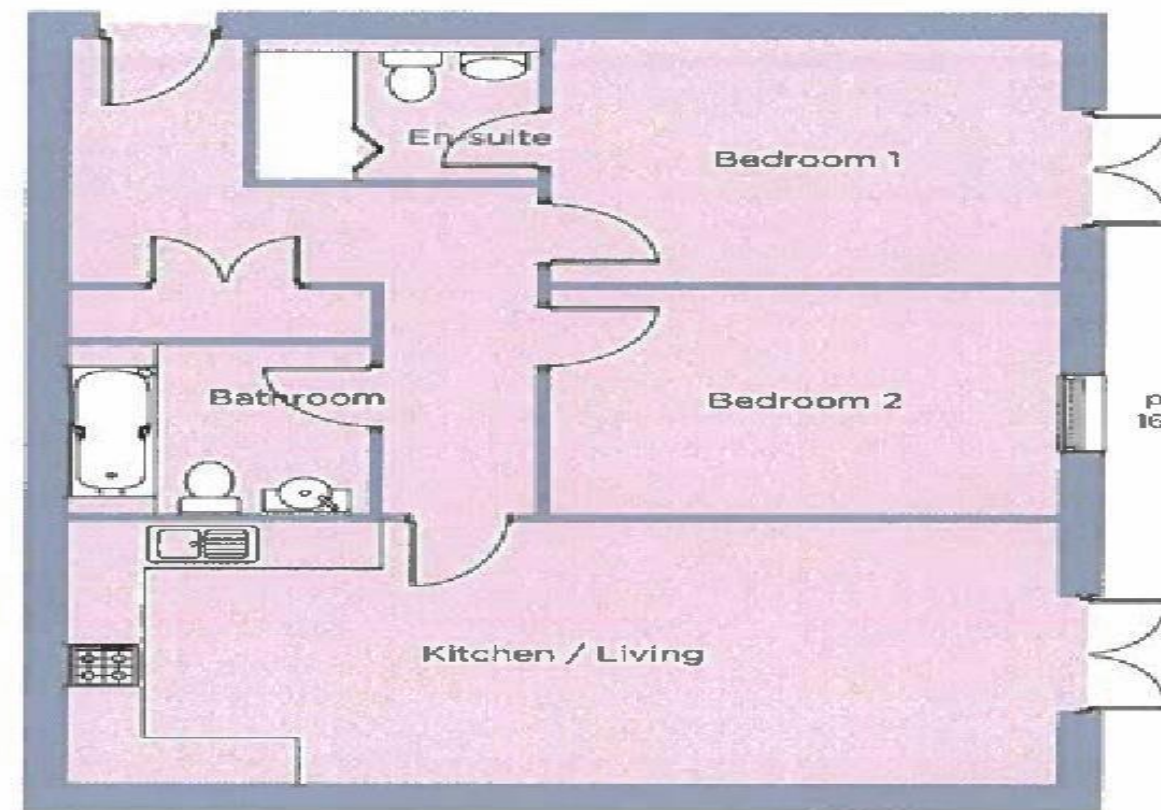

Apartment 6 has a patio and apartments 16 & 24 have a balcony

| Ground | Metric (m) | Imperial |
|------------------|-------------|---------------|
| Kitchen / Living | 3.52 x 7.78 | 11'6" x 25'6" |
| Bathroom | 2.18 x 2.42 | 7'2" x 7'11" |
| Bedroom 1 | 3.19 x 3.97 | 10'6" x 13'0" |
| En-suite | 1.89 x 2.25 | 6'3" x 7'5" |
| Bedroom 2 | 2.88 x 3.97 | 9'5" x 13'0" |

Please note all dimensions are subject to slight modifications and all dimensions are MAXIMUM. Whilst every effort has been made to ensure that the information contained in this brochure is correct, it is designed specifically as a guide and Ascent Homes reserves the right to amend the specification as necessary and without notice. This does not constitute or form any part of a contract of sale. June 2018.

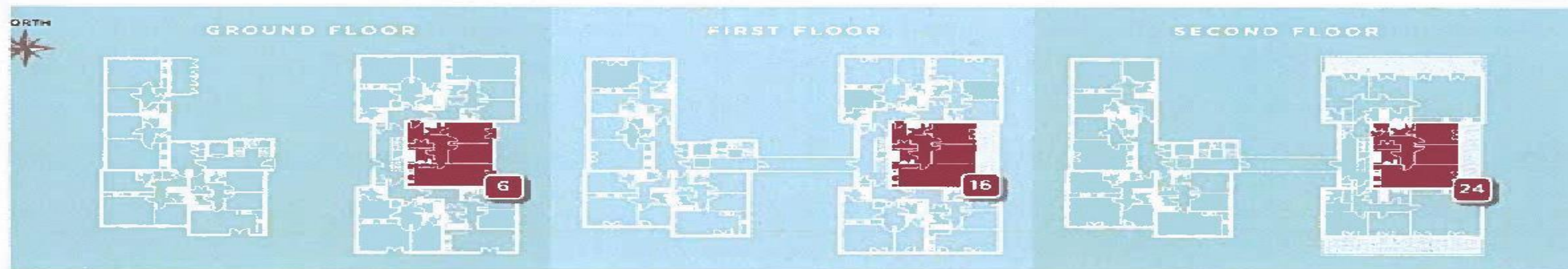

SIXTEEN HEMINGWAY COURT

