



43 Henderson Court

North Road, Ponteland



SANDERSON
YOUNG



**43 Henderson Court
North Road, Ponteland, NE20 9GY**

A lovely and well presented apartment located on the second floor of this popular retirement development, with lovely views to the front over the landscaped communal gardens.

The apartment has had new carpets fitted in the hallway and bedroom, and has attractive neutral decor throughout.

Henderson Court is a superb, assisted living development for the over 70's, completed in 2013, and featuring 24 hour, 365 days a year on site staffing, personal care packages, table service restaurant and excellent resident facilities.

Price Guide:

Guide Price £155,000





The development, located in the heart of Ponteland village, has attractive landscaped communal gardens, residents and visitor parking.

Secure Communal entrance | Lift and stair access to the second (top) floor | Private entrance Hallway with large storage cupboard | Open plan Living/dining room with views over the gardens to the entrance | Fully fitted kitchen with integrated double oven and Fridge/freezer | Double bedroom with sliding door fitted wardrobes | Bathroom with wet room shower and separate bath | No upward chain.

Services: Mains electric, water, and drainage | Tenure: Leasehold | Council Tax: Band D | EPC: C



Julie Douglas
0191 213 0033
julie.douglas@sandersonyoung.co.uk



43 Henderson Court

North Road, Ponteland

Gr

Ground Floor

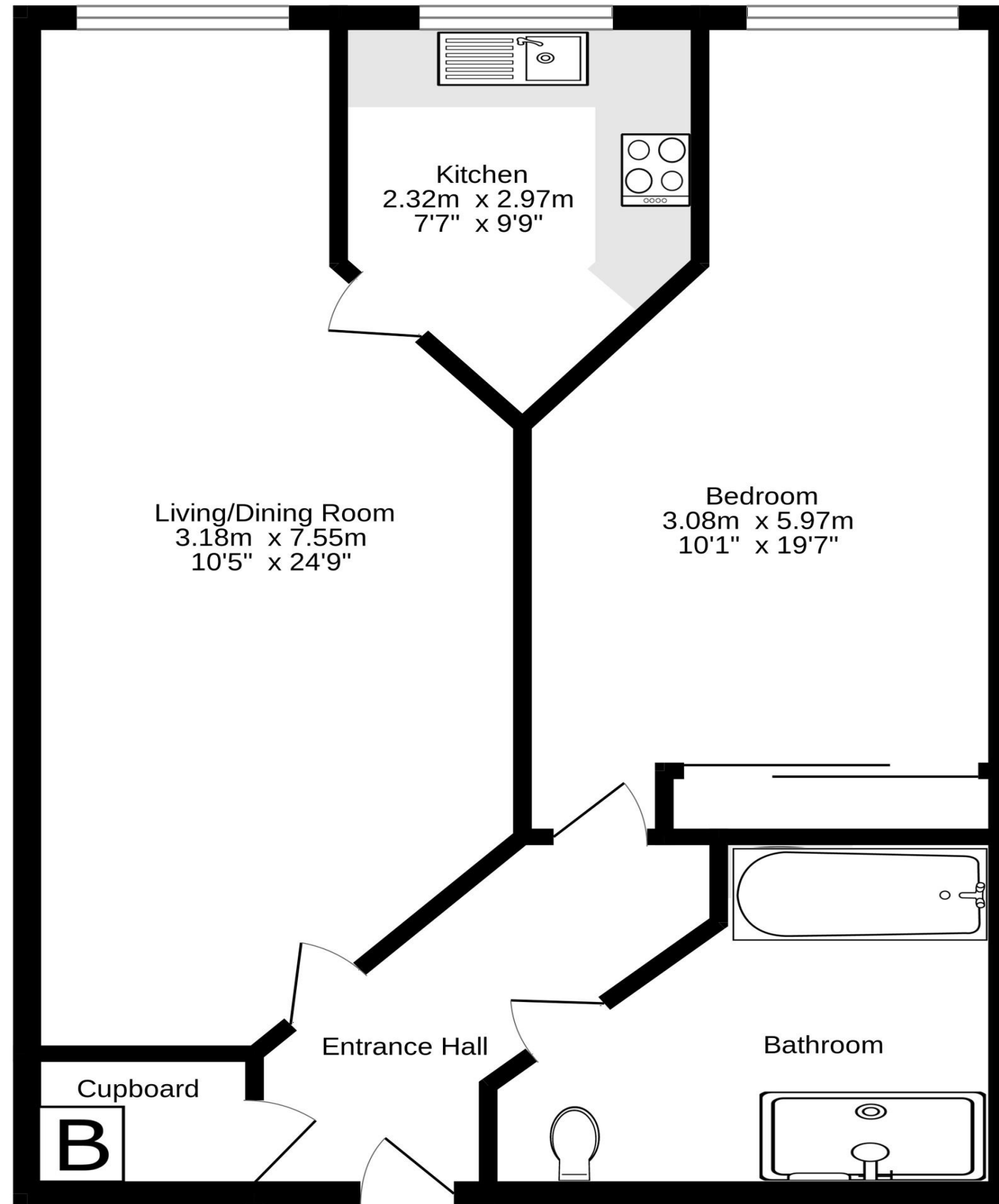
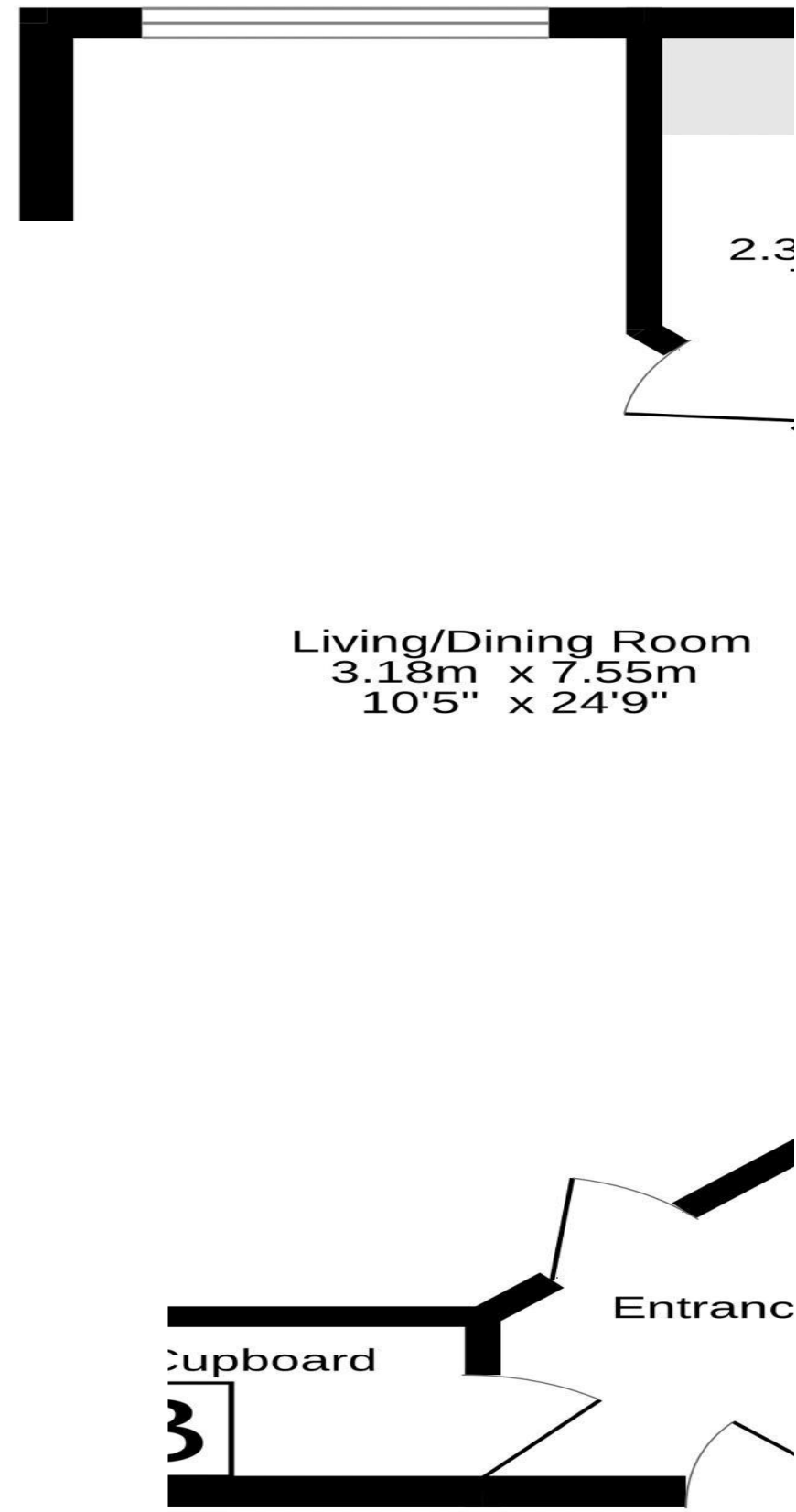

Henderson Court

Whilst every attempt has been made to ensure the accuracy of the floorplan contained here, measurements of doors, windows, rooms and any other items are approximate and no responsibility is taken for any error, omission or mis-statement. This plan is for illustrative purposes only and should be used as such by any prospective purchaser. The services, systems and appliances shown have not been tested and no guarantee as to their operability or efficiency can be given.
Made with Metropix ©2023