



- A well-presented detached bungalow occupying a large private plot measuring overall just under 1/4 acre
- Lounge with doors opening into a conservatory, gas central heating
- Fitted kitchen with door opening into a dining room enjoying patio doors onto the garden
- Three bedrooms, master bedroom ensuite shower room, family bathroom
- Two car private drive leading to the side garage which has power and lighting
- Further parking for two vehicles, large, private grounds backing onto mature woodland



"A modern detached bungalow which occupies a large private plot measuring just under 1/4 acre with a mature wooded backdrop".

Competitively priced and offered for sale with no onward chain!

This well-maintained property is presented in good decorative order. The accommodation comprises an entrance hallway, lounge with doors opening into a conservatory. Fitted kitchen with a door opening into the dining room which has patio doors onto the rear garden. There are three bedrooms, the master bedroom boasts an ensuite shower room. Family bathroom. Gas central heating and double glazing.

Outside to front is a private driveway which leads to the side garage. To the rear is a large fully enclosed garden which adjoins mature woodland. There is additional parking to the left of the property for two cars side by side.

**Tenure:** Freehold. **Council Tax Band:** D.





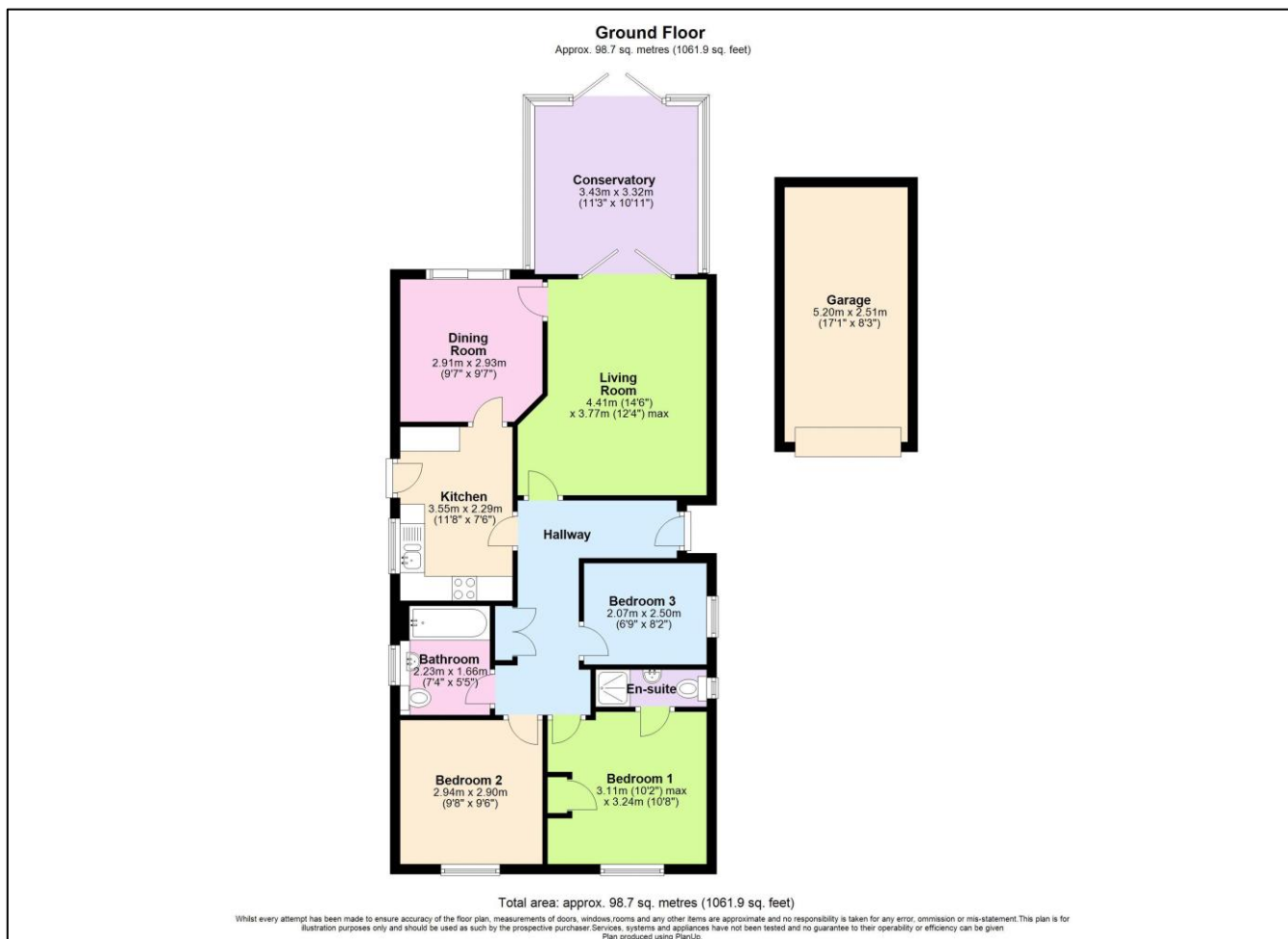

Find us online!



[www.samchiversproperty.co.uk](http://www.samchiversproperty.co.uk)



Facebook: Sam Chivers Estate Agents



Instagram: @samchiversestateagents

**rightmove**  **Zoopla**

Score	Energy rating	Current	Potential
92+	A		
81-91	B		82 B
69-80	C		
55-68	D	67 D	
39-54	E		
21-38	F		
1-20	G		

Sam Chivers Estate Agents can also provide mortgage and conveyancing recommendations should you require such a service. Please contact our office on:

01761 411020 or email us at [sales@samchiversproperty.co.uk](mailto:sales@samchiversproperty.co.uk)

These sales particulars provide an approximate guide and form no part of a contract. It is the purchaser's responsibility to satisfy themselves that the property has been accurately described and that all fixtures and apparatus are functioning correctly. Your home may be at risk if you do not keep up repayments secured against it.