



- An extended semi-detached house offered for sale with no onward chain
- Light and airy lounge. Handy ground floor cloakroom
- Feature kitchen dining room and separate utility area
- Three bedrooms and shower room on the first floor
- Fully enclosed west facing garden to rear
- Garage is a separate block adjacent



"An extended semi-detached home boasting a spacious kitchen dining room with doors opening onto a West facing garden".

The property is offered with no onward chain and is ready for occupation. The accommodation comprises entrance porch, light and airy lounge, feature kitchen dining room with ample space for a family dining table, utility area and w.c. On the first floor there are three bedrooms and professionally fitted wet room (originally a bathroom). Mains gas central heating and double glazing. Outside to front is a low-level gravelled garden, gated pathway to side leads into a fully enclosed, west facing low maintenance garden. Fully enclosed and level.

There is a garage is a detached block adjacent to the property, parking in front of the garage.

Tenure: Freehold. Council Tax Band: C.



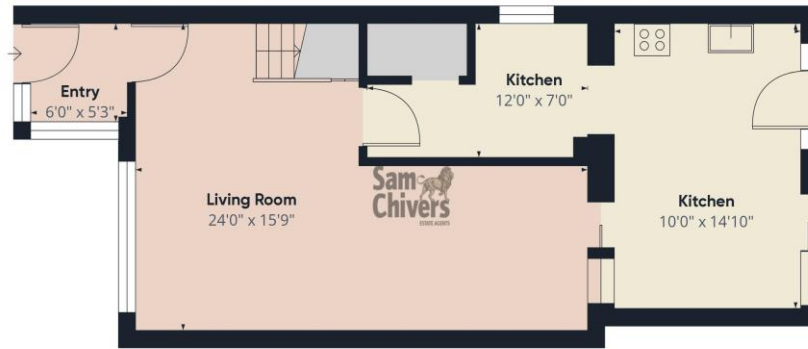

Floor 0

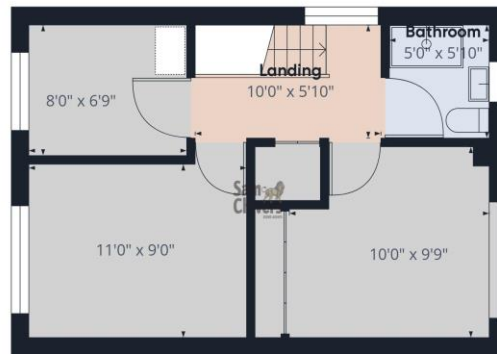

Floor 1

Approximate total area¹⁾
919.67 ft²

(1) Excluding balconies and terraces

While every attempt has been made to ensure accuracy, all measurements are approximate, not to scale. This floor plan is for illustrative purposes only.

GIRAFFE360

Find us online!



www.samchiversproperty.co.uk



Facebook: Sam Chivers Estate Agents



Instagram: @samchiversestateagents

rightmove  Zoopla

Sam Chivers Estate Agents can also provide mortgage and conveyancing recommendations should you require such a service. Please contact our office on:

01761 411020 or email us at sales@samchiversproperty.co.uk

These sales particulars provide an approximate guide and form no part of a contract. It is the purchaser's responsibility to satisfy themselves that the property has been accurately described and that all fixtures and apparatus are functioning correctly. Your home may be at risk if you do not keep up repayments secured against it.