



- A large four bedroom detached family home
- Separate one bedroom annexe alongside the main home
- Three spacious reception rooms on the ground floor
- Private, south facing garden with BBQ hut
- Parking for multiple cars to the front of the property
- Great location for access to the Greenway



'There is so much space on offer with the extended detached home which also has a self contained one bedroom annexe alongside the main home itself, perfect for a dependant relative or someone just needing their own space!'

This especially large four bedroom detached home offers more than meets the eye as it has a spacious main detached home with a self contained one bedroom annexe to the side with its own separate entrance. Upon entering the front door, there is a welcoming hallway with stairs to the first floor and a handy ground floor wc. The lounge is located towards the rear of the property and leads into a light and bright conservatory which overlooks the garden. The property enjoys a large dining room and separate home office/ground floor bedroom as well as a fitted kitchen/breakfast room with an extended utility room. On the first floor there are four bedrooms with the largest enjoying an en suite shower room and there is a first floor main family bathroom. Alongside the property there is a one-bedroom annexe with accommodation over two floors. Upon entering there is a pleasant size lounge and compact kitchen and to the first floor a double bedroom and shower room. This would make the perfect space for a dependant relative or family member needing their own space. The property also has GCH and double glazing. The front of the property provides parking for several vehicles side by side and has a side access gate. At the rear there is a South facing garden with a very private feel which is laid to patio and a level lawn. There is also a BBQ hut perfect for entertaining and a timber garden shed.

Thicket Mead is a convenient location just a supermarket just a five minute level walk, regular public transport can also be accessed from Tesco also. Midsomer Norton greenway is only a matter of minutes walk which in turn provides pleasant and safe rural walks. Bath city centre is twelve miles and Bristol is fourteen miles.



Thicket Mead, Msn

Approximate Gross Internal Area
1908 sq ft - 177 sq m

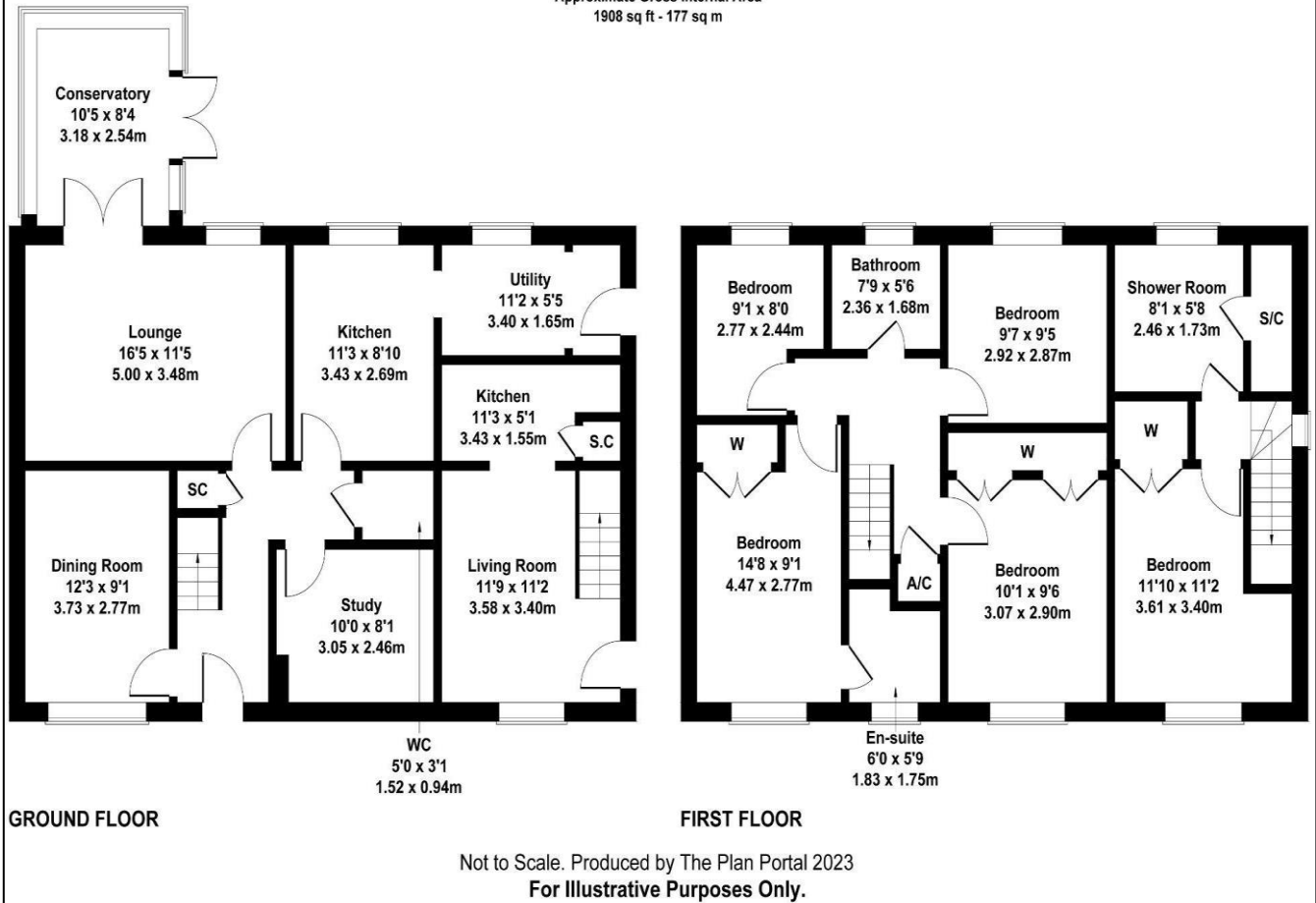

Find us online!



www.samchiversproperty.co.uk



Facebook: Sam Chivers Estate Agents



Instagram: @samchiversestateagents

rightmove Zoopla

Score	Energy rating	Current	Potential
92+	A		
81-91	B		83 B
69-80	C	70 C	
55-68	D		
39-54	E		
21-38	F		
1-20	G		

Sam Chivers Estate Agents can also provide mortgage and conveyancing recommendations should you require such a service. Please contact our office on:

01761 411020 or email us at sales@samchiversproperty.co.uk

These sales particulars provide an approximate guide and form no part of a contract. It is the purchaser's responsibility to satisfy themselves that the property has been accurately described and that all fixtures and apparatus are functioning correctly. Your home may be at risk if you do not keep up repayments secured against it.