

TO LET

Northallerton's New Shopping Mews

2 RETAIL KIOSKS

AVAILABLE
NOW

REGENCY MEWS, HIGH STREET, NORTHALLERTON DL7 8PE



CAN BE USED FOR: PHONES, CLOTHING, ICE CREAMS, COSMETICS, JEWELLERY, CIGARETTES, NEWSPAPERS, SWEETS, ACCESSORIES, E CIGARETTES AND LOTS, LOTS MORE

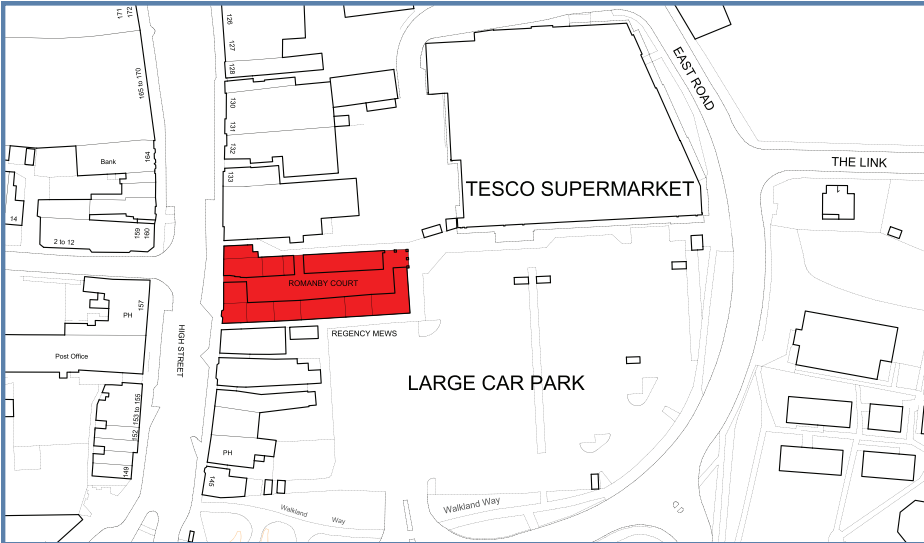

EPC

Upon completion.

Business Rates

Interested parties are advised to contact the Local Authority to make their own enquiries.

VIEWING

Mandale

Joe Darragh

T: 07973 908 599

E: joe@mandale.com

CPNE

Andrew Wilkinson

T: 07904 622277

E: andrew@cpne.co.uk

Plot No.	Rent
Kiosk 1	£250.00 + VAT per calendar month
Kiosk 2	£250.00 + VAT per calendar month
Kiosk 3	LET

LOCATION

Northallerton is a market town situated in North Yorkshire, England with a population of approximately 20,000. The long High Street provides a wide variety of shops, restaurants, pubs and cafes. There are national retailers such as Costa Coffee, Pizza Express, New Look, Fat Face, Wilkinson's, Waterstones, Vodafone and Claire's alongside local independent or regional retailers such as the famous Betty's tearooms, Lewis & Cooper and Barker's Department Store.

The properties are situated in a popular part of the town and form part of small shopping parade which leads to a Tesco Superstore and a large free car park.

DESCRIPTION

The kiosks have been designed and constructed to a very high standard. We have included a power supply, water and drainage. They are suitable for many kind of uses, including: phones, clothing, ice creams, cosmetic jewellery, newspapers, sweets, accessories and lots, lots more.

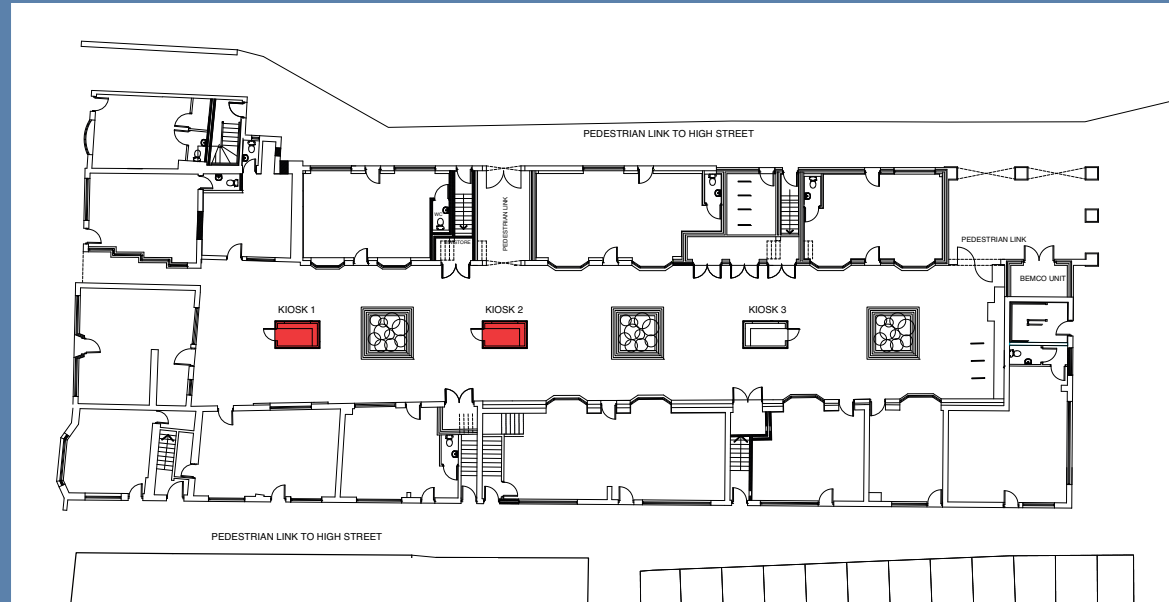

Mandale
Group

01642 605 514

CONNECT
PROPERTY

01642 602001

www.cpne.co.uk

IMPORTANT NOTICE: These details were compiled July 2021 and whilst every reasonable effort has been made by The Mandale Group to ensure accuracy, interested parties are strongly advised to take appropriate steps to verify by independent inspection or enquiry all information for themselves and to take appropriate professional advice. (i) No description or information given about the property or its value, whether written or verbal or whether or not in these particulars ('information') may be relied upon as a statement of representation or fact. The Mandale Group nor their Agents have any authority to make any representation and accordingly any information given is entirely without responsibility on the part of The Mandale Group or the seller / lessor. (ii) Any photographs show only certain parts of the property at the time they were taken. Any areas, measurements or distances given are approximate only. (iii) Any reference to alterations to, or use of any part of the property is not a statement that any necessary planning, building regulations or other consent has been obtained. These matters must be verified by any intending buyer / lessee. (iv) Any buyer, lessee must satisfy himself by inspection or otherwise as to the correctness of any information given.

Designed and produced by Architype | 07793 764 767 | architypecreative.com | Ref: 0856