



**Connells**

Watersmeet  
St. Marys Island Chatham



# Watersmeet St. Marys Island Chatham ME4 3HD

For Sale  
**£190,000**



## Property Description

Two bedroom apartment now available to view. This great property has two double bedrooms and ensuite to main bedroom and family bathroom. The apartment also doesn't lack storage as there is fitted wardrobes in the main bedroom as well as a good sized storage cupboard in the hallway. The living space is all open plan into the kitchen. There is resident parking for the apartment and to the back of the complex is beautiful views. You can even walk along the boardwalk to Dockside shopping outlet. St. Mary's Island is a highly sought-after location, historically this area was part of the Dockyard.

Living on St. Marys Island is a whole lifestyle take a walk along the river and peer over to Upnor Castle or perhaps a walk along the board walk to see the boats. The island itself offers a primary school and doctors surgery. Just across the bridge you will find an array of local amenities.

-Service Charge - £3064.88 Per Annum

-Ground Rent - £150 Per Annum



### **Lounge**

10' x 22' 1" ( 3.05m x 6.73m )

### **Bedroom One**

11' Max x 16' ( 3.35m Max x 4.88m)

### **Bedroom Two**

8' x 11' 10" ( 2.44m x 3.61m )

### **Bathroom**



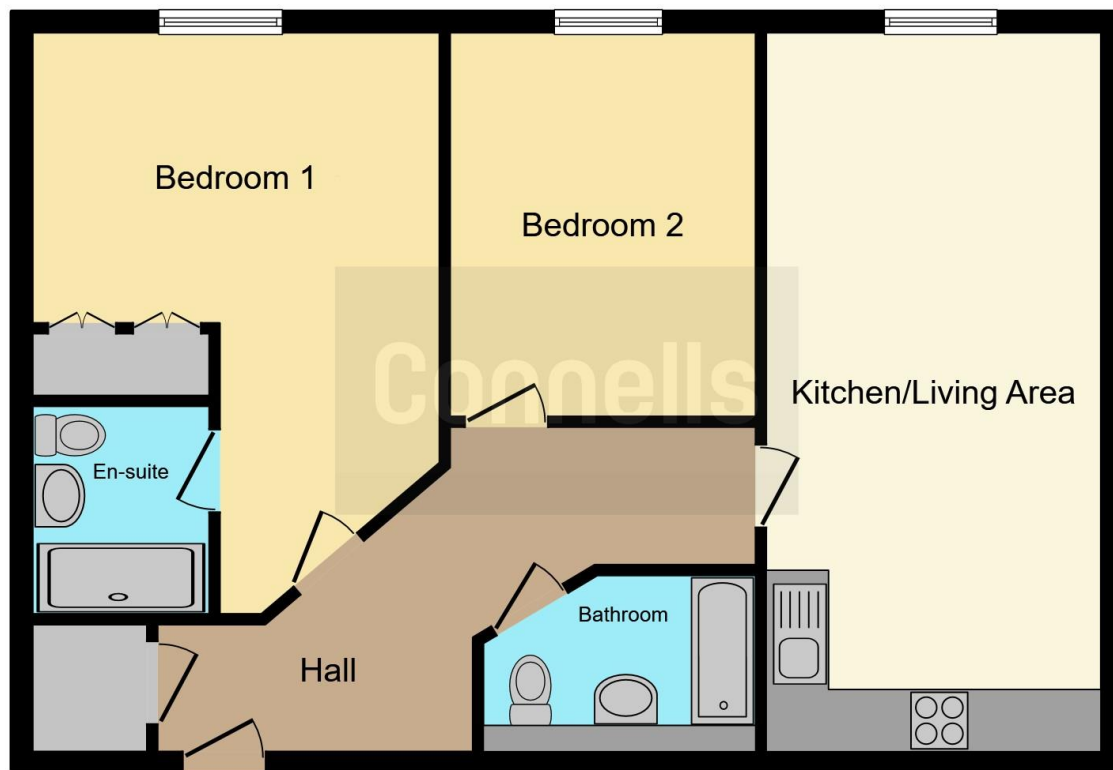

This floor plan is for illustrative purposes only. It is not drawn to scale. Any measurements, floor areas (including any total floor area), openings and orientation are approximate. No details are guaranteed, they cannot be relied upon for any purpose and they do not form part of any agreement. No liability is taken for any error, omission or misstatement. A party must rely upon its own inspection(s). Powered by [www.focalagent.com](http://www.focalagent.com)

To view this property please contact Connells on

**T 01634 233400**  
**E [rainham@connells.co.uk](mailto:rainham@connells.co.uk)**

21 High Street  
 RAINHAM ME8 7HX

EPC Rating: C

Council Tax  
 Band: D

Service Charge: Ask  
 Agent

Ground Rent:  
 Ask Agent

Tenure: Leasehold

**view this property online [connells.co.uk/Property/RAL103499](http://connells.co.uk/Property/RAL103499)**

This is a Leasehold property. We are awaiting further details about the Term of the lease. For further information please contact the branch. Please note additional fees could be incurred for items such as Leasehold packs.



1. MONEY LAUNDERING REGULATIONS Intending purchasers will be asked to produce identification documentation at a later stage and we would ask for your co-operation in order that there will be no delay in agreeing the sale. 2. These particulars do not constitute part or all of an offer or contract. 3. The measurements indicated are supplied for guidance only and as such must be considered incorrect. Potential buyers are advised to recheck measurements before committing to any expense. 4. We have not tested any apparatus, equipment, fixtures, fittings or services and it is in the buyers interest to check the working condition of any appliances.

Connells Residential is registered in England and Wales under company number 1489613, Registered Office is Cumbria House, 16-20 Hockliffe Street, Leighton Buzzard, Bedfordshire, LU7 1GN. VAT Registration Number is 500 2481 05.

**See all our properties at [www.connells.co.uk](http://www.connells.co.uk) | [www.rightmove.co.uk](http://www.rightmove.co.uk) | [www.zoopla.co.uk](http://www.zoopla.co.uk)**

Property Ref: RAL103499 - 0009

