



**Connells**

Hunstanton Close  
Rainham Gillingham



# Hunstanton Close Rainham Gillingham ME8 8RL

**For Sale**  
**£325,000**



## Property Description

Boasting exceptional living space and positioned in the popular Parkwood area, this family home is situated within close proximity to schools, shops, and local amenities. On entrance you will find a spacious hallway, fitted kitchen with a range of cupboards, good size lounge/diner and an additional family room extended to the rear which overlooks the garden. The first floor boasts two double bedrooms and a large single, all offering plenty of room for storage and a bright and airy contemporary bathroom. The low maintenance rear garden hosts a entertaining spot for your future family gatherings! This is a popular area and boasts a wealth of schools for all age groups, a mainline railway station & shopping precinct with a range of shops & eateries.

A short drive will take you to Hempstead Valley shopping centre or the M2 motorway link. The Riverside Country park is a popular area for families to enjoy with walks, play area & nature reserve.

**Entrance Porch**

**Entrance Hall**

**Lounge**

13' x 17' 2" ( 3.96m x 5.23m )

**Dining Room/Office**

9' 2" x 11' 4" ( 2.79m x 3.45m )

**Kitchen**

10' 1" x 10' 8" ( 3.07m x 3.25m )

**Landing**

**Bedroom One**

8' 4" x 13' 2" ( 2.54m x 4.01m )

**Bedroom Two**

10' 1" x 10' 2" ( 3.07m x 3.10m )

**Bedroom Three**

8' 4" x 8' 8" ( 2.54m x 2.64m )

**Bathroom**

**Rear Garden**

**Driveway**





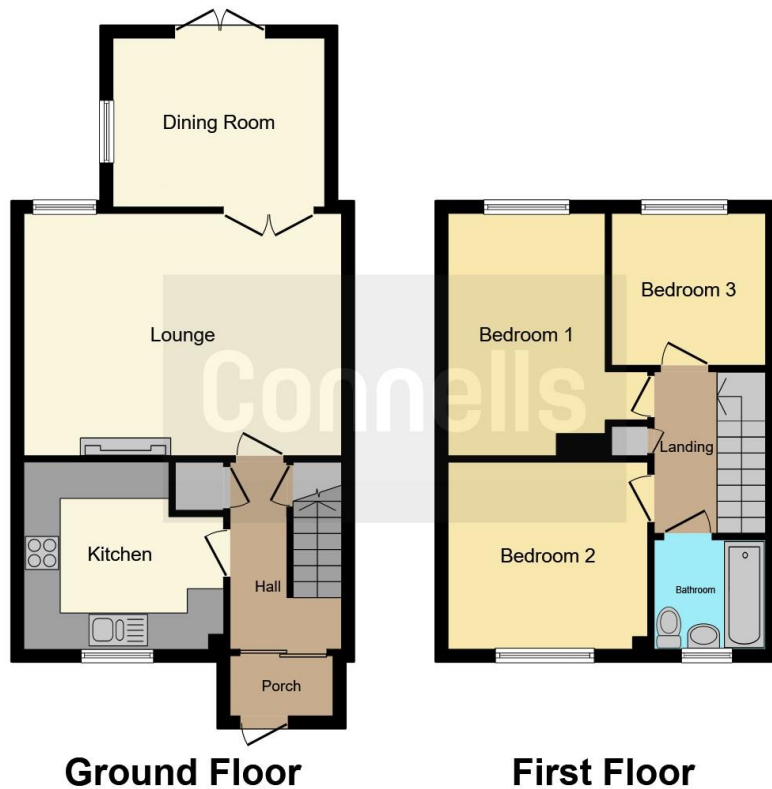

This floor plan is for illustrative purposes only. It is not drawn to scale. Any measurements, floor areas (including any total floor area), openings and orientation are approximate. No details are guaranteed, they cannot be relied upon for any purpose and they do not form part of any agreement. No liability is taken for any error, omission or misstatement. A party must rely upon its own inspection(s). Powered by [www.focalagent.com](http://www.focalagent.com)

To view this property please contact Connells on

**T 01634 233400**  
**E [rainham@connells.co.uk](mailto:rainham@connells.co.uk)**

21 High Street  
 RAINHAM ME8 7HX

**EPC Rating: D**

**view this property online [connells.co.uk/Property/RAL103495](http://connells.co.uk/Property/RAL103495)**



Tenure: Freehold



1. MONEY LAUNDERING REGULATIONS Intending purchasers will be asked to produce identification documentation at a later stage and we would ask for your co-operation in order that there will be no delay in agreeing the sale. 2. These particulars do not constitute part or all of an offer or contract. 3. The measurements indicated are supplied for guidance only and as such must be considered incorrect. Potential buyers are advised to recheck measurements before committing to any expense. 4. We have not tested any apparatus, equipment, fixtures, fittings or services and it is in the buyers interest to check the working condition of any appliances.

Connells Residential is registered in England and Wales under company number 1489613, Registered Office is Cumbria House, 16-20 Hockliffe Street, Leighton Buzzard, Bedfordshire, LU7 1GN. VAT Registration Number is 500 2481 05.

**See all our properties at [www.connells.co.uk](http://www.connells.co.uk) | [www.rightmove.co.uk](http://www.rightmove.co.uk) | [www.zoopla.co.uk](http://www.zoopla.co.uk)**

Property Ref: RAL103495 - 0004