



**Connells**

Peninsula Quay Pegasus Way  
Gillingham



### Property Description

This luxury two bedroom, two bathroom apartment which is located on the 2nd floor of the new Peninsula Quays building at Victory Pier. This highly desirable property has a balcony with views onto victory pier, across the old naval dock basins and on to the River Medway.

The development benefits from its great commuter links, both via rail, road and bus. The site currently hosts a Tesco Express, Subway, Domino's and private residents' gym overlooking Medway River. Locally, you can also visit the Dockside Centre, which offers a range of shops, restaurants and a cinema.

Also another added benefit with this property is residents Wi-Fi lounge and the communal garden area on the 1st floor!

## Lounge

15' 11" x 11' 9" ( 4.85m x 3.58m )

## Kitchen

10' 6" x 5' 3" ( 3.20m x 1.60m )

## Bedroom One

21' x 14' 3" ( 6.40m x 4.34m )

## Ensuite

## Bedroom Two

12' 5" x 10' 8" ( 3.78m x 3.25m )

## Bathroom







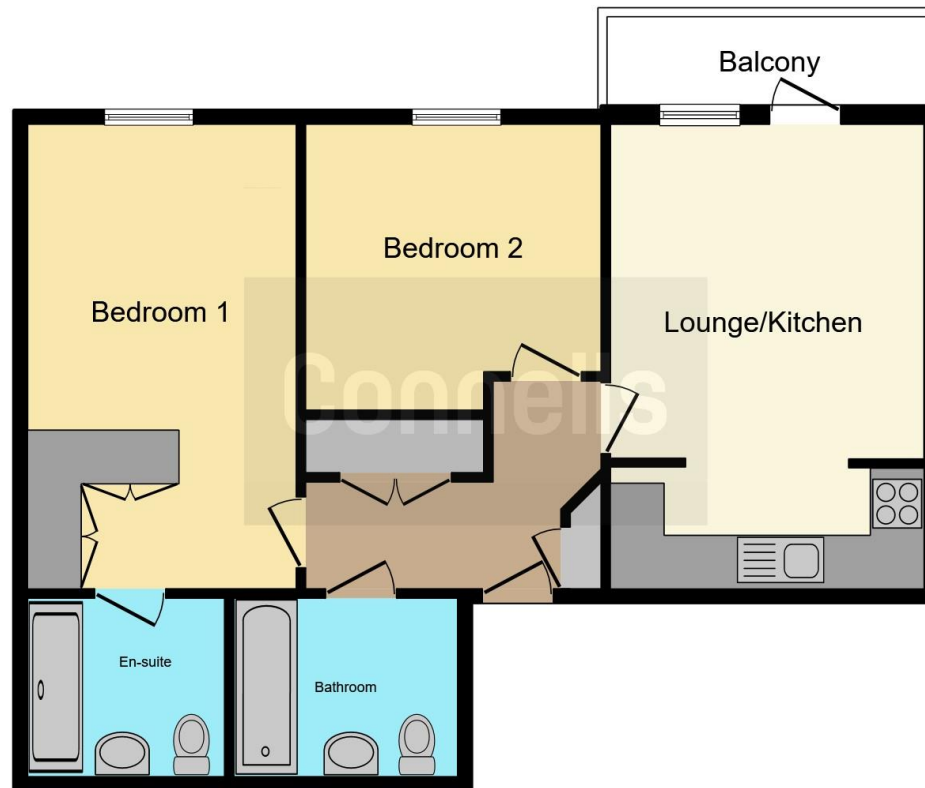

This floorplan is for illustrative purposes only and is not drawn to scale. Measurements, floor-areas, openings and orientations are approximate. They should not be relied upon for any purpose and do not form any part of an agreement. No liability is taken for any error or mis-statement. All parties must rely on their own inspections.

To view this property please contact Connells on

**T 01634 233400**  
**E [rainham@connells.co.uk](mailto:rainham@connells.co.uk)**

21 High Street RAINHAM  
GILLINGHAM ME8 7HX

**EPC Rating: B**

Tenure: Leasehold

**view this property online [connells.co.uk/Property/RAL102381](http://connells.co.uk/Property/RAL102381)**

This is a Leasehold property with details as follows; Term of Lease 999 years from 01 Jan 2008. Should you require further information please contact the branch. Please Note additional fees could be incurred for items such as



1. MONEY LAUNDERING REGULATIONS Intending purchasers will be asked to produce identification documentation at a later stage and we would ask for your co-operation in order that there will be no delay in agreeing the sale. 2. These particulars do not constitute part or all of an offer or contract. 3. The measurements indicated are supplied for guidance only and as such must be considered incorrect. Potential buyers are advised to recheck measurements before committing to any expense. 4. We have not tested any apparatus, equipment, fixtures, fittings or services and it is in the buyers interest to check the working condition of any appliances.

Connells Residential is registered in England and Wales under company number 1489613, Registered Office is Cumbria House, 16-20 Hockliffe Street, Leighton Buzzard, Bedfordshire, LU7 1GN. VAT Registration Number is 500 2481 05.

**See all our properties at [www.connells.co.uk](http://www.connells.co.uk) | [www.rightmove.co.uk](http://www.rightmove.co.uk) | [www.zoopla.co.uk](http://www.zoopla.co.uk)**

Property Ref: RAL102381 - 0009