

for sale

£220,000



## The Retreat Mill Hall Aylesford ME20 7JN

Well presented modern apartment located in an exclusive Aylesford development which boasts private allocated parking which is gated. Local amenities such as handy shops, mainline transport links and popular pubs & restaurants are just a stones throw away making this the ideal location to be.





# The Retreat Mill Hall Aylesford ME20 7JN

## Entrance Hallway

## Open Plan Kitchen/Living Room

27' 2" x 15' 3" ( 8.28m x 4.65m )

## Bedroom One

9' 9" x 15' 3" ( 2.97m x 4.65m )

## Bathroom







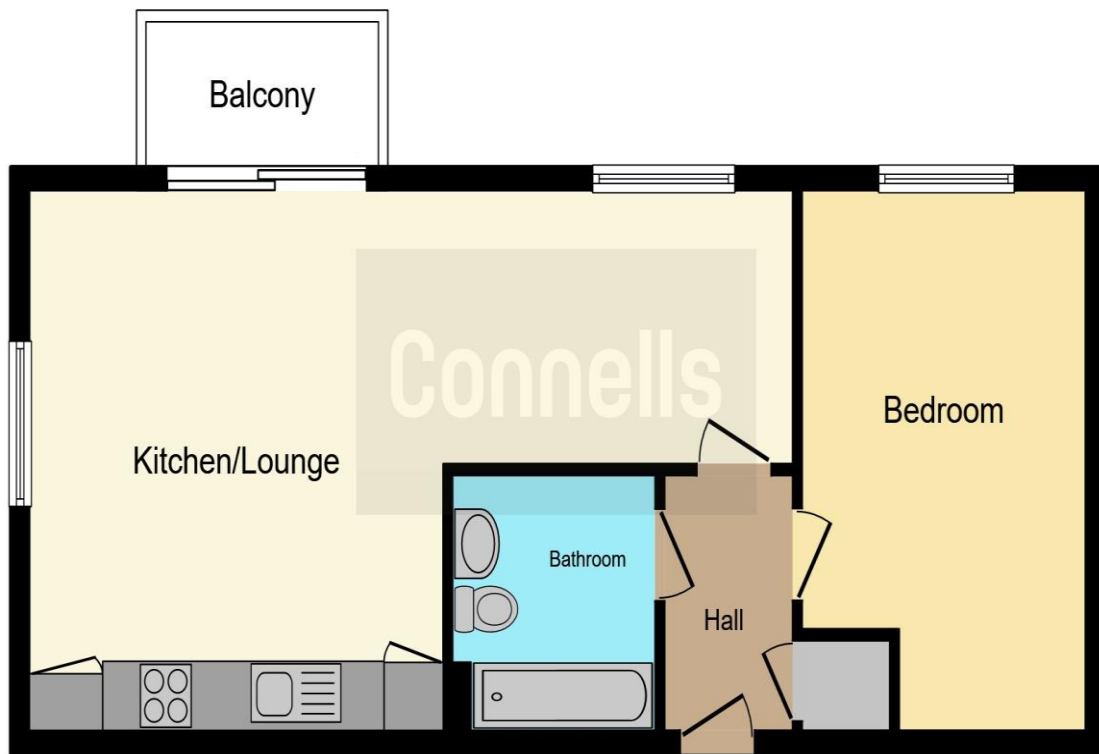

This floor plan is for illustrative purposes only. It is not drawn to scale. Any measurements, floor areas (including any total floor area), openings and orientation are approximate. No details are guaranteed, they cannot be relied upon for any purpose and they do not form part of any agreement. No liability is taken for any error, omission or misstatement. A party must rely upon its own inspection(s). Powered by [www.focalagent.com](http://www.focalagent.com)

To view this property please contact Connells on

**T 01732 874990**  
**E [westmallings@connells.co.uk](mailto:westmallings@connells.co.uk)**

11 Swan Street  
 WEST MALLING ME19 6JU

Property Ref: WML102143 - 0005

**Tenure:** Leasehold

**EPC Rating:** C

**view this property online [connells.co.uk/Property/WML102143](http://connells.co.uk/Property/WML102143)**

This is a Leasehold property. We are awaiting further details about the Term of the lease. For further information please contact the branch. Please note additional fees could be incurred for items such as Leasehold packs.

1. MONEY LAUNDERING REGULATIONS Intending purchasers will be asked to produce identification documentation at a later stage and we would ask for your co-operation in order that there will be no delay in agreeing the sale. 2. These particulars do not constitute part or all of an offer or contract. 3. The measurements indicated are supplied for guidance only and as such must be considered incorrect. Potential buyers are advised to recheck measurements before committing to any expense. 4. We have not tested any apparatus, equipment, fixtures, fittings or services and it is in the buyers interest to check the working condition of any appliances.

Connells Residential is registered in England and Wales under company number 1489613, Registered Office is Cumbria House, 16-20 Hockliffe Street, Leighton Buzzard, Bedfordshire, LU7 1GN. VAT Registration Number is 500 2481 05.

