



Algernon Road, SE13

£600,000

A mid terrace Victorian home with potential to renovate, well positioned for Ladywell Village. There are two double bedrooms, a large through lounge and generous rear garden.

Algernon Road is a lovely residential road located just around the corner from Hilly Fields and between St. John's, Lewisham and Ladywell train stations giving excellent transport links into London.

Features

- Two Bedrooms
- Freehold
- Chain Free
- Victorian
- Large Garden
- Potential To Extend STPP

Algernon Road, London, SE13

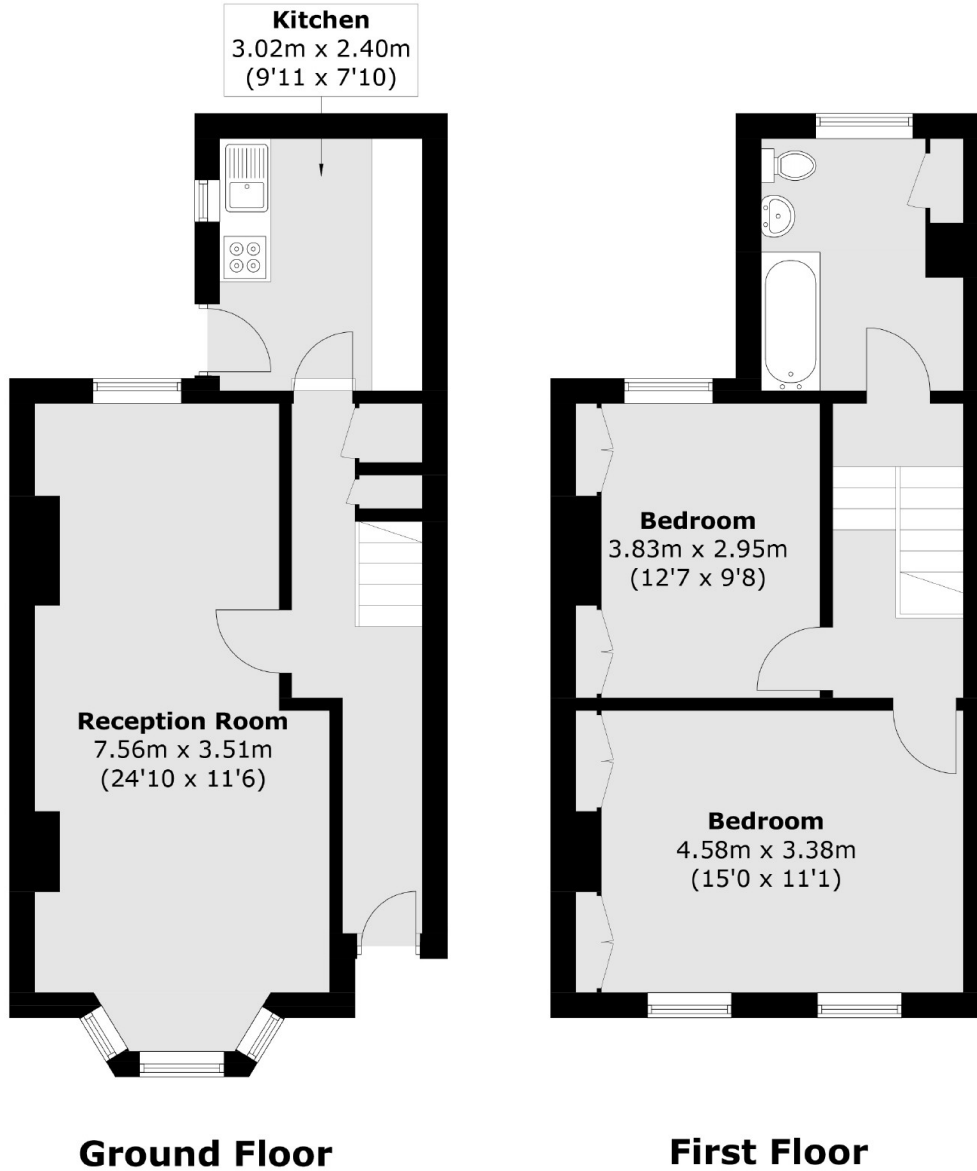

Total area (approx.): 80.2 sq. m (863.2 sq. ft)