



Fordyce Road, SE13

£750,000

A substantial semi-detached Victorian house with a generous east facing rear garden. There are three double bedrooms, two bathrooms and the potential to create a beautiful family home with no onward chain.

Fordyce Road is a quiet residential road well positioned for Hither Green, Ladywell and Catford stations with frequent services into London and the City.

Features

- Three Bedrooms
- Large Reception Rooms
- Large Rear Garden
- Large Cellar
- Close To Stations
- Chain Free

Fordyce Road, London, SE13

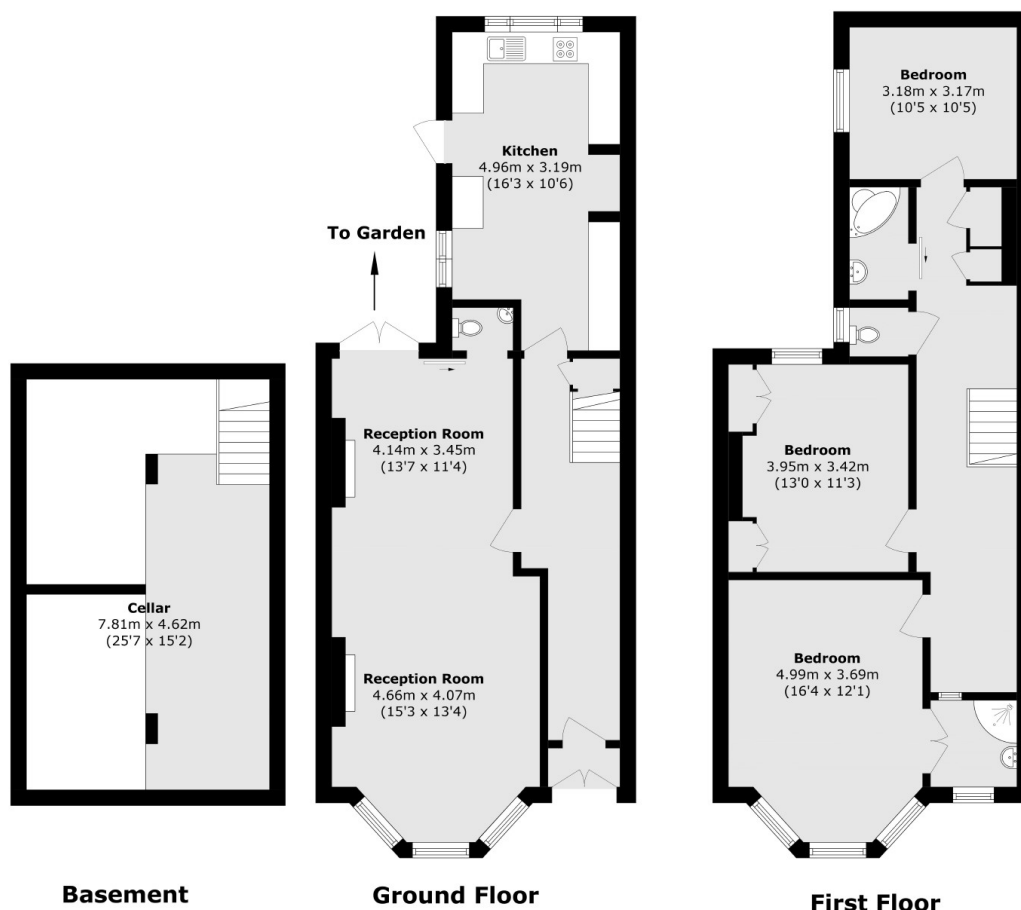

Total area (approx.): 168.7 sq. m (1815.8 sq. ft)

Dexters

Brockley
369 Brockley Road
London
SE4 2AG
Sales
020 8815 2220

Energy Rating: TBC. We aim to make our particulars both accurate and reliable. However they are not guaranteed; nor do they form part of an offer or contract. If you require clarification on any points then please contact us, especially if you're traveling some distance to view. Please note that appliances and heating systems have not been tested and therefore no warranties can be given as to their good working order.



dexters.co.uk