



Darfield Road, SE4

£550,000

This delightful two-bedroom ground floor garden flat with a freehold share, offers the perfect blend of period charm and contemporary comfort, favourably positioned for Hilly Fields and Blythe Hill Fields with excellent transport links nearby.

Darfield Road is a pretty tree lined street located just off Brockley Road. It is conveniently located for Brockley and Crofton Park stations and also the great independent cafes and shops of Brockley Road and Crofton Park are moments away.

Features

- Garden Flat
- Two Bedrooms
- Period Conversion
- Excellent Condition
- Share Of Freehold
- Close To Transport

Darfield Road,
London, SE4

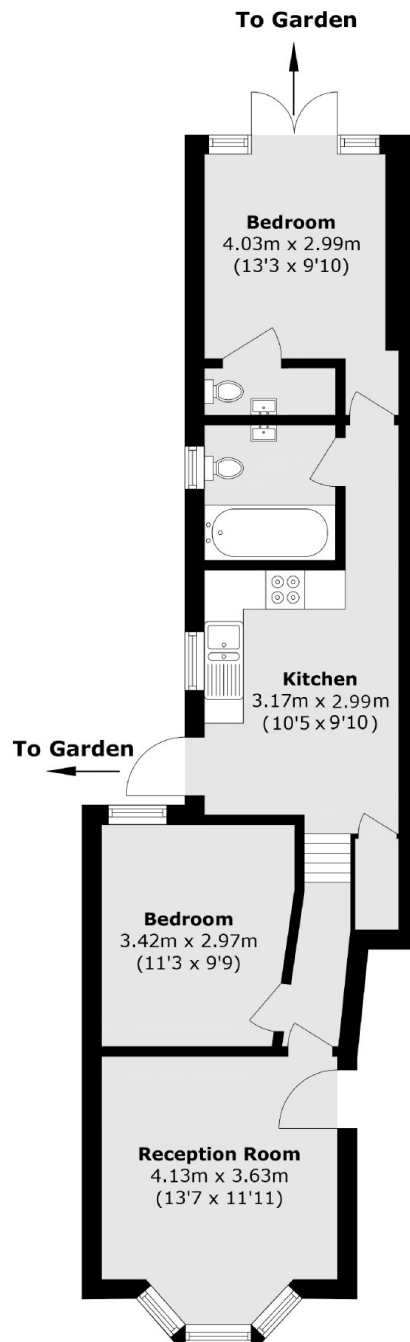

Total area (approx.): 59.1 sq. m (636.1 sq. ft)

Dexters

Brockley
369 Brockley Road
London
SE4 2AG
Sales
020 8815 2220

Energy Rating: D. We aim to make our particulars both accurate and reliable. However they are not guaranteed; nor do they form part of an offer or contract. If you require clarification on any points then please contact us, especially if you're traveling some distance to view. Please note that appliances and heating systems have not been tested and therefore no warranties can be given as to their good working order.

 **RICS** | Regulated
Estate Agent
and Letting Agent

[dexters.co.uk](https://www.dexters.co.uk)