



Flimwell Close, BR1

£400,000

A well presented three bedroom terraced house with private garden offering great potential to create a beautiful family home. Set in a pleasant cul-de-sac well positioned for local amenities and Bromley Town Centre

Flimwell Close is a pleasant cul de sac moments from Bromley Hill. The amenities of Bromley High Street and The Glades shopping centre are within easy reach. Bromley South and Beckenham Hill stations provide frequent services into London.

Features

- Freehold
- Three Bedroom
- Quiet Cul de Sac
- Large Reception Room
- Separate Kitchen
- Private Garden

Flimwell Close, Bromley, BR1

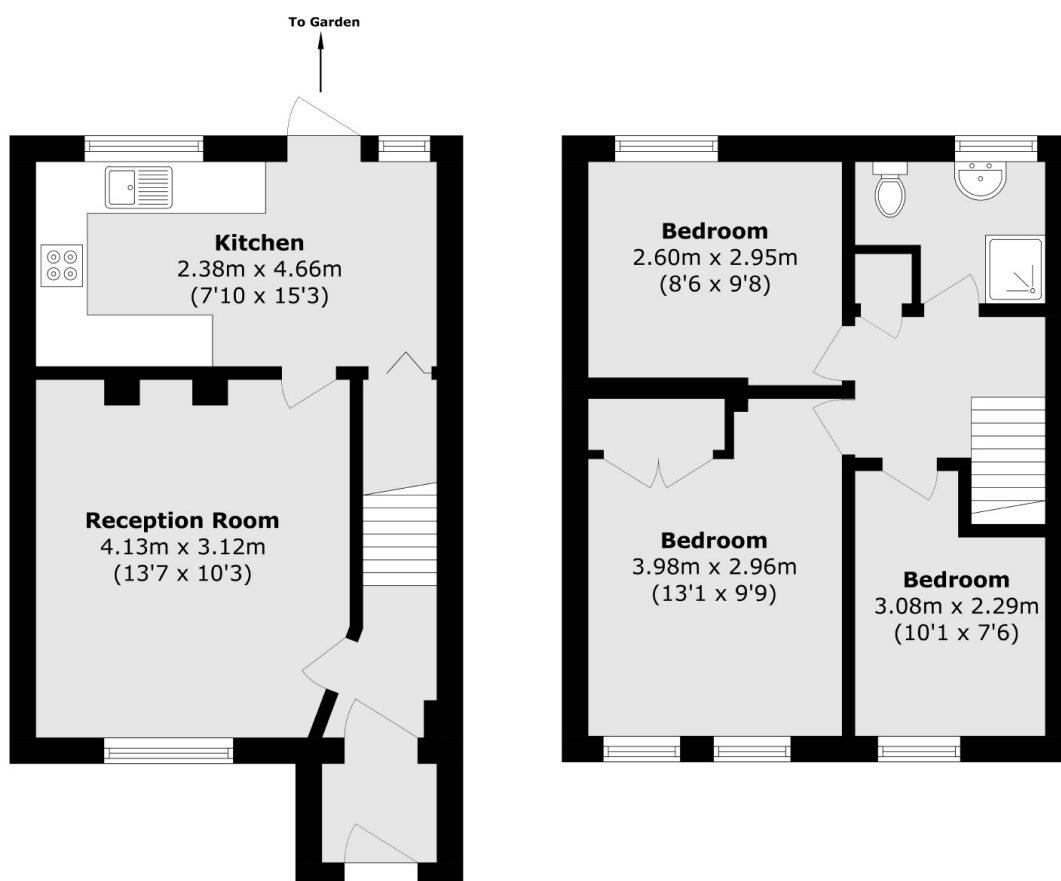

Total area (approx.): 68.5 sq. m (737.3 sq. ft)