



## Overcliff Road, SE13

£600,000

An impressive split-level period conversion with versatility over two floors. Comprising a characterful reception room with a contemporary kitchen, two double bedrooms and a private rear garden.

Overcliff Road is a residential road located close to Ladywell Village and Ladywell Station and nearby fantastic local amenities. Hilly Fields and Ladywell Fields are also in close proximity.

### Features

- Period Conversion
- Two Double Bedrooms
- Share Of Freehold
- Well Presented
- Private Rear Garden
- Great Transport Links

# Overcliff Road, London, SE13

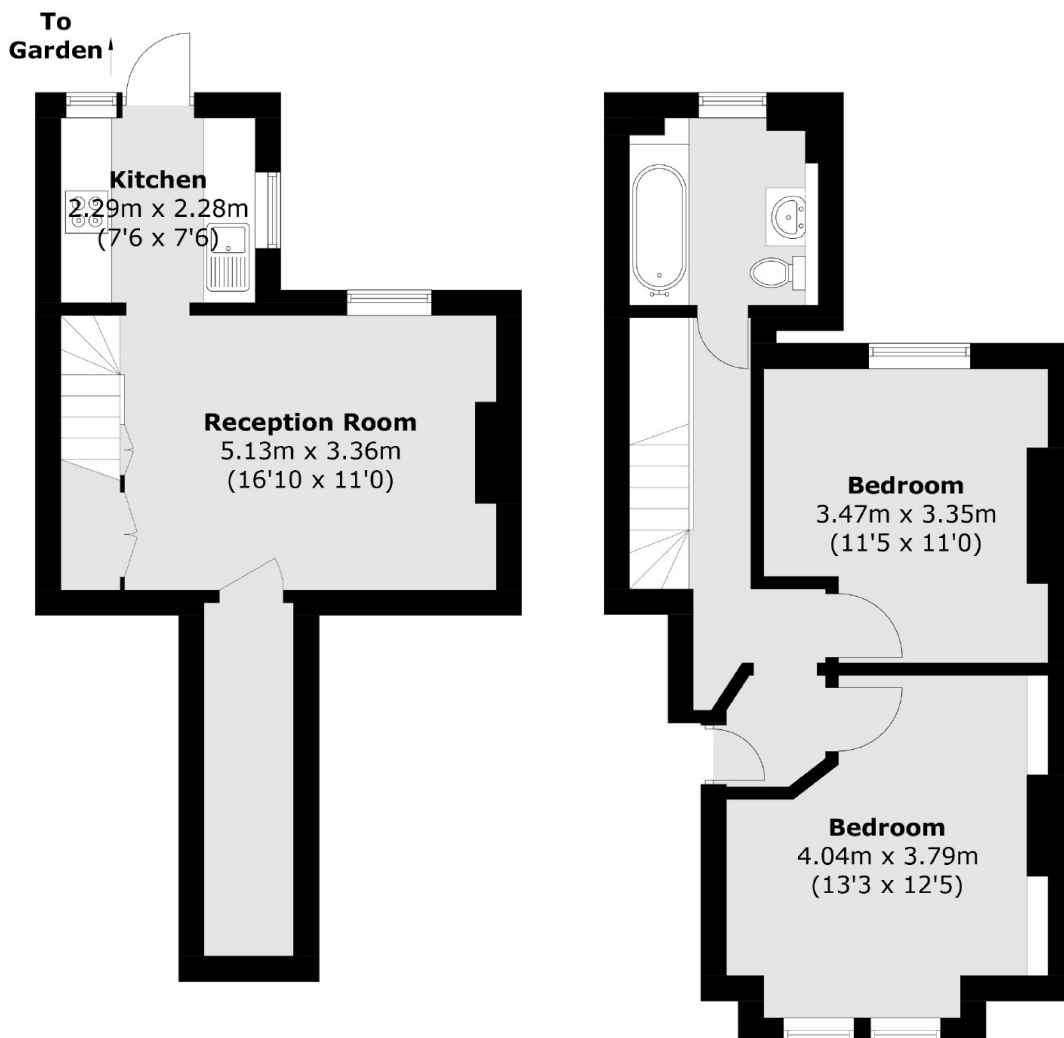

**Lower Ground Floor**

**Ground Floor**

Total area (approx.): 64.5 sq. m (694.2 sq. ft)