



Killearn Road, SE6 £635,000

A pretty brick-fronted Victorian house in the heart of the Corbett Estate. There is a characterful bay-fronted reception room, three bedrooms, a well presented kitchen diner with a mature rear garden and fully powered garden room/workshop.

Killearn Road is a sought after residential road in the Corbett Estate moments from Mountsfield Park. Well positioned for both Hither Green and Catford stations, which provides a range of commuter services into Central London.

Features

Victorian
Well Presented
Characterful Reception
Three Bedrooms
Corbett Estate
Chain Free

Killearn Road,
London, SE6

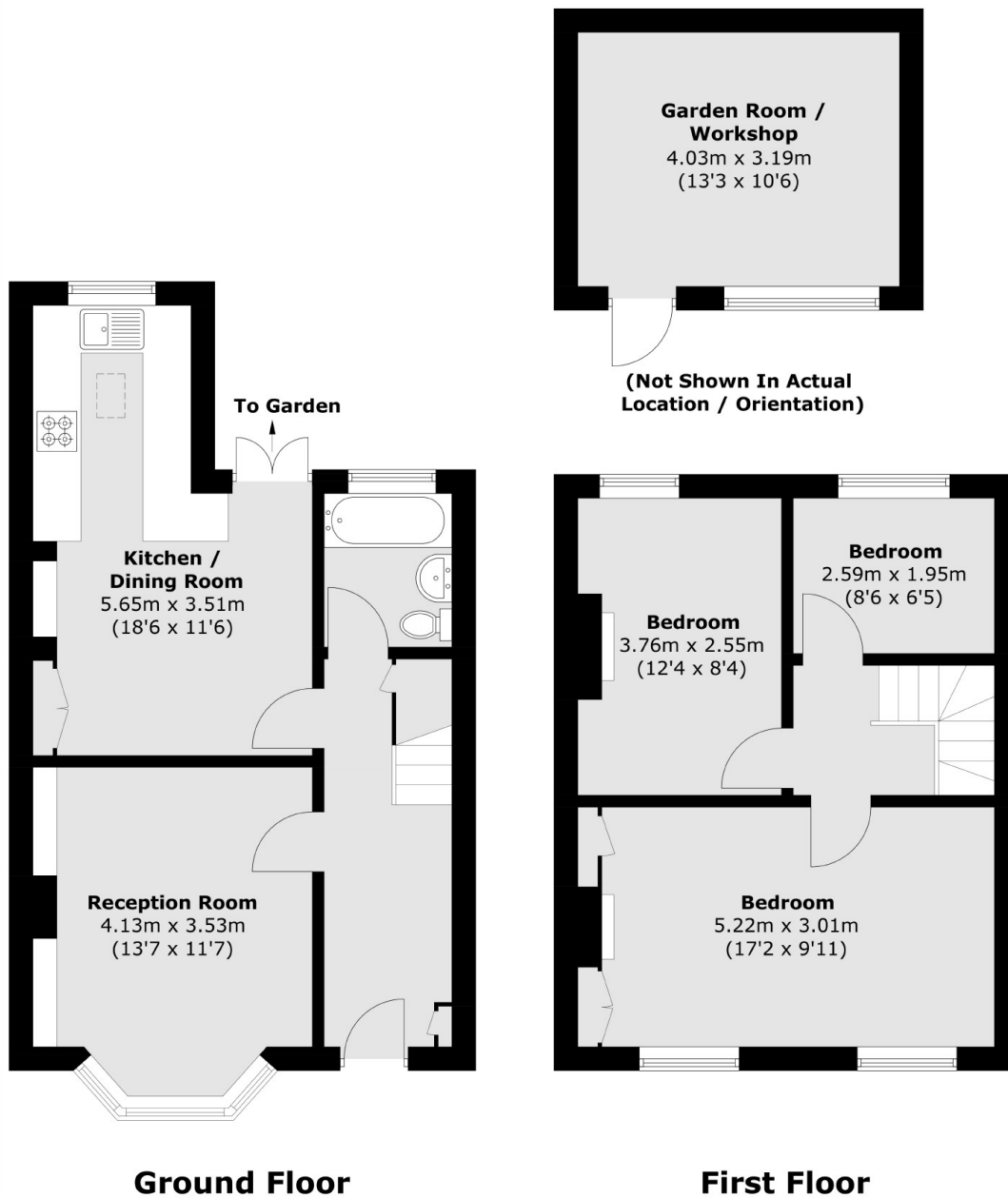

Total area (approx.): 78.5 sq. m (845.0 sq. ft)
Outbuilding area (approx.): 13.0 sq. m (139.9 sq. ft)