



## Mount Pleasant Road, SE13

£850,000

A well presented end of terrace Victorian house offering over 2,038 Sq. Ft moments from Mountsfield Park. There are three double bedrooms, a large bay fronted reception room, a separate dining room and a delightful kitchen/diner with french doors onto a decked and lawned south facing rear garden.

Mount Pleasant Road is a quiet residential road equidistant from Hither Green, Ladywell and Catford stations with frequent service into London and the City.

### Features

- End Of Terrace
- Three Bedrooms
- Large Kitchen/Diner
- Landscaped Garden
- Close To Stations
- Chain Free



## Mount Pleasant Road, SE13

As you enter the house, you are greeted by a bay fronted reception to the right of the broad hallway, bringing in an abundance of natural light. On this floor you will also find a large dining space with high ceilings and a modern kitchen with ample base and wall units with dining space to rear overlooking the large south facing garden. A separate WC and handy cellar completes the ground floor.

Up to the first floor and the bay fronted principal bedroom can be found to the front of the house with an en-suite shower room, there are two further double bedrooms served by a contemporary four piece bathroom suite perfect for a family.

The garden is delightful with a southernly aspect with both decked and lawned areas, a perfect space to entertain.



# Mount Pleasant Road, London, SE13

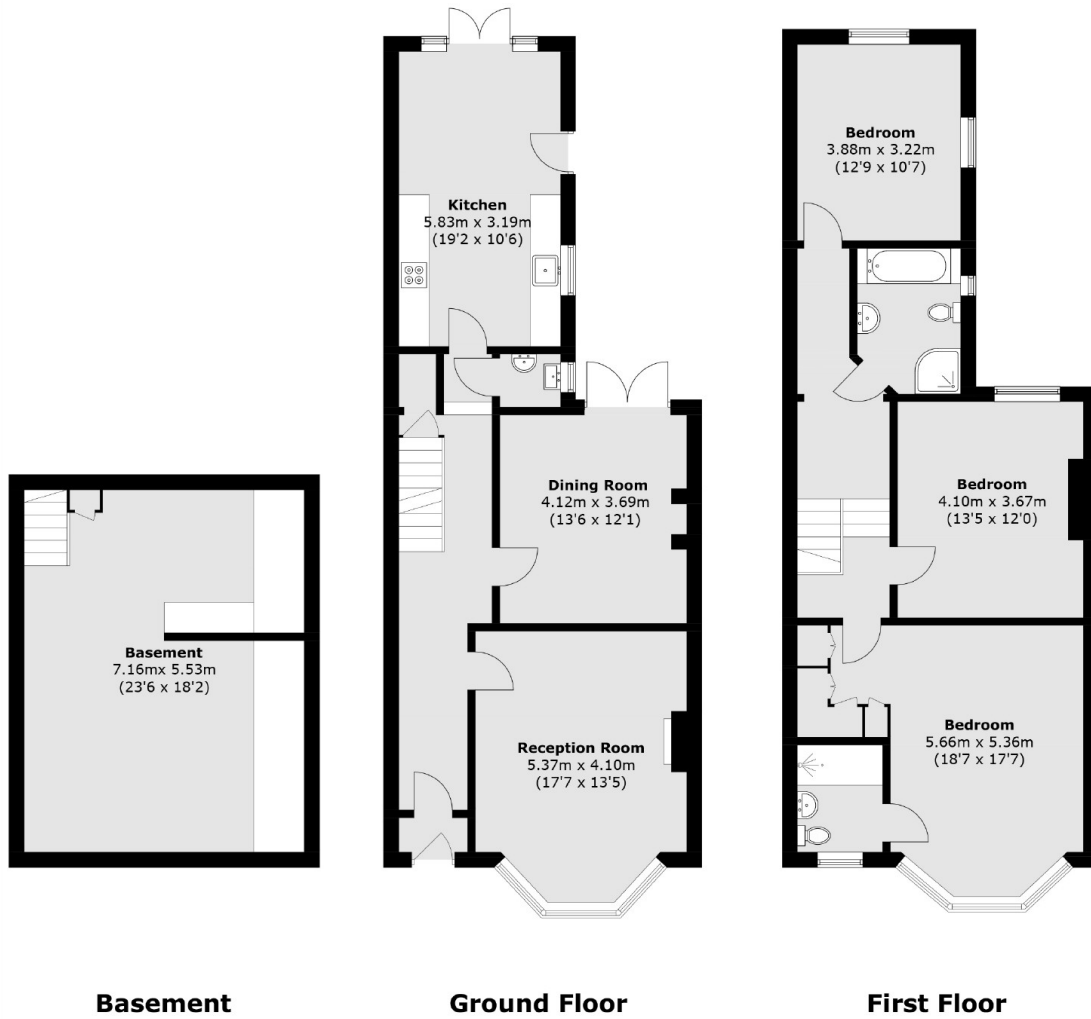

Total area (approx.): 189.4 sq. m (2,038.6 sq. ft)