



Marsala Road, SE13

£375,000

A lovingly refurbished ground floor conversion flat well positioned moments from Ladywell Village. There is a large double bedroom, a bright reception room, generous kitchen diner and direct access to private rear garden offered with a freehold share.

Marsala Road is a quiet residential road well positioned for the amenities of Lewisham and Ladywell Village with Hilly Fields and Ladywell Fields green spaces close by. Lewisham and Ladywell stations offer frequent services into London and the city.

Features

- Period Property
- Double Bedroom
- Bright Reception Room
- Kitchen/Diner
- Private Garden
- Share Of Freehold

Marsala Road, London, SE13

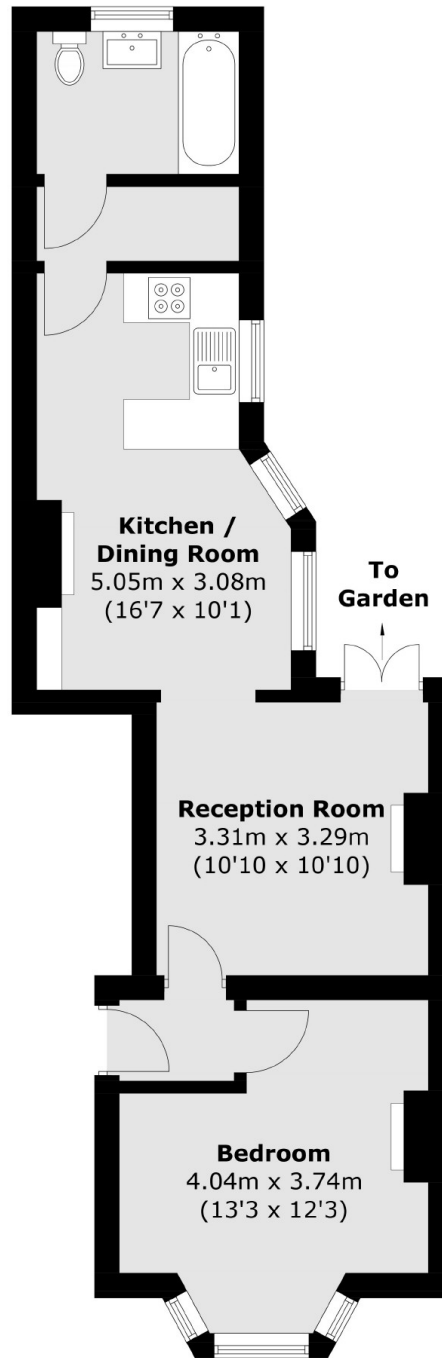

Total area (approx.): 47.1 sq. m (507.0 sq. ft)