



Brockley Grove, SE4
£1,100,000

Dexters



Brockley Grove, SE4

An exceptional and fully refurbished five bedroom Victorian home spread across three floors and an impressive 1,732 Sq Ft. A perfect blend of period charm and high quality contemporary living.

The front door opens into a characterful hallway with original wood flooring and W.C. To the right is a through lounge with period features including a bay window, feature fireplace and original flooring. To the rear of the property is a superb brand new kitchen with crittall doors to the garden. The high quality bespoke kitchen has a selection of wall and base units, integrated appliances and larder unit.

Upstairs there are three large double bedrooms and a delightful four piece family bathroom. The loft has recently been converted to offer two further bedrooms, one with en-suite shower room.

To the rear of the house is a generous east facing garden, laid to lawn with plant borders.

Brockley Grove is perfectly positioned for Crofton Park and Ladywell stations and expanse of Hilly Fields.

Features

- Victorian
- Recently Remodelled
- Five Bedrooms
- Two Bathrooms
- Brand New Kitchen
- Chain Free







Brockley Grove, London, SE4

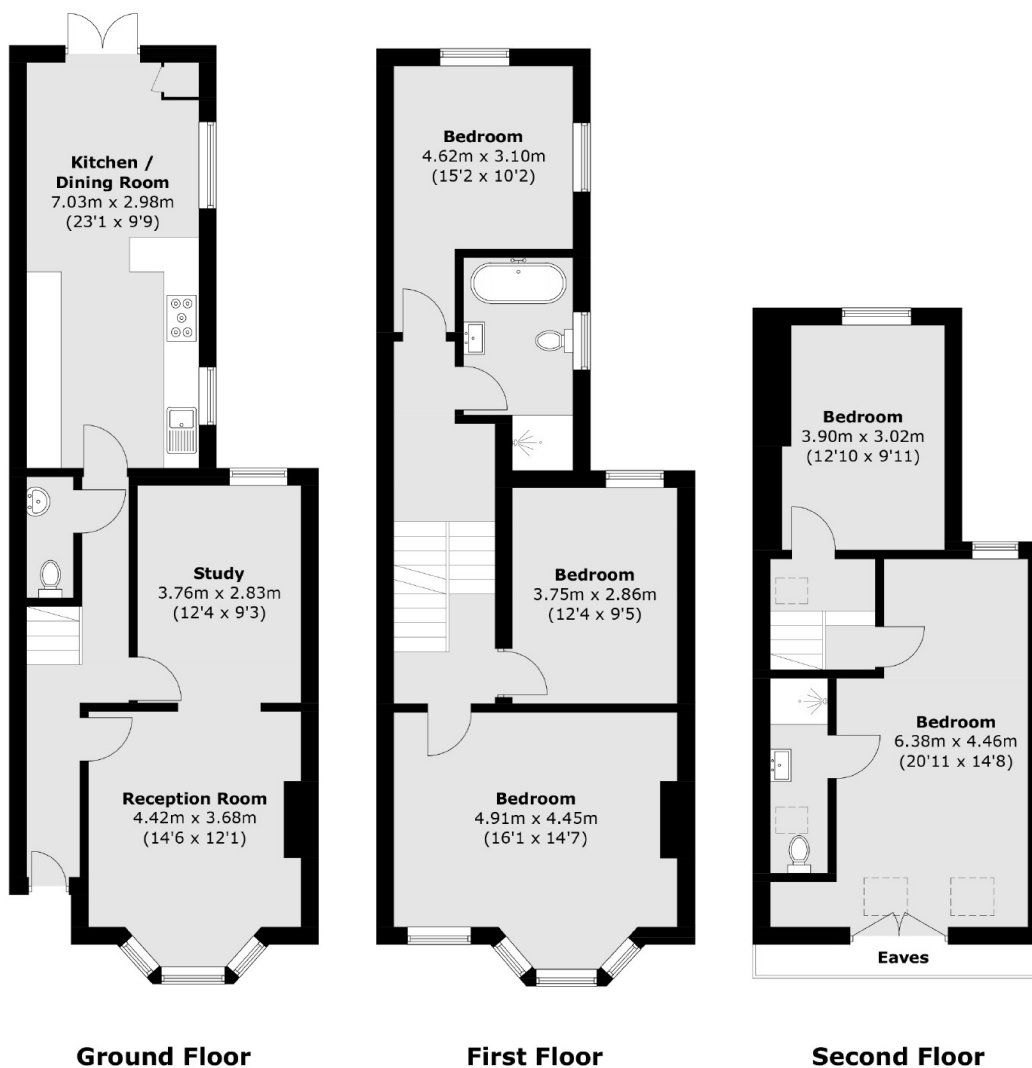

Total area (approx.): 161.0 sq. m (1,732.9 sq. ft)
(Excluding Eaves)