



## Mercy Terrace, SE13

£475,000

A first floor two bedroom apartment, with balcony, new build guarantee right in the heart of Ladywell. There is a share of the freehold, new build guarantee and no onward chain, this property is ready for immediate occupation.

Ladywell Fields, originally Ladywell Recreation Ground is a public park in the London Borough of Lewisham created from three historic fields. It is located near Ladywell railway station at the northern end of the park, and Catford Bridge at the southern end. Also Ladywell Field's green open spaces are very nearby, the park is a key cycling and walking route. It is popular with joggers and dog walkers.

Known for its strong community spirit and green spaces, Ladywell offers a charming mix of urban and suburban living. The area boasts the picturesque Ladywell Fields, a series of public parks along the River Ravensbourne, which provide a serene environment for outdoor

### Features

- Two Bedrooms
- One Bathroom
- Large Balcony
- Ladywell Village
- Share Of The Freehold
- Close To Ladywell Park

# Mercy Terrace, London, SE13

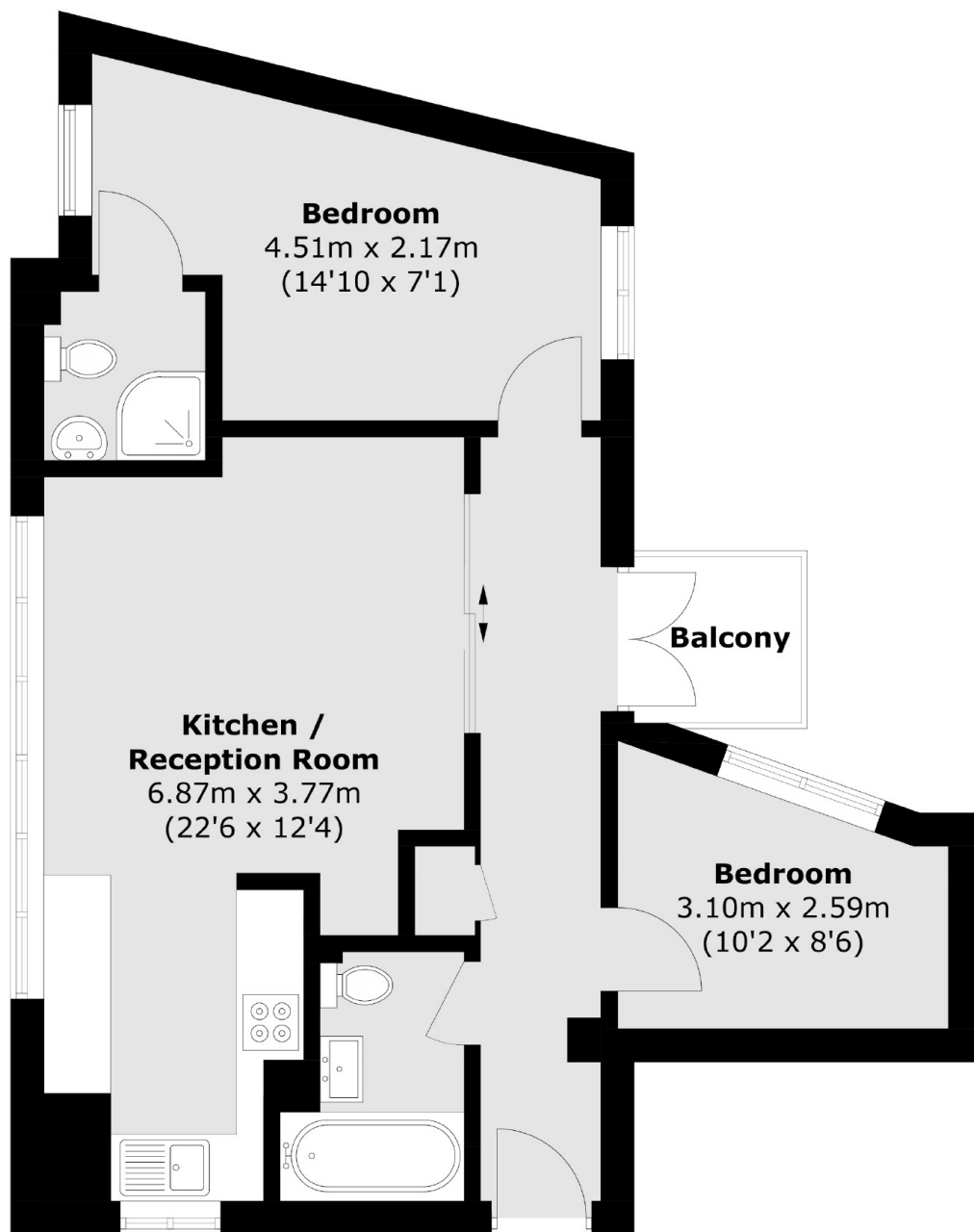

## First Floor

Total area (approx.): 54.9 sq. m (590.9 sq. ft)